



Maryanne Corder Neighborhood Grant Application FY 2022/2023

Created in 1994, this grant funds neighborhood-initiated projects designed to benefit all community members. It is named in recognition of the founder and first director of the city's Neighborhood Services Program. **Applications must be submitted by 5 p.m. on April 25, 2022.**

Tempe south mountain n.a.

Name of association

500

of households

Baseline Rd & 48th Street

Project location or major cross streets

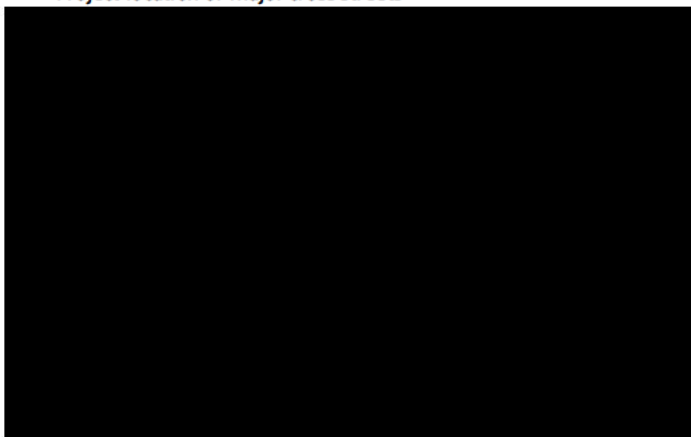

Primary contact address

same

Authorizing individual, if different (can accept funds, sign contract)

Authorizing individual email

Authorizing individual phone number

Authorizing individual address

1. Project description: Describe your project in three sentences.

We are adding 3 benches in 3 different places on the outer perimeter of Svob Park . We are also making changes to the field lighting on the east side of the park for safety reasons & to save money.

2. Project Budget

Expenses	Amount
Utility construction co. to change lighting see the attached proposal	\$8,349.59
	\$
Dave Bang Assoc. Inc for 3 benches includes set up & labor	\$4,170.60
ELS Construction-concrete pads for benches	\$3,305.32
	\$
Match (HOA and Crime Free Multi-family Housing properties only) 25% of project total:	\$
Grant funds requested:	\$
TOTAL PROJECT COST:	\$15,825.51

Maryanne Corder Neighborhood Grant Application—pg. 2

3. Staff contacts Please select all staff that you have met with and/or contacted:

- Neighborhood Services staff (circle at least one):
Brenda Clark, Laura Kajfez, Elizabeth Thomas, Shauna Warner
- ADA Accessibility: Nanette Odell
- Art: Rebecca Rothman
- Landscape/Lighting/Walls: Steve Abrahamson
- Parks/Playground: Dave McClure

- Signs: Mike Scarpitta
- Trees: Richard Adkins
- Traffic Calming: Cathy Hollow
- Water Conservation: Tina Sleeper

Other: also parks person Erin Kirkpatrick

4. Narrative—applications are evaluated based on how well the project meets the provided criteria.

Ability: If approved for funding, briefly describe your ability to complete the project in a year and how it will be maintained in the future.

Both of our proposals are thanks to city employees Dave McClure, Ruben Wilkinson & Erin Kirkpatrick.

As far as completion of the project we feel that this will be done in a timely matter.

The maintenance is part of the on going maintenance of the park. We will make sure that any issues will be reported to the proper people.

Community Impact, Outreach and Outcomes: How does your project plan demonstrate meaningful and varied efforts to increase neighbor participation and include diverse participants? Share how your outreach and strategies will be as intentional and inclusive as possible. Describe how your project will impact the neighborhood/community and the desired outcome. (i.e. better health due to more physical activity or public art promoting community identification and pride).

These 2 items have been ongoing requests from our neighbors for years.

Benches: see that attached picture. They will also match color wise as the current benches in the park. We would like to have them facing toward the park & not out. We have many people young & old that are walkers that have asked for these. Some people are not able to go up or down on the slopes to reach seating so this will help. The benches will also be ADA compliant. We do have people with disabilities in our area so this will really help them.

Lighting: Please see the attached bid sheet from the Utility construction co. on page 1 as to what they will be doing. The lighting will help part of the area on the east end that was dark. This is also a safety issue for not only our neighbors but also for the police. The bid explains all of this....





155

6

S Wendler Dr

S Wendler Dr

S W

W Hermosa Dr

W Riviera Cir

W Garden Dr

W Desiree Ln

S Filer Dr

W Vineyard Rd

S Apartment

S Calle Los C

W Dunbar Dr

W Ellis Dr

Minton Dr

S Fair Ln

S 48th St

S 48th St

on St

*Location of benches - ?
hoping to have them face toward the park*

Handwritten annotations in black ink:
Wineyard Rd
Riviera Cir
Greenway Rd
Mint
places have
count
bench placement



Estimate

AZ124465

To: City of Tempe
 Attn: David McClure
 55 South Priest Drive Building L
 Tempe, AZ 85281

Estimate Date 03/02/2022	Salesperson Andrew Ross
------------------------------------	-----------------------------------

SVOB Park Benches

Estimated Shipping Date	Shipped Via	FOB	Terms
16-22 Weeks	Truck - AZ	Tempe	Net 30
Quantity	Description	Unit Price	Total Extended
3	Wabash # CN420D, 6' Bench with back, Contemporary Series, Diamond Pattern, portable / surface mount with MC104N, Mounting Plate Covers (Set of 4) COLOR: TBD	\$753.00	\$2,259.00
3	Wabash # CN440N, Center Armrest, Contemporary Series COLOR: TBD	\$54.00	\$162.00
	Subtotal		\$2,421.00
1	Wabash Shipping	\$1,100.00	\$1,100.00
1	Installation by a Factory Certified Licensed Contractor to include: Surface Mount installation of 3 EA Benches with mounting plates and center armrests	\$441.00	\$441.00
<i>THIS ESTIMATE IS SUBJECT TO THE ATTACHED TERMS AND CONDITIONS</i>		Subtotal	\$3,962.00
THANK YOU FOR THIS CHANCE TO ESTIMATE		Tax (8.1%)	\$208.60
<small>Dave Bang Associate, INC. IS PLEASED TO SUBMIT THE ABOVE ESTIMATE FOR YOUR CONSIDERATION. SHOULD YOU PLACE AN ORDER, BE ASSURED IT WILL RECEIVE OUR PROMPT ATTENTION. THIS ESTIMATE IS SUBJECT TO THE ATTACHED TERMS AND CONDITIONS, AND IS VALID FOR 30 DAYS. THEREAFTER, IT IS SUBJECT TO CHANGE WITHOUT NOTICE.</small>		Total	\$4,170.60

Accepted By _____ Signature: _____ Date: _____
 Print Name: _____

PLEASE SIGN AND RETURN ONE COPY WHEN ORDERING.

THANK YOU!

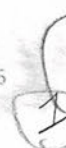

ELS Construction

3328 E. Southern Ave, Phoenix, AZ 85048

Phone: 602-243-1106 Fax: 602-268-5048

****WORK ORDER PROPOSAL****

TO: City of Tempe
Parks & Recreation
55 S. Priest Drive, Bldg L
Tempe, AZ 85281

DATE: 3/17/2022
CONTRACT/PO #
ELS JOB:
Tempe SVOB Park Bench Pads & Grading
Tempe, AZ
JC Code:

ATTN: Dave McClure, PLA CPSI
David_McClure@tempe.gov

P.C.O.: SVOB Park Bench Pads

Scope Install 3ft wide Sidewalk expansions and transitions connecting to existing sidewalk.

Qty	Description	Total	
3	5'x12'x4" Concrete Pads for Benches	\$2,340.00	\$3,140.00
1	Adjust sprinklers as needed	\$300.00	
1	Misc Grading	\$500.00	
			Tax
			\$165.32
			\$3,305.32

BUDGET AMOUNT THIS PROPOSAL
(Tax Included)

Work to be performed on a time materials bases at the rates as specified above. ELS shall not be liable for re-do of thier work or others at cost if deemed not acceptable by governing municipality. If redo of ELS work is necessary, the above rates shall apply, minus 10%.

ELS CONSTRUCTION, INC.

BY: John Lupoe TITLE: Pre-Construction Director
John Lupoe

ACCEPTED: The above prices and specifications of this Work Order Proposal are satisfactory and are hereby accepted. With Signature below the party authorizes the work to be performed and acknowledges responsibility for related bills.

BY: _____ TITLE: _____
Agreed/Accepted

4

2

March 22nd, 2022

Page 1 of 3

City of Tempe
55 South Priest Drive
Tempe, AZ 85281

Attn: Ruben Wilkinson
(480) 858-6110
Ruben_WilkinsonJr@tempe.gov

Re: Wireless Controls Proposal
Svob Park – Field Lighting Wireless Controls
2600 W. Vineyard Road
Tempe, AZ 85282

Mr. Wilkinson,

Utility Construction Company, Inc. (UCC) is pleased to present the following Proposal for the Project:

Field Lighting Wireless Controls
Svob Park

- I. **Scope of Work:** UCC proposes to furnish labor, equipment, supervision, and other items of value to complete the following:

Material

1. Add wireless nodes to each of the (12) fixtures in the sport field area
2. Add wireless gateway to SES for control of the sport field lighting
3. Add push button operation for the sports field lighting (existing location at SES)

Programming

1. Create a "scene" to allow the sports field lighting to be operated on the push button during hours of 15 minutes before dusk to 10PM. Button on SES will allow for fixtures to be turned on and off, if left on the fixtures will be turned off at 10PM
2. Create a "scene" to energize 1/3 fixtures per pole after 10PM to dawn at a percentage of illumination to be determined for area illumination

Optional Programming – Basketball Courts

1. Bypass push button
2. Create "scene" to wireless gateway for motion sensors to turn lights on at dimmed level until motion detected, ramp up to 100% illumination after motion detected. Fixtures will dim after inactive for preset amount of time. Lights will operate during hours of 15 minutes before dusk to 10PM



(Continued from previous page)

March 22nd, 2022

Page 2 of 3

Re: Wireless Controls Proposal
 Svob Park – Field Lighting Wireless Controls
 2600 W. Vineyard Road
 Tempe, AZ 85282

II. Price: The price to complete the items of work from the Scope of Work section above was prepared using the terms and conditions of the 1GPA cooperative agreement 17-13PV-07.

No.	Description	Qty.	Unit	Price	Extended
Additional Products and Services					
-	Wireless Nodes (Installed at fixture) Synapse Part Number: DIM10-220	12	EA	\$ 156.00	\$ 1,872.00
-	Wireless Nodes External Antenna (Installed at fixture) Synapse Part Number: ANT-OSS-5.1	12	EA	\$ 22.00	\$ 264.00
36	Wireless Gateway, Cellular (at Lighting Load Center) PLG Part Number: PLG-SS450-002-01	1	EA	\$ 2,250.00	\$ 2,250.00
-	Wireless Two-Button Switch with Enclosure (Installed at Load Center) Synapse Part Number: WSW-02-PS	1	EA	\$ 418.00	\$ 418.00
B. High Voltage – Group 2					
5	Installation Labor - Journeyman Electrician	17	MHR	\$ 70.00	\$ 1,190.00
C. Commissioning					
39	Commissioning (Gateway Network Set-up, programming) Part Number: GLP-SER-FS1	1	EA	\$ 750.00	\$ 750.00
40	Commissioning (Wireless Node Set-up & Programming) Part Number: SER-ONSITEDEV	13	EA	\$ 50.00	\$ 650.00
37	Synapse Remote Access and 1-Year Subscription Synapse Part Number: SSRA-1YR	1	YR	\$ 750.00	\$ 750.00
Subtotal					\$ 8,144.00
Sales Tax – 8.3% – Materials Only (MRRA)					\$ 205.59
Total					\$ 8,349.59

III. Notes and Qualifications:

1. Final invoice will be based on actual work complete.
2. Excluded:
 - a. Permits / permit fees.



2

(Continued from previous page)

March 22nd, 2022

Page 3 of 3

Re: Wireless Controls Proposal
Svob Park – Field Lighting Wireless Controls
2600 W. Vineyard Road
Tempe, AZ 85282

- b. Special inspections, including soil and concrete testing
- c. Repairs to existing electrical problems beyond the luminaire.

IV. Acceptance: The pricing, specification, and conditions of the above proposal are hereby accepted. The amount of **Eight Thousand, Three Hundred, Forty-Nine Dollars and Fifty-Eight cents (\$ 8,349.58)** will be due upon completion in accordance with 1GPA.

Thank you for your consideration, and feel free to contact me directly with any questions at (480)540-9329.

Jeff Rusk
Project Manager
Utility Construction Company, Inc.
Office: (480) 654-3100
Cell: (480) 540-9329
jeff@utilityconstructionco.com



10

Specification Data	
Job Name	
Type	
Catalog #	
Comments	

PRODUCT OVERVIEW

The SS450 site controller serves as the heart of your SimplySnap solution. This network edge appliance provides quick browser-based access and local control of smaller systems with hundreds of devices.

Each SimplySnap system includes a variety of Synapse-enabled devices that communicate with each other and the SS450 to form a local mesh network. The SS450 organizes devices into zones, creates schedules, and allows authorized users to access the system to change system behaviors or to interact directly with individual devices.

For managing larger sites or multiple locations, SimplySnap cloud applications¹ are available to consolidate multiple site controllers into a single user interface for fast and simple access across installations with thousands of devices.

KEY FEATURES:

- Multiple Zones, Behaviors, Events, and Schedules
- Built in Wi-Fi for local wireless access
- AES 128-bit encryption
- Optional Cloud and Remote Access services available¹
- BMS and other system integration options
- Sunrise and Sunset Schedules driven by latitude and longitude
- Energy saving features including Daylight Harvesting and Demand Response
- Energy management cloud applications¹ gather data from site controllers to generate energy reports about your facility and equipment

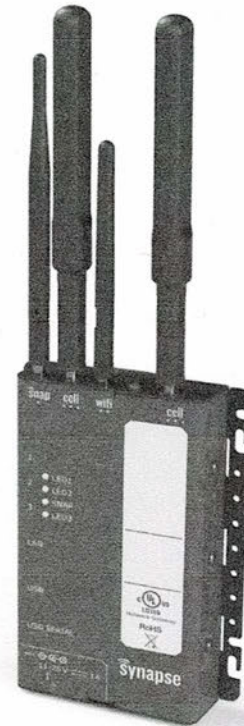

Product #	Description
SS450-002	WiFi and Verizon 4G LTE enabled, wall mount bracket; 4 Antennas

Dimensions	6.8" L x 4.6" W x 1.4" H (173mm L x 117mm W x 36mm H) without antennas
Operating Environment ²	-40°C to +70°C Indoor Use Only
Mounting	DIN rail or Wall Mounted
Input Power ²	12-24VDC (via Barrel Connector or Terminal Block Connector) Includes 100-240VAC, 15W AC adapter
Cellular	Verizon 4G LTE
Wi-Fi	802.11 b/g/n
Radio	SNAP 2.4 GHz; 802.15.4 +20 dBm Transmit Power -105 dBm Receive Sensitivity
Certifications	DLC, FCC, IC, cULus
Warranty ³	5 Years

1. Cloud access and other applications sold separately, contact sales for details.
2. Included AC/DC supply is rated for indoor use only (0- 40°C). For outdoor use we recommend the Synapse Central Base Station - model CBSSW-450-002.
3. See www.synapsewireless.com/warranty for warranty terms

To learn more, call or visit:
synapsewireless.com
 (877) 982-7888

SIMPLYSNAP SITE CONTROLLER

4

INCLUDED WITH THE SS450:

- 4 Antennas - 2 cellular antennas, 1 SNAP antenna, 1 WiFi antenna
- Wall mount bracket
- 1 Power Supply
- Terminal Block Connector (for alternate power connection)
- Quick Install Guide

OUTDOOR SITE CONTROLLER OPTION:

Part #	Description
CBSSW-450-002	Central Base Station SS450-based Model with 5-button switch and NEMA 4X enclosure

SUPPORTED WIRELESS DEVICES:

- Embedded Lighting Controllers
- External Lighting Controllers
- Sensors - Photocell, Motion, Industrial, and Environmental
- Network Repeaters
- Hardware interface devices for control of HVAC systems and other equipment

SYSTEM DIAGRAMS:

SIMPLYSNAP SITE CONTROLLER

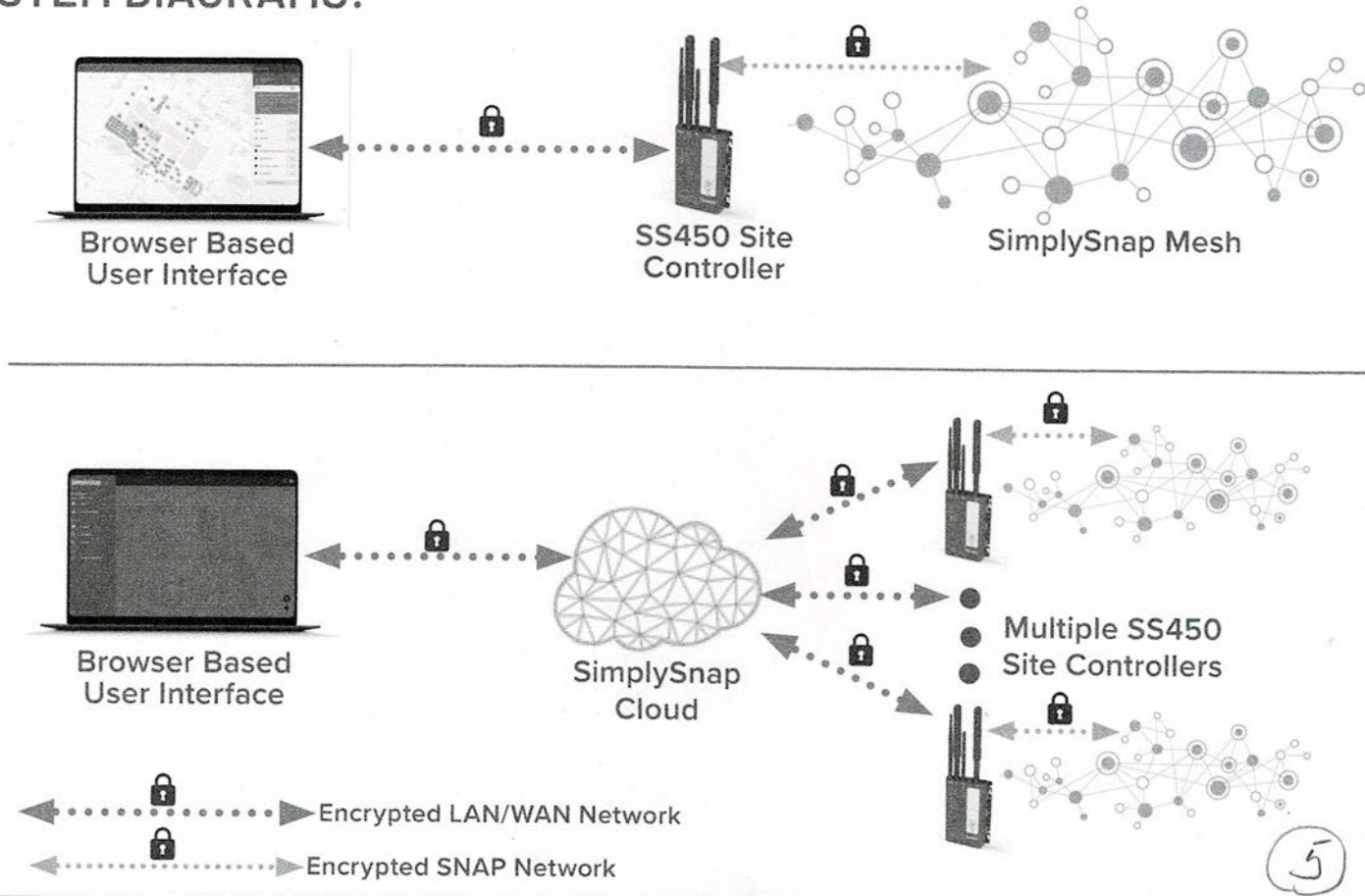

5

12

Specification Data	
Job Name	
Type	
Catalog #	
Comments	

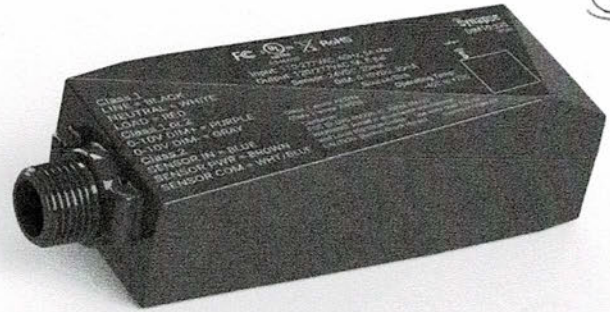

PRODUCT OVERVIEW

The DIM10-220 provides real-time control with power monitoring to help meet California Title 24 and other energy regulations. It also includes a 24VDC sensor input and power supply to connect a sensor into the SimplySnap wireless lighting solution. It is designed for retrofit applications or for use with new fixtures that do not have room for integrated controls.

KEY FEATURES:

- Available with internal and external antenna options (Antenna not included)
- Supports variety of fixture designs and mounting options
- IP65 rated for indoor and outdoor applications
- Power Monitoring
- Class 1/2 0-10V Dimming Control
- True On/Off functionality via switched relay
- Self-healing SNAP Mesh Networking
- Supports a wide range of LED drivers
- Supports 24VDC sensors (consult sales for list)
- Secure, over-the-air upgrades to support future enhancements
- DLC Certification for both Indoor and Outdoor

Bolt-on controller for indoor and outdoor applications

Order #	Description
DIM10-220	Bolt-on controller with external antenna connector
DIM10-220-F	Bolt-on controller with internal antenna

Dimensions	6.1" L x 2.1" W x 1.6" H (153.7 x 53.9 x 41.8mm)
Mounting	Conduit Knock-Out, Hanging Kit, or in Fixture
Input Power ¹	110-277VAC, 50/60Hz
Load Rating ¹	5A @ 120/277VAC (+/- 10%)
Surge Rating	6KV
Operating Environment	-40°C to +70°C
IP Rating	IP65
Wiring	15" wires attached (+/- 1")
Dimming Output	0-10V, Class 1/2, 30mA
Radio	SNAP 2.4GHz ; 802.15.4 +20 dBm Transmit Power -103 dBm Receive Sensitivity
Sensor Input	0 - 24VDC
Sensor Power Supply	24VDC @ 20mA
Power Monitoring ²	2% accuracy
Power Readings	Voltage and Watts
Certifications	c(UL)us, FCC/ IC , RoHS
Warranty ³	5 Years

Footnotes:

1. Phase to Phase power is supported, however the controller only switches one phase.
2. 2% accuracy down to 100 Watts
3. See www.synapsewireless.com/warranty for warranty terms



To learn more, call or visit:
synapsewireless.com
 (877) 982-7888

LIGHTING CONTROLLER

6

DIM10-220 DIMENSIONS AND WIRING INFORMATION

B

Note: Bracket only included with DIM10-220 model with external antenna connector

Class 1	
Line	Black
Neutral	White
Load	Red

Class 1 or 2	
0-10V Dim+	Purple
0-10V Dim-	Gray

Class 2	
Sensor In	Blue
Sensor Power	Brown
Sensor Com	White/Blue

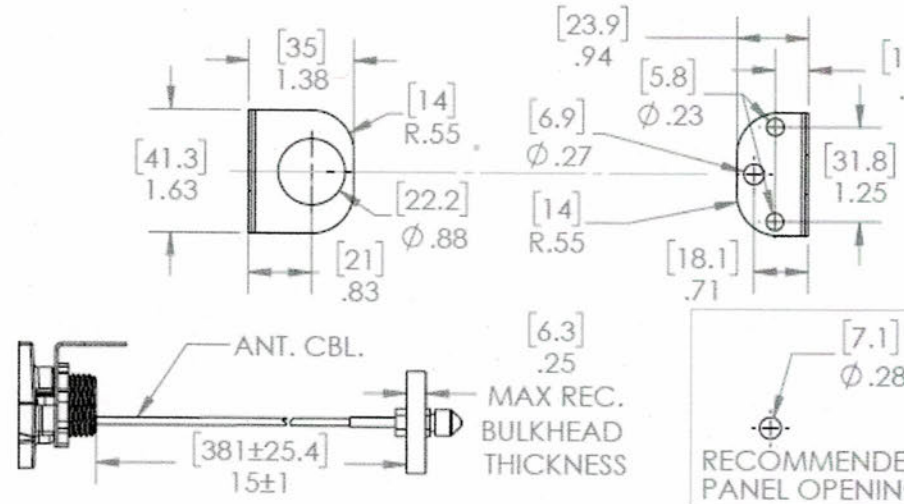

Note: Phase to Phase power is supported, however the controller only switches one phase.

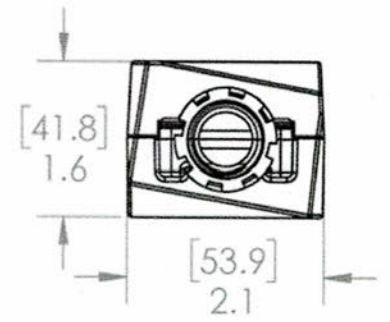
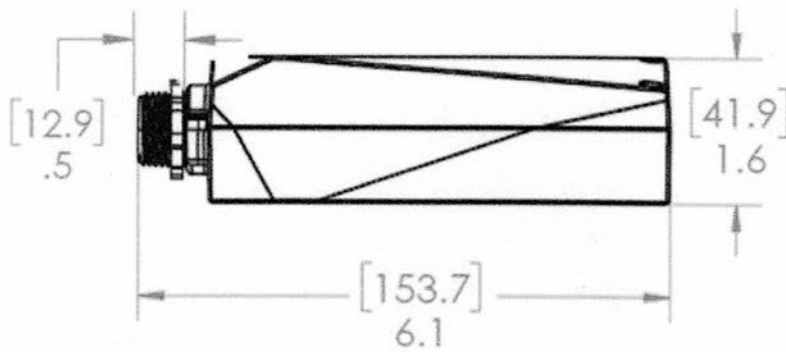

Note: For use with a standard 1/2" EMT knockout.

LIGHTING CONTROLLERS

ACCESSORIES (For use with DIM10-220 with external antenna connector)

Antenna Part #	Description
ANT-ORB-1.5-1	Outdoor Fixed Right Angle Antenna, 1.5 dBi gain
ANT-OSB-1.5-1	Outdoor Straight Antenna, 1.5 dBi gain
ANT-ORS-5.1	Stubby Antenna, Outdoor Right Angle
ANT-OSS-5.1	Stubby Antenna, Outdoor Straight
Hanging Kit Part #	Description
KIT-HP02-01	Hanging Kit, Aircraft cable, Coax cable, 1.5'
KIT-HP20-01	Hanging Kit, Aircraft cable, Coax cable, 20'
KIT-HP30-02	Hanging Kit, Aircraft cable, Coax cable, 30'
KIT-HP50-03	Hanging Kit, Aircraft cable, Coax cable, 50'

2

Specification Data	
Job Name	
Type	
Catalog #	
Comments	

PRODUCT OVERVIEW

The Synapse family of **Wireless Switches** are a set of low-voltage switches that are compatible with SimplySnap. The switches are available in either 2 or 8 button configurations.

Wireless Switches can replace traditional wired switches and provide convenience of lighting control without needing to switch the lighting load directly. The wireless switch communicates via the SNAP mesh network to allow installation of the switch in the most convenient user location. Multiple wireless switches can be used throughout the site and configured to provide optimized control of the lighting.

KEY FEATURES:

- 2 or 8 button configurations
- Mounts in standard single-gang electrical box
- Compatible with the SimplySnap Lighting Control System
- Blue LEDs behind each button indicate activation of button
- Multi-color LED indicates switch communication status and serves as LOCATOR LED
- Up to 5 scenes configurable in SimplySnap can be assigned to each button providing extensive flexibility in lighting control



To learn more, call or visit:
synapsewireless.com
 (877) 982-7888



Flexible Switch Access for SimplySnap

Order #	Description
WSW-02 (See Note 1)	Wireless two-button switch
WSW-02-PS (See Note 2)	Wireless two-button switch with 12V power supply
WSW-08 (See Note 1)	Wireless eight-button switch
WSW-08-PS (See Note 2)	Wireless eight-button switch with 12V power supply
GLP-PS-12V (See Note 2)	12V Power Supply

NOTE 1: These products require DC power for operation. The WSW-02-PS and WSW-08-PS include an AC to DC power supply. If purchasing the WSW-02 or WSW-08, the customer must supply a power source that converts line voltage to a range of 12VDC to 24VDC (1.2W). This power can be provided by the DIM10-250-11 if used as a controller within the lighting solution.

NOTE 2: Power supply must be located in a separate electrical box to meet electrical code requirements.

Dimensions	4.4" H x 1.75" W x 1.5" D 112 x 45 x 38 mm
Input Power	1.2W
Input Voltage	12-24V DC
Operating Environment	-20 to 60 C; 10 to 90% non-condensing
Radio	2.4 GHz SNAP
Certifications	FCC/IC
Warranty ¹	5 Years

1. See www.synapsewireless.com/warranty for warranty terms

WIRELESS SWITCH FAMILY WIRING DIAGRAM

WIRELESS SWITCH
(WSW-08 shown)

POWER SUPPLY (GLP-PS-12V)
(Included with WSW-02-PS and WSW-08-PS)

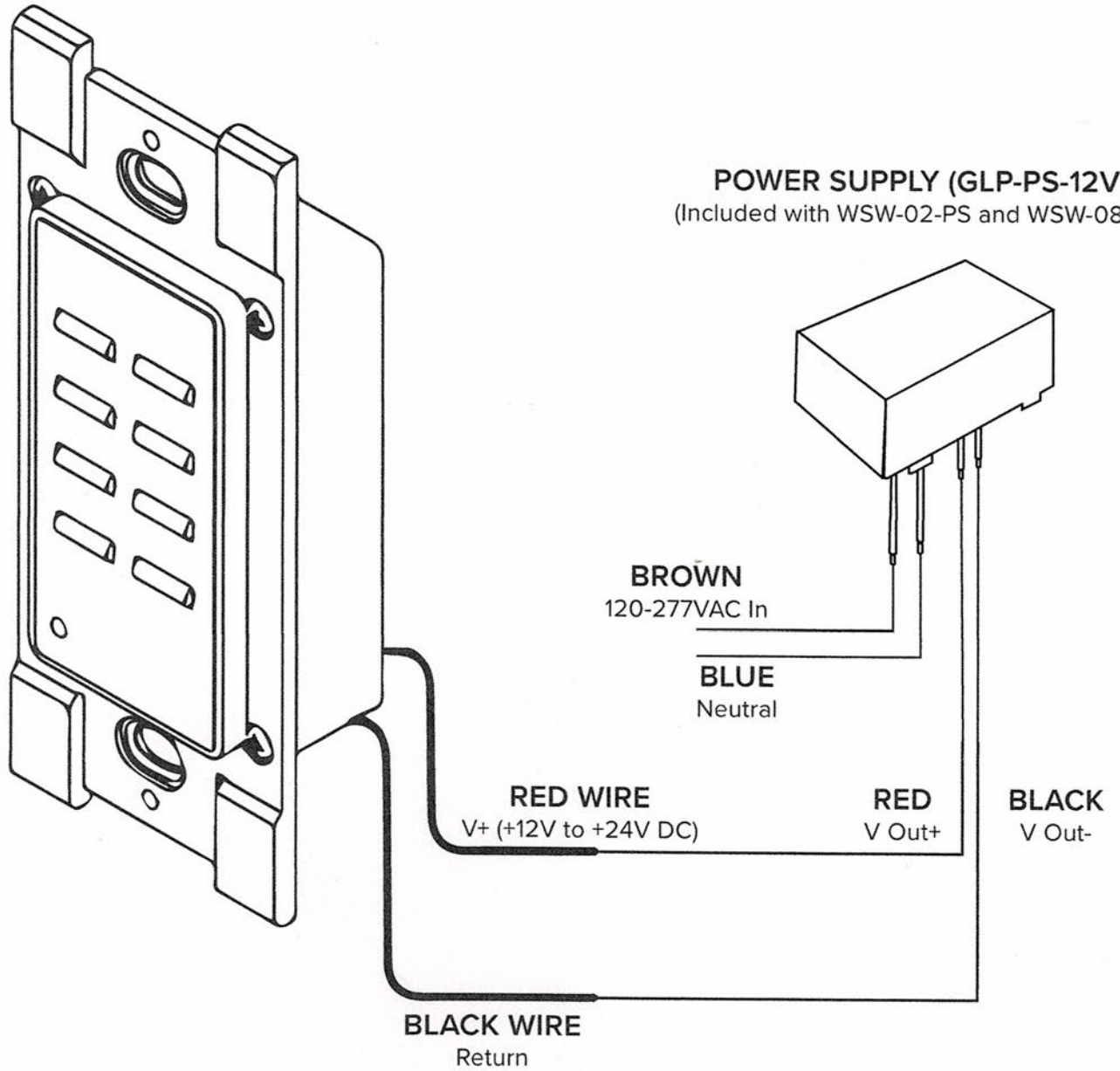

LIGHTING ACCESSORIES



TayMac

*Commercial, Industrial
and Residential Electrical Products*

16

1-Gang Weatherproof In-Use Cover, Expandable, White

Catalog #:
ML450W



16-1

FEATURE BENEFIT

Low profile design expands for weatherproof protection while an outlet is in use

PRODUCT FEATURES

- Revolutionary patented design expands from 1 in. to 3 in. for In-Use needs
- Ultra rugged polycarbonate & synthetic neoprene rubber that will not dry rot, crack or deteriorate in sunlight
- Quick-Fit keyhole mounting system allows installation in under a minute
- Universal Fit Adapter System Technology (U-Fast) for 55-in-1 custom device configurations, comes pre-configured for GFCI
- 100% paintable surface
- Clear window allows for quick/easy visual inspection
- Includes attached gasket and mounting hardware
- Vertical or horizontal device mount

APPLICATIONS

The original attractive profile in-use cover for residential or commercial applications

CERTIFICATIONS



PRODUCT SPECIFICATIONS

UPC Number:	092326113106
Ea Length/Depth (in.):	1.25
Ea Width (in.):	4.02
Ea Height (in.):	6.11
Wt. Ea. (Lbs.):	0.410
Package Type:	Shrink Wrap
Product UPC-A Labeled:	Yes

PACKAGING

Pack I2of5:	30092326113107
Standard Carton Qty:	10
Min Order Qty:	1

Outdoor Comforts
Enhance Your Outdoor Space!

10

▲ WARNING: Cancer and Reproductive Harm - www.P65Warnings.ca.gov

Revision 1, December 2019



TEMPE SOUTH MOUNTAIN N.A. MEETING APRIL 9, 2022

PLEASE SIGN IN WITH YOUR NAME ADDRESS & PHONE NUMBER. PLEASE ALSO VOTE ON KEEPING

LEADS & GRANT APPLICATION

<u>NAME</u>	<u>ADDRESS</u>	<u>PHONE</u>	<u>KEEP LEADS Y OR N</u>	<u>GRANT APP. Y OR N</u>
Jano Newton			yes	yes
MARION BREWSTER			yes	yes
Dan Brooks			yes	yes
for Jody Brewer			yes	yes
	Joanne Locca		yes	yes
	Evelyn Locca		yes	yes
* Molly ENRIGHT	molly-enright@tempe.gov		yes	yes
Joanne & Curt Foster			yes	yes
Lyle Larsen Jr			yes	yes
Ereg Williams			yes	yes
KIRSTIN MCELSEAN			yes	yes
Steve EITNER			yes	yes
Jesse Douglas William			yes	yes

~~yes leads~~
~~yes leads~~
~~yes leads~~
~~yes leads~~

Meeting

NAME ADDRESS PHONE KEEP LEADS OR N GRANT APP. OR N

r/habedoya 21 @ Gmail. com

Jesse Nava 2622 W. Arroyo Dr Tempe 480-799-2098 Yes

Rita Bedoya 2622 W. Arroyo Dr Tempe 480-799-2098 Yes

Araceli Carraval 4414 S. Fair Lane Yes

Blanca Reyes 2618 W. Dunbar (480) 710-3732 Yes

Rox & Deborah Rodriguez Yes

Delays Helou (James) 4630 S. Callejas Corvallis Yes

Michelle R Brown, 2601 W. Fremont Dr. 602-438-9644 Yes

2311 W. Riviera Dr

Rebecca Brighton Tempe 85282 480-239-8434 Y

Zach Louis 2234 W. Riviera Dr Tempe AZ 85282 614-273-7981 Y

Dania Martel 2305 W. Riviera Dr (602) 535-6184 Yes

JULIANE BUSKAMBERT 2275 W. RIVIERA DR 480-449-9885 YES

Refers not to sign 2317 W. Riviera Dr IN FAVOR

Pg 2/2

Thank you Molly

M BROWNELL FOR <mbrowne50@msn.com>

Sat 4/9/2022 5:04 PM

To: MOLLY ENRIGHT -POLICE SVCS <molly_enright@tempe.gov>

Hi Molly.

We would like to say thank you so super much for stopping by this morning. I am sure you could tell that we where surprised that you stopped by.

With you stopping by & answering questions & sharing information you looked up it really made a difference for all of us. We think that some of the information that you shared coming from you made more sense & that we are not just trying to appease them.

Again, thank you for taking the time to stop by, it is appreciated all the way around:)

Marion Barb Jane

Card Received 4-6-2022

26



Tempe South Mountain
Neighborhood Association
Meeting
Saturday, April 9 | 10 a.m.
Svob Park

Greetings neighbors! After a two year hiatus, we are once again ready to have our annual Neighborhood Association meeting. We will meet Saturday, April 9th, 10 a.m., at the North side of Svob park. We will utilize the picnic tables, but suggest attendees bring a lawn chair as seating may be limited.

We have spent the past couple of years trying to address neighbors requests for additional bench seating on the park perimeter as well as the limited control over the East end sports lighting. Without the funding through the Maryanne Corder Neighborhood Grant, we wouldn't be able to accomplish the many projects that other Tempe neighborhoods have. Just in the last couple weeks, we have cleared the hurdles and are excited to share **we would like to apply for a neighborhood grant to fund the added amenities** folks have inquired about, and believe this project to be an upgrade that will compliment the two Ramadas that will also install in the future.

For those not able to attend, we'd be happy to chat and hear your comments about the proposed grant project. You can reach Marion @ mbrowne50@msn.com or 480-431-0597 or Barb @ bbrooks44@cox.net or Text 480-390-7806.

Upcoming neighborhood association meeting

M BROWNELL FOR <mbrowne50@msn.com>

Thu 3/31/2022 1:12 PM

Original email sent - names removed for privacy

This was also posted on Nextdoor

There will be cards about this meeting coming to you in the mail....Marion

Greetings neighbors,

After a two-year hiatus, we are once again ready to have our annual Neighborhood Association meeting. We will meet Saturday, April 9th, 10 a.m., at the North side of Sycamore park. We will utilize the picnic tables, but suggest attendees bring a lawn chair as seating may be limited.

We have spent the past couple of years trying to address neighbors' requests for additional bench seating on the park perimeter as well as the limited control over the East end sports lighting. Without the Funding through the Maryanne Corder Neighborhood Grant, we wouldn't be able to accomplish the many projects that other Tempe neighborhoods have. Just in the last couple weeks, we have cleared the hurdles and are excited to share we would like to apply for a neighborhood grant to fund the added amenities folks have inquired about, and believe this project to be an upgrade that will complement the two Ramadas that will also install in the future.

For those not able to attend, we'd be happy to chat and hear your comments about the proposed grant project.

You can reach Marion @ mbrowne50@msn.com or 480-431-0597

Or Barb @ bbrooks44@cox.net or Text 480-390-7806

NEIGHBORHOOD ASSOC. MTG APRIL 9 10AM
M BROWNELL FOR <mbrowne50@msn.com>
Fri 4/8/2022 8:15 AM

Reminder email -
Names Removed again

This was also posted
on Nextdoor

1 attachments (155 KB)
BENCH PICTURE.jpeg;

This is a gentle reminder about our meeting tomorrow....hope to see you there...Marion

Here is a picture of the bench that we have requested for our park & more information on what we are asking for in our grant.....

This Saturday, 10 a.m, Svob Park

Hopefully everyone has received a City postcard? Meeting will be short. No speakers this time, as we are under a deadline for applying for a Grant.

Some of you may already be aware that the City is adding two Ramadas to the park in the near future. One northeast at the playground, and one northeast of the basketball courts. This was voted on last October. We, as a Neighborhood Association, were finally able to acquire a couple added amenities to the park. At Sat. Meeting, We'll be voting on whether to add the benches (3 locations) On the west end. Something we have been asked about for a few years now. The benches will match the existing ones. Attached is a picture of the bench set up at another neighborhood park. Our thought was ours May face the retention basin

area, but it could face either way. Open to suggestions. The other amenity, And we're quite excited about it, is to have finally cracked the code to allow the sports field lights to Dim, and stay on through the night, at reduced illumination. This has been a consistent request for the east side of the park for a long time now. Ok when there's team practices in progress, but lights shut down at 10, or sometimes not on at all if no activities, leaving that area "scarily" dark, to quote residents. There are four poles on that end, each with 3 lights. With updated technology, these 4 sets of Sports lights will be set up with One light on each pole, to come on Dim, and operate from dusk to dawn. Teams will still have the availability to use the push button for brights, but otherwise, after 10 pm., or with no activity, the lights will be dim, similar to others in the park. This is a huge win for our neighborhood. Please join us on Sat., share your thoughts, and see if we can make this happen sooner rather than later, for the safety of all.

As a side note, we have also had requests for actual perimeter lighting, near the sidewalks, but per the Park Supervisors, that is not something Tempe has at any neighborhood parks currently. If you aren't able to join us at Svob , but wish to sign , please feel free to contact us. Link to Ramada info....

<https://www.tempe.gov/government/community-services/parks/parks-capital-improvements-plan/svob-park-improvements>

← Neighbor Kathy Filer 4... [Video call icon] [Voice call icon] [Search icon] [More options icon]

I put it on my calendar!

N

Ha ha, will probably walk if the neighbors want to walk down like last time.

Saturday • 10:21 AM

Hi Barb! Sorry I am missing the meeting. I just found out a friend died.

What do I need to do to sign or approve anything

for the party

N

Park

Kathy Nieboer



Eastbound traffic to the eastbound it was the light...
green with the exit sign from the freeway to baseline.
Change in the light yellow for traffic getting on the eastbound
freeway.

4 minutes ago

Barb, you am a yay, for the park lights!

Could not attend mtg