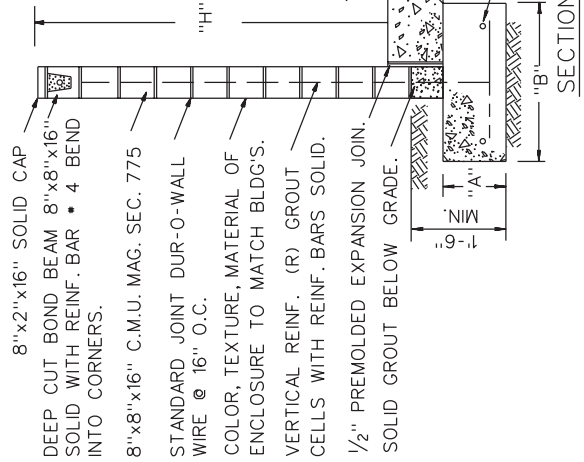
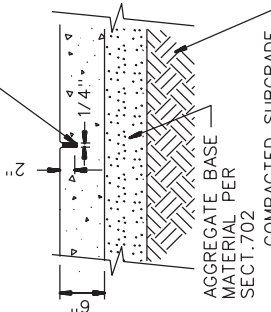

TABLE # 1

"H"	"A"	"B"	"R"
6'-0"	12"	24"	# 4 @ 48"
7'-0"	12"	24"	# 5 @ 48"
8'-0"	12"	24"	# 5 @ 48"
9'-0"	12"	28"	# 6 @ 48"
10'-0"	12"	30"	# 6 @ 48"

SILICON SEALANT  
RECESS 1/4" FROM  
TOP OF CONCRETE.



TYP. WALL FOR SECTION A-A

1/2 SLOPE MIN.

SECTION B-B

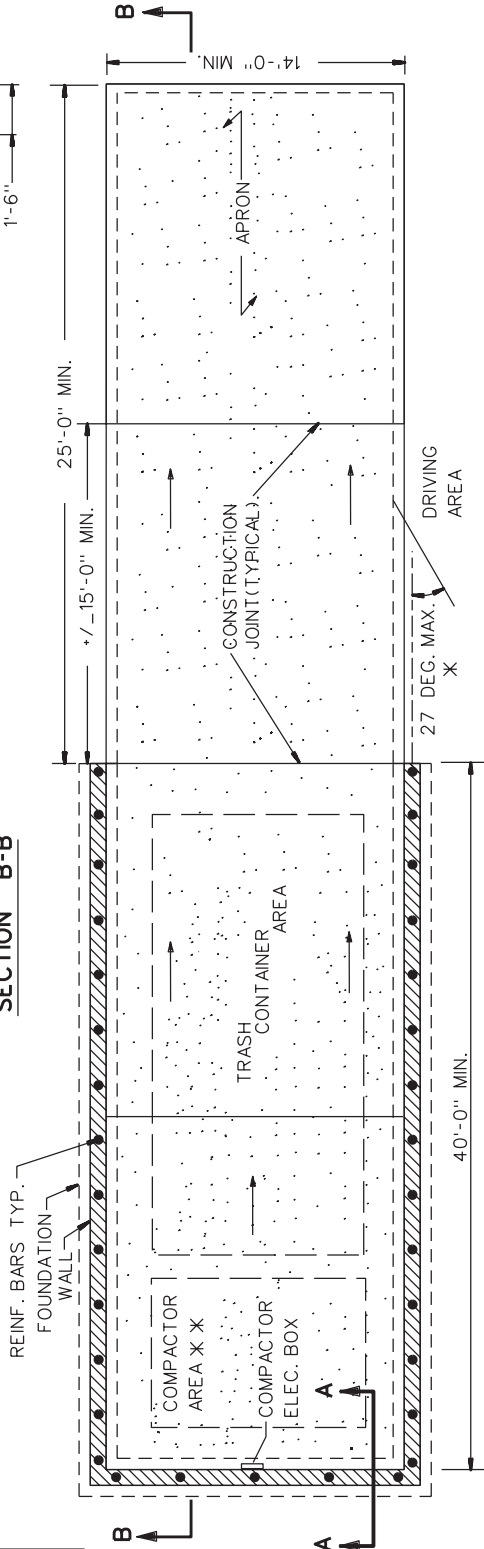

LARGE COMPACTOR ENCLOSURE

NOTES:

- PROPER CLEANING METHODS ARE TO BE USED TO PREVENT THE DISCHARGE OF WASH WATER INTO PUBLIC STORM DRAIN SYSTEM. PLEASE CONTACT THE CITY OF TEMPE ENVIRONMENTAL DIVISION AT 480-350-2678 FOR A LIST OF BEST MANAGEMENT PRACTICES THAT WILL HELP YOUR FACILITY COMPLY WITH ENVIRONMENTAL REGULATIONS.
- THE PROPERTY OWNER SHALL BE RESPONSIBLE FOR THE MAINTENANCE AND REPAIR OF ALL SURFACES, ASPHALT AND CONCRETE, ALONG THE DRIVE PATH OF COLLECTION VEHICLES.
- \* \*- PROVIDE PEDESTRIAN ACCESS TO THIS AREA (THRU WALL)
- GATES REQUIRE PRIOR APPROVAL BY THE CITY OF TEMPE.
- CONSTRUCT ENCLOSURE PER M.A.G. SECTION 510 AND 725.
- WALL HEIGHT PREDETERMINED BY COMPACTOR HEIGHT (6'-0" MIN.)
- \* - FINAL LOCATION & ORIENTATION TO BE DETERMINED BY THE CITY.
- ALL INTERIOR PAD DIMENSIONS ARE MINIMUMS.
- MASONRY  $f_m = 1,500$  psi
- REINFORCING  $f_y = 60,000$  psi /  $f_s = 24,000$  psi
- CONCRETE:  $f'_c = 4,000$  psi
- 2" XOREX STEEL FIBER 39.00 LBS/CY