

2016-2017 MARYANNE CORDER NEIGHBORHOOD GRANT PROGRAM APPLICATION
\$10,000 maximum amount per applicant
Application deadline: Monday, April 4, 2016, 5:00 p.m.

APPLICANT INFORMATION

Name of association: Tempe Gardens HOA

Number of households: 169 Zip code area: 85282

Project site major crossroads: Mill Ave. both N+S of US 60 (E side)
(of Mill Ave.)

Project is located on:
 City right-of-way City property like a park Private common area or property

Name of contact person: Lucy Logan
(Grant coordinator who can answer questions and receives all correspondence related to the project)

Phone: [Redacted]
Address: [Redacted]

Name of authorizing official: Ogden Mgt. - Robert Helms, Mgr.
(Person with legal authority to accept and disburse funds for the organization)

Phone: [Redacted]
Address: [Redacted]

STAFF CONTACT(S)

Name of city staff person(s) contacted: Elizabeth Thomas, Shawn Thomson +
Pete Smith, Tony Miano

SIGNATURE

By signing below, I certify this proposal meets all minimum requirements. I also understand that funding for proposals is not guaranteed.

* Authorizing Official's Signature: [Signature] Date: 4/1/16

PROJECT NARRATIVE

In the space provided below, please describe specifically how the City of Tempe's funds will be used:

The Xeriscape project we propose includes the space between the sidewalk and Mill Ave. both North and South of US 60 (East Side) (of Mill Ave.) Currently the area is irrigated Turf (Bermuda grass), and we want to change it to an attractive Xeriscape with low water trees and plants. We see it becoming an attractive gateway to Tempe from the US 60, and water savings for the environment. The matching grant funds will make this project possible.

PROJECT BUDGET

Expenses - ^{All} See bids.	Amount
Greenpart (best bid option)	\$20,600
	\$
	\$
	\$
	\$
	\$
TOTAL EXPENSES:	\$20,600

City Funds Requested: 10,000
 (amount should equal one of the included bids)

Dollars per household: 121.90
 (funds requested divided by # of households)

Match from Association: 10,600
 (Must be at least 1/2 of total project cost for HOA's/apts.)

Total project cost: 20,600
 (amount should equal one of the included bids)

1. Please describe how this project meets each of the guidelines listed:

A. Improves health and safety of residents:

Saves water for the environment
Improves the beauty of the walkway encouraging walking,
bicycling, more welcoming and inviting to users and
passerby.

B. Benefits a significant number of residents and/or the City at large:

Beautifies the Mill Ave Corridor N+5 of US 60 (East Side)
Saves water/saves money/saves maintenance

C. Addresses a known neighborhood deficiency:

~~Some people prefer grass~~ Provides shade on
sidewalk - currently full sun.

D. Complements other neighborhood projects (private or City):

The west side of Mill Ave - Apartments have an
attractive ^{current/modern} landscape.

E. Provides an environmental benefit, such as water and/or energy conservation:

Saves water - reduces maintenance

F. Enhances the aesthetics of the neighborhood:

Beautifies the Mill Ave Corridor.

G. Accessible to all members of the community:

This is visually the Mill Ave face of the community.

2. Describe how members of the community have been directly involved in the development of the project.

The Clubhouse has been open for discussion
every Tuesday 5-7 PM - ^{Multiple} Notices in Newsletter.

3. Grant funds can only be used for the capital improvement project, not maintenance. Please describe specifically how the association intends to maintain the project if funded.

We already have a landscaper to maintain the area. Currently that includes water, mowing, fertilizing, etc. Conversion to xeriscape should reduce maintenance + water costs, but our landscaper will continue to irrigate and care for the area, and any new plantings.

4. If your association has previously received grant funds, please share how they have impacted your neighborhood.

Many years ago I think the HOA received a City Grant. It may have been for playground equipment. I am not sure? *Staff^{NS} Note: 2000-2001 grant for landscape improvements (\$5,000.) and 1998-1999 grant for playground (\$8,681.) and 1997-1998 another playground equipment grant (\$8,681.)

5. Outside of grant projects, please describe any other activities your association has participated in (i.e. GAIN, Adopt-A-Park, food drives, etc.) within the past year.

Alley Clean-up and environmental information distribution - (to our residents) and tabling.

6. What is your proposed timeline for the grant project?

Spring + Summer 2016

Tempe Gardens Talk

2016 Calendar Notes - Come Join Us!

Game Time Tuesday - Every Tuesday from 5 to 7 pm - this is a great time for kids and parents to have fun with their neighbors. The North Clubhouse is opened up for ping-pong, pool, and other games. Game Time Tuesday is supervised by volunteer parents and **THEY ARE LOOKING FOR VOLUNTEERS**. If you are a parent who can help with Game Time, please contact our organizer, Mike, at mike@allenmike.com.



Kids please bring your good behavior and leave electronic games home. Those who do not want to behave will be excluded.

2016 Monthly Board Meetings -

Come to our monthly board meetings - we start at 7:00 PM.

- January 25, 2016 (North Clubhouse)
- February 22, 2016 (South Clubhouse)
- March 28, 2016 (North Clubhouse)
- April 25, 2016 (South Clubhouse)
- May 23, 2016 (North Clubhouse)
- June 20, 2016 (South Clubhouse)
- July 25, 2016 (North Clubhouse)
- August 22, 2016 (South Clubhouse)
- September 26, 2016 (North Clubhouse for our Annual meeting @ 7PM. Board meets after.)
- October 24, 2016 (South Clubhouse)
- November 28, 2016 (North Clubhouse)
- December 26, 2016 (South Clubhouse - this meeting may be cancelled due to the holiday).

We Need an Admin Assistant

Are You Good at Taking Minutes?

Our Board is looking for someone who would be willing to attend each Board meeting, take the minutes, transcribe them to a Word document, and then distribute them to the Board for approval. Some work helping to organize, file and build packets for meetings may also be included.

This position would pay \$13 - \$15 per hour and would involve 10-12 hours per month. If you are interested, please reach out to our Manager. You can also come to our next Board meeting or drop by Game Time Tuesday to learn more.

You do need access to a computer, email, and an understanding of Microsoft Word.

City of Tempe Recycling Days Events

We will be hosting an event for residents to learn more about recycling. A representative from the City of Tempe will be helping with an educational event. We will keep you posted at to the actual dates - but it is coming soon!

Maryanne Corder Grant Program

Our HOA is looking at the Maryanne Corder Grant Program again in 2016. This is a fund that will provide a matching grant (up to \$10,000) for enhancement of our community. The Board is currently looking at bids and design criteria for xeriscaping (desert landscaping) sections of grassy areas that run along Mill Avenue between the sidewalk and the street. However, this is a community-wide opportunity for enhancement and we want to get your input also.

The grant will only fund projects that are available to the whole community, is a one-time expense, and does not include operations or maintenance needs. What other ideas do you have on community enhancement? The deadline for the submittal process begins early in March so we need your ideas ASAP. You can email them to our Manager or join us at our next Board meeting. You live here, too, so please give us your input!

Copies of newsletters are posted on our website . They can also be sent via email if you have registered. Please visit our website at www.tempegardenshoa.org if you would like to view our newsletters or other documents. **WWW.TEMPEGARDENSHOA.ORG**

Tempe Gardens Talk

2016 Calendar Notes - Come Join Us!

Game Time Tuesday - Every Tuesday from 5 to 7 pm - this is a great time for kids and parents to have fun with their neighbors. The North Clubhouse is opened up for ping-pong, pool, and other games. Game Time Tuesday is supervised by volunteer parents and **THEY ARE LOOKING FOR VOLUNTEERS**. If you are a parent who can help with Game Time, please contact our organizer,



Mike, at mike@allenmike.com.

Kids please bring your good behavior and leave electronic games home. Those who do not want to behave will be excluded.

2016 Monthly Board Meetings -

Come to our monthly board meetings - we start at 7:00 PM.

- March 28, 2016 (North Clubhouse)
- April 25, 2016 (South Clubhouse)
- May 23, 2016 (North Clubhouse)
- June 20, 2016 (South Clubhouse)
- July 25, 2016 (North Clubhouse)
- August 22, 2016 (South Clubhouse)
- September 26, 2016 (North Clubhouse for our Annual meeting @ 7PM. Board meets after.)
- October 24, 2016 (South Clubhouse)
- November 28, 2016 (North Clubhouse)
- December 26, 2016 (South Clubhouse - this meeting may be canceled due to the holiday).

We often have a board member at Game Time on Tuesdays. You are always welcome to drop by.

Maryanne Corder Grant Program



Our HOA is looking at the Maryanne Corder Grant Program again in 2016. This fund provides a matching grant (up to \$10,000) for enhancement of our community. The Board is currently looking at bids and design criteria for xeriscaping (desert landscaping) the sections of grass that run along Mill Avenue between the sidewalk and the street. In these "border" areas alone we have close to 11,500 square feet of grass which can be converted. We will use low water plants, trees, and shrubs, on separate low-use watering systems, to keep these areas attractive while lowering maintenance and water usage. We hope to get this done in one year, but may need to split this project across two years if we cannot get a quality job done within the budget we have set aside.

About the Maryanne Corder Program

This grant program is a community-wide opportunity for enhancement. Community wide means you – not just the HOA's Board – and we want to get your input also.

The grant program awards funds once a year to winning applicants. The committee will only fund a project that benefits the whole community, is a one-time expense, and does not cover any on-going operation or maintenance projects. The deadline for the submittal process is in early April, so this is happening soon.

If you have other ideas on community enhancement, please email them to us or drop by on Tuesdays during Game Time. If we cannot get them in time for this year, we can add them to our list of proposed projects for next year. You live here, too, so please give us your input!

Copies of newsletters are posted on our website . They can also be sent via email if you have registered. Please visit our website at www.tempegardenshoa.org if you would like to view our newsletters or other documents. **WWW.TEMPEGARDENSHOA.ORG**

Tempe Gardens HOA

Materials provided
to project bidders
3/2016

Thank you for considering this project.

Tempe Gardens HOA is located both North and South of US 60 along the East side of Mill Avenue, in Tempe. We are a condominium complex of 169 townhouse (2-story) units. (There is no mailing address for the complex, but my address (in the middle of the North side) is 16 E Hermosa Drive, Tempe, AZ 85282.)

Tempe Gardens HOA is preparing to xeriscape our landscape (turf) between the Sidewalk and Mill Ave.

On the North side we have approx: 200 linear ft of 5' wide turf, and 465 linear ft of 12' wide turf.

On the South side we have approx: 220 linear ft of 5' wide turf, and 275 linear ft of 12' wide turf

Approx: 11,500sq ft. total.

There is irrigation to the area now, but it serves sprinklers on both sides of the sidewalk. There will have to be some irrigation plumbing and re design as part of the project.

I am asking you to bid the project using the plant guidelines below (all low water plants): AND- Because we might need to break the job in half, and only do one side this year and the other side next year depending on budget considerations, we will want separate bids for North of US60 and South of the 60.

Madison Gold is probably the most economical gravel to use, and that works for us.

All plants/trees should be bid to be in 5gal size (no staking for trees). Planting will be in small groups – some around trees, and some in a color grouping without a tree. This will consolidate the irrigation needs to specific areas where the plant group is located and will accommodate the water needs for the tree in groups with a tree. No trees will be planted in the 5' strips, but groups of 4-12 plants will be spaced appropriately throughout all strips.

Trees: 30 total only in the 12' strips. Tree suggestions are: Palo Blanco, Sisso, and Live Oak

Plants: 300 total:

100 Red Yucca (red, yellow or white) and/or Cape Aloe (Aloe Ferox) red. Mostly in the 5' strips.

100 Red Eremophila (Valentine bush)—it comes in a variety of colors and leaf shapes.

100 Red Justicia (or yellow) and/or Yellow Bulbine (or red).

(If plants tend to spread, they should be planted in the 12' strips.)

If you have any questions, please call Pete Smith (City of Tempe – Water conservation) at 480-350-2668, or

We will need a bid by our March 28 board meeting if possible. The project will not start until May or June.

Thank you for bidding this project.

Lucy Logan, President

[REDACTED]

Subject: Tempe Gardens Xeriscape Bid

Hello Travis Smith,

Thank you for your bid on our Xeriscape project along Mill Ave. In response to your uncertainty about what we wanted in plants-with no design plan--, I encouraged you to be creative. Unfortunately that creativity made for very unequal bids, and gave us serious budget concerns. I now have some better design guidelines that will help us get bids for equal expectations with respect to design and plants desired.

I am asking you to re-bid the project using the plant guidelines below (all low water plants): Because we might need to break the job in half, and only do one side this year and the other side next year. We will want separate bids for North of US60 and South of the 60.

Madison Gold is probably the most economical gravel to use, and that works for us.

All plants/trees should be bid to be in 5gal size, and trees with no staking. Planting will be in small groups – some around trees, and some in a color grouping without a tree. This will consolidate the irrigation needs to specific areas where the plant group is located and will accommodate the water needs for the tree in the group. No trees will be planted in the 5' strips.

Trees: ¹⁰~~30~~ total only in the 12' strips. Tree suggestions are:

Palo Blanco
Sisso
Live Oak

Plants: 300 total

100 Red Yucca (red, yellow or white) and/or Cape Aloe (Aloe Ferox) red. Mostly in the 5' strips.

100 Red Eremophila (Valentine bush)—it comes in a variety of colors and leaf shapes.

100 Red Justicia (or yellow) and/or Yellow Bulbine (or red).

(If plants tend to spread, they should be planted in the 12' strips.)

If you have any questions, please call Pete Smith (City of Tempe – Water conservation) at 480-350-2668, or me:
Lucy Logan, [REDACTED]

Thank you for re bidding this project using these new guidelines.

Lucy Logan
Board President
Tempe Gardens HOA
[REDACTED]

TEMPE GARDENS TOWNHOUSE

P. O. BOX 27301 • TEMPE, ARIZONA 85282

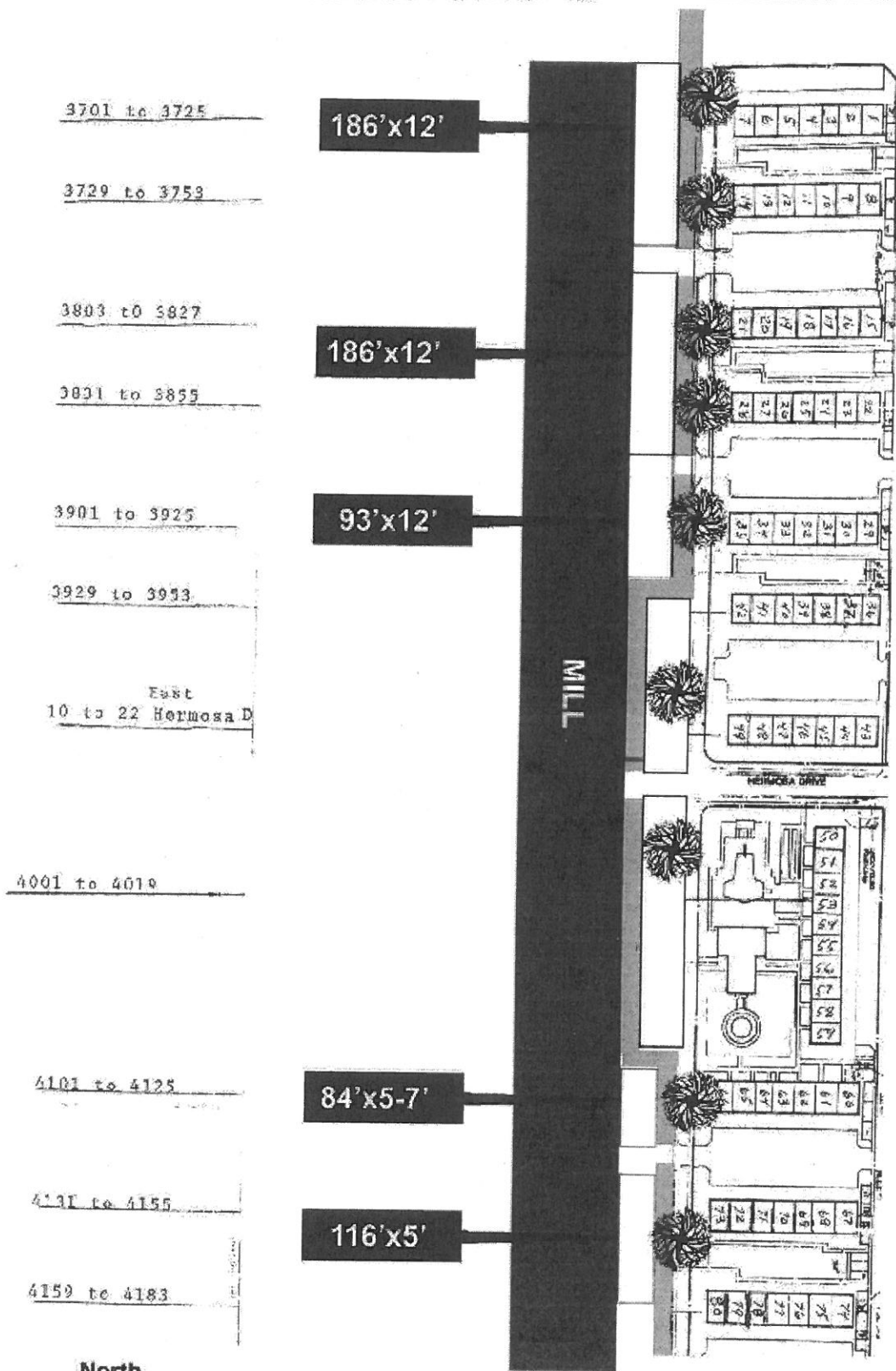

Scale on grass and sidewalk is oversized for clarity

TEMPE GARDENS TOWNHO

P. O. BOX 27301 • TEMPE, ARIZONA

4501 to 4525

119'x5'

4529 to 4553

4557 to 4581

100'x5-8'

4583 to 4599

You can insert text boxes to add comments and notes...

East
11 to 23 Carter I

76'x12'

4601 to 4625

4629 to 4645

4703 to 4723

MILL

4727 to 4751

76'x12'

4801 to 4825

104'x12'

4829 to 4853

East.
10 to 22 Elia Dr.

Scale on grass and
is oversized

5001 to 5009

5013 to 5037

North

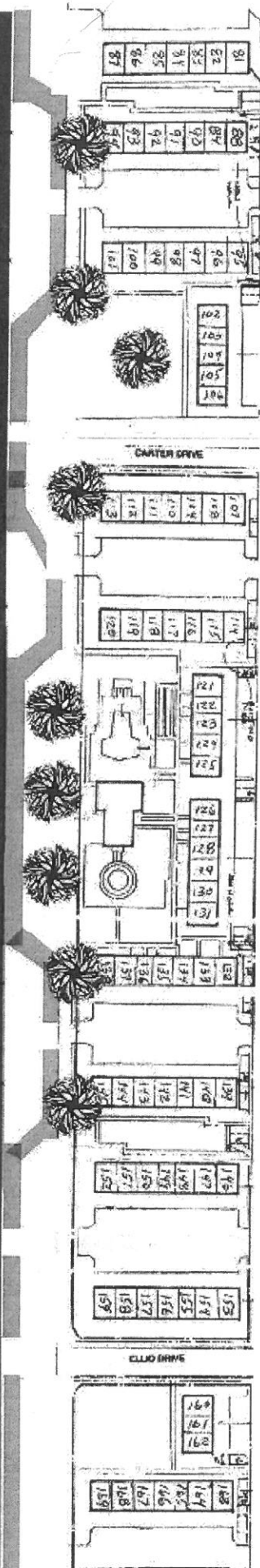

North of US 60

South of Hermosa

12 Trees - only in 12' strips
160 Plants in groups throughout

N ← 5

← 116 →

← 84' →

4'

North of Hermosa

tree

← 93 →

tree

← 186 →

tree

tree

← 186 →

tree

665 linear ft

Mill Ave Side

→ S

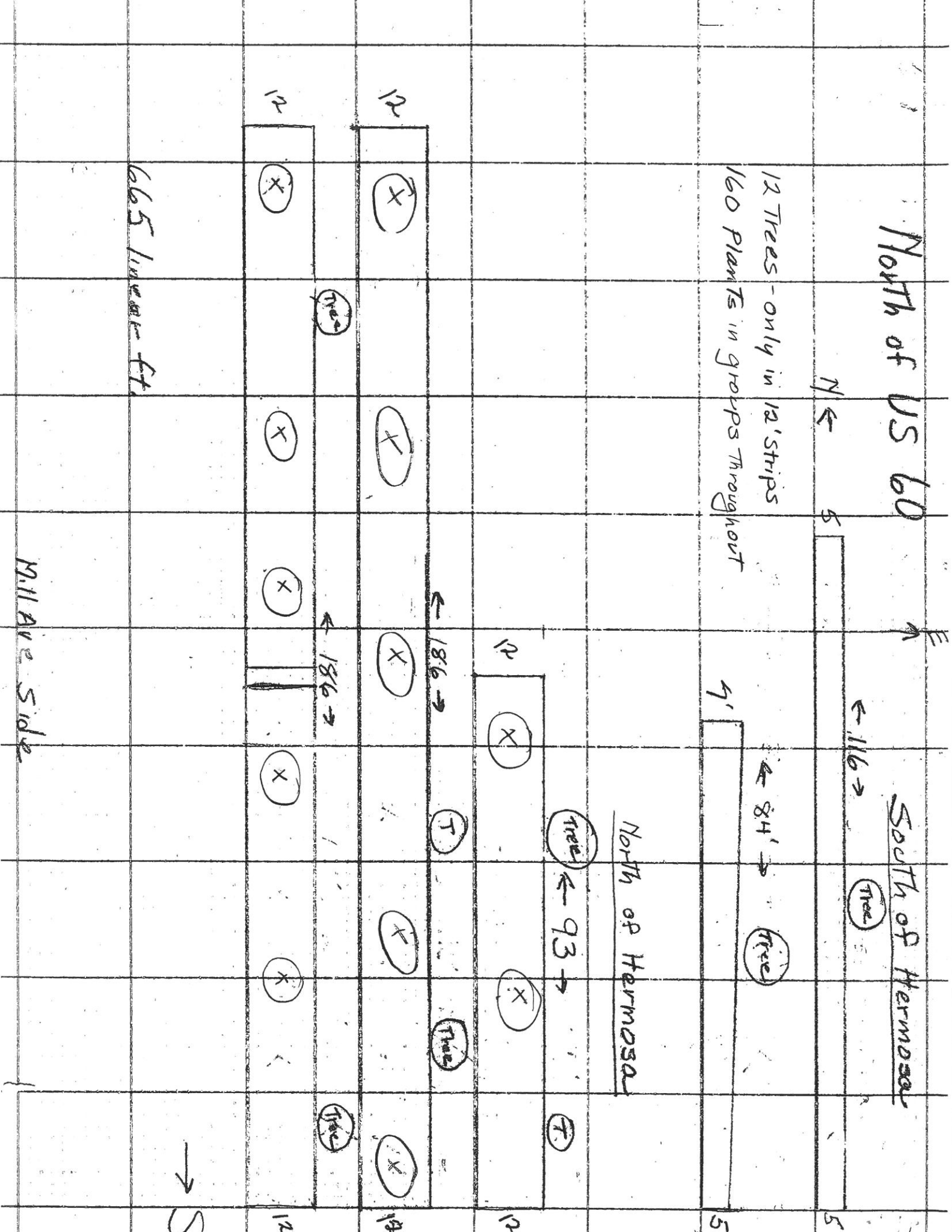

South of US 60

8 Trees - Only in 12' strips
140 plants in groups throughout

N ←

5'



← 119' →



← 100' →



8

→ E

North of Carter

South of Carter

12'

← 20' →



← 76' →



12'



12'

← 104' →



12'



→ S

~ 500 linear ft

MILL AVE Side

**Tempe Gardens HOA
Xeriscape Project
March 2016**

Summary of Bids:

URW (Travis Smith)

Full project (both North and South): 41,790 + plants.

(I asked for a re-bid based on specs developed after his bid, but he hasn't had the time to provide it.)

Think Green (Eddie)

Full project (both North and South): 82,915.69

(When I asked for a re-bid to our specs developed later, they said that if cost was an issue, they would decline to bid.

Greenparti (Our HOA landscapers)

Full project: 20,600

They originally bid the project without irrigation or plants for 7,800, with plants and irrigation they quoted 2,200 for each side.

When asked to re-bid to the new specs, the bid was 6,640.00 for the North, and 6,160 for the South. After the 7,800 for turf removal etc. from their original bid, the total comes to 20,600 . (Their bid includes 5gal and 15 gal sizes instead of the 1gal size called for.)

Native Landscaping LLC (Miguel Delgado)

They bid only the North side 25,130, but if South side is the same, the total would be 50,260. (They did not follow specs and bid 5gal plants instead of the 1gal size in the specs.)

Creative Environments (Amy or Sheldon)

They bid 38,004.17 for the North side and 25,780.10 for the South, Total 63784.27

This is not a firm bid (Budgetary-not for contract). They bid 5gal sizes not 1gal as specified.

It is possible that the actual price from each will be adjusted when the actual plants needed are adjusted to the areas, and the size specs.

Due to budget considerations, the HOA may only do one side this year, and do the other next year. Getting the grant will be a major consideration in determining what we are able to do.



Grant
Xeriscape

Work Proposal

Client: Tempe Gardens Attn: Lucy Logan

Location: Hermosa Drive & Mill Avenue, Tempe, AZ

- Work Description:**
- Line Item A.** Remove existing Turf from Curb to sidewalk and approximately 4" of dirt to reveal an edge around all sides.
 - Line Item B.** Install Drip Irrigation, drip valves, and irrigation controllers as needed throughout the property to adequately water the new plants installed.
 - Line Item C** Furnish and install 110-5 gallon Red Yuccas, 110-5 Gallon Muhlenbergia Capelarias, 110-5 Gallon Desert Milkweed
 - Line Item D** Furnish and install 115 tons of Madison Gold Granite 1/4" minus
 - Line Item E** Post Emergent Application on turf before removal

Item Number	Description	Extended Total
A	Turf removal	\$ 7,949.72
B	Irrigation Installation	\$12,720.39
C	Plant installation	\$11,124.32
D	Granite installation	\$ 9,906.05
E	Post Emergent	\$ 90.00
Total:		\$ 41,790.48

Qualifications & Exclusions:

1. Labor, materials and disposal associated with above listed work is included.
2. This estimate is for completing the job as described above. It is based on our evaluation and does not include material price increases or additional labor and material which may be required should unforeseen problems arise. Estimate is good for 30 days.
3. Permitting not included

Date: 1/14/2016

Submitted By: Travis Smith, Superintendent
602-388-3506
travis.smith@unitedrightofway.com

ROC 103003 A-21
AZ-OPM BL #5169

Lucy Logan

From: Caitlin Johnson [caitlinjohnson@thinkgreenaz.com]
Sent: Monday, March 07, 2016 1:43 PM
To: [REDACTED]
Subject: Think Green

Follow Up Flag: Follow up
Flag Status: Flagged

Hi Lucy,

I am emailing you on behalf of Eddie. I know he was working on a bid to redo your HOA grounds, and you are now getting several bids with a set number of plants/trees/groundcovers etc. We are not going to be competitive in pricing with a large maintenance company, without the ability to really be creative and design oriented we lose the value of why you would go for a design build firm. If cost is not the main focus, we can put something together, but if the several bids will be compared on a cost basis we would like to politely decline the new bid.

Thank you for your time,

Caitlin Johnson
Landscape Designer
Think Green Inc.
Design | Build
480-922-9497 O
973-619-5336 C
www.thinkgreenaz.com

Grant
xeriscaping

THINK GREEN IRRIGATION & LANDSCAPING

7720 E. Redfield Rd. Ste.# 4
Scottsdale, AZ 85260
480-922-9497 office 480-998-7975 fax

Lucy,

This is a standard quote for your future project. An actual estimate would proceed with more information from the City of Tempe, due to landscape permits, density, and other things the city will be asking for. I hope this will give you an idea.

Thanks,
Eddy Logelin
Think Green

Grant
Xeriscaping

Think Green Irrigation & Landscaping

7720 E. Redfield Rd. Ste. 4 Scottsdale, AZ 480-922-9497

Tempe Gardens

01/27/16



*NOTE: This is not a proposal

Customer Totals Sheet

Task Labor Total	\$	-
Demolition & Haul Off Total	\$	17,230.10
Drainage & Grading Total	\$	-
Haul Off Total	\$	-
Mound Boulder & Demo	\$	-
Mounding & Boulders Total	\$	-
Concrete Total	\$	-
Colored Concrete Total	\$	-
Concrete Pavers Total	\$	-
Travertine Pavers Total	\$	-
Flagstone Total	\$	-
Flagstone Overlay Total	\$	-
Water Feature Total	\$	-
Carpentry Total	\$	-
Masonry Total	\$	-
BBQ & Seat Counter Total	\$	-
Fireplace Total	\$	-
Courtyard Wall & Gate Total	\$	-
Concrete Curbing Total	\$	-
Subcontractor Total	\$	-
Irrigation Total	\$	32,185.79
Irrigation Total	\$	-
Electrical Total	\$	-
Wholesale Plants Total	\$	16,885.80
Retail Plants Total	\$	-
Landscape Rock Total	\$	16,614.00
Rock & Material Total	\$	-
Artificial Turf Total	\$	-
Sod & Artificial Turf Total	\$	-
LED Lighting Total	\$	-
Conventional Lighting Total	\$	-
Grand Total	\$	82,915.69

GREENPARTI LAND. AND MAIN. INC.

PROPOSAL#0215A

Office: 602-796-1497 Fax 480-264-2292
e-mail: Greenpartiland@aol.com

DATE: FEBRUARY 19, 2016

TO Tempe Gardens c/o OGDEN, Inc.
1901 E. University Dr. Ste. # 440
Mesa, AZ 85203
Office: 480-396-4567 Fax:
justinem@OGDENre.com
ATTN: Robert Helmes
Roberth@ogdenre.com

PROPERTY: Tempe Gardens HOA
North side freeway 60, areas from sidewalks
out to Mill Ave. street edges.

JOB PROJECT	PAYMENT TERMS
New Xeriscape project for areas to the North of 60 freeway sidewalks to Mill Ave. North side: Total of 7 sections.	Required a 50% down payment on bids over \$1,500.00, the other 50% after work completion.
PROJECT DESCRIPTION:	
<ul style="list-style-type: none">• Installation of new irrigation system including one valve and poly line for the new plants.• Installation of 30 plants along North side area the one will be converted to granite.• One new valve 1" diameter will be attached to existing timer.• Installation of approximate 250 linear ft. of Poly line for new plants, including heads and miscellanies.• Installation of 15 Red Bush Bougainvillea, 5 Lantanas, 5 Birds of Paradise.• Including all dirt and debris removal from property areas and disposal to WM Company.	

TOTAL AMOUNT FOR WORK LISTED ABOVE.....\$2,200.00

- This is a quotation on the goods named, subject to the conditions noted below:
 - Please e-mail signed copy for approval.
- The first day of work will be schedule upon signed acceptance of this proposal.
 - License Number ROC197684 CR-21 & ROC200729 R-62.
 - This proposal is good for a period of 60 days from the above date.

To accept this quotation, please sign here and return:

Board Member Representative Date
C/or Property Manager Representative

THANK YOU FOR YOUR BUSINESS!
ATTENTIVELY, GREENPARTI LANDSCAPING & MAINTENANCE, INC.



GREENPARTI LAND. AND MAIN. INC.

PROPOSAL#0303A

Office: 602-796-1497 E-mail: Greenpartiland@aol.com
 DATE: MARCH 28, 2016

TO Tempe Gardens c/o OGDEN, Inc.
 1901 E. University Dr. Ste. # 440
 Mesa, AZ 85203 Office: 480-396-4567 Fax:
justinem@OGDENre.com
 ATTN: Robert Helmes
 Roberth@ogdenre.com

PROPERTY: Tempe Gardens HOA
 North side freeway US60, areas from
 sidewalks out to Mill Ave. street edges.

JOB PROJECT	PAYMENT TERMS
New Xeriscape project for areas to the North of US60 freeway sidewalks to Mill Ave. 200 linear ft. of 5' wide turf, and 465 linear ft. of 12' wide turf. North side: Total of 7 sections.	Required a 50% down payment on bids over \$1,500.00, the other 50% after work completion.
PROJECT DESCRIPTION:	
<ul style="list-style-type: none"> • Installation of new irrigation system including two valves, poly lines and miscellaneous for the new plants and trees. • Installation of 150 plants in 5 gals. Containers along the North side. <ul style="list-style-type: none"> - 50 Red, Yellow Yuccas, Cape Aloe Red (Aloe Ferox), Mostly in the 5' strips. - 50 Red Eremophila (Valentine Bush) - 50 Red or Yellow Justicia, Yellow or Red Bulbine. • 12 trees varieties Palo Blanco, Sissoo and/or Live Oak in 15 gals. • Installation of two new valves 1" diameter will be attached to existing timer. • Installation of approximate 250 linear ft. of Poly line for new plants, and trees including heads and miscellaneous. • Planting installation will be done in small groups – some around new trees, and some in a color grouping without a tree. This will consolidate the irrigation needs to specific areas where the plant group is located and will accommodate the water needs for the tree in groups with a tree. No trees will be planted in the 5' strips, but groups of 4-12 plants will be spaced appropriately throughout all strips. • Warranty of 6 months for new plants and trees. • Including all dirt and debris removal from property areas and disposal to WM Company. 	

TOTAL AMOUNT FOR WORK LISTED ABOVE.....\$6,640.00

- This is a quotation on the goods named, subject to the conditions noted below:
 - Please e-mail signed copy for approval.
- The first day of work will be schedule upon signed acceptance of this proposal.
 - License Number ROC197684 CR-21 & ROC200729 R-62.
- This proposal is good for a period of 60 days from the above date.

To accept this quotation, please sign here and return:



Board Member Representative Date
C/or Property Manager Representative

GREENPARTI LAND. AND MAIN. INC.

PROPOSAL#1205A

Office: 602-796-1497 Fax 480-264-2292
e-mail: Greenpartiland@aol.com

DATE: DECEMBER 7, 2015

TO Tempe Gardens c/o OGDEN, Inc.
1901 E. University Dr. Ste. # 440
Mesa, AZ 85203
Office: 480-396-4567 Fax:
justinem@OGDENre.com
ATTN: Robert Helmes
Roberth@ogdenre.com

PROPERTY: Tempe Gardens HOA
North and South side areas From sidewalks out
to Mill Ave. street edges.

JOB PROJECT	PAYMENT TERMS
New Xeriscape project for areas to the North and South side of sidewalk to Mill Ave. North side: Total of 7 sections. South side: 4 Sections	Required a 50% down payment on bids over \$1,500.00, the other 50% after work completion.
PROJECT DESCRIPTION:	
<ul style="list-style-type: none">• The areas mentioned above will be modified following the process of plugging the existing PVC irrigation lines including valves and sprinklers from these areas to avoid leaks. This proposal is not including new irrigation or new plants for these areas. The Board Members will have to give us more details on what they want to install.• The scalping/removal of turf areas of 11,500sq/ft. indicated from the Board Members to install new granite following a modification of ground level of 2 inches below the sidewalk-street edges.• Including all dirt and debris removal from property areas and disposal to WM Company.• Chemical treatment application to treat the Bermuda grass roots and residues.• Installation of 120 tons of granite. Name: ¼" washed Madison Gold.	

TOTAL AMOUNT FOR WORK LISTED ABOVE.....\$7,800.00

- This is a quotation on the goods named, subject to the conditions noted below:
 - Please e-mail signed copy for approval.
- The first day of work will be schedule upon signed acceptance of this proposal.
 - License Number ROC197684 CR-21 & ROC200729 R-62.
- This proposal is good for a period of 60 days from the above date.

To accept this quotation, please sign here and return:

Board Member Representative Date
C/or Property Manager Representative

THANK YOU FOR YOUR BUSINESS!
ATTENTIVELY, GREENPARTI LANDSCAPING & MAINTENANCE, INC.



GREENPARTI LAND. AND MAIN. INC.

PROPOSAL#0215B

Office: 602-796-1497 Fax 480-264-2292
e-mail: Greenpartiland@aol.com

DATE: FEBRUARY 19, 2016

TO Tempe Gardens c/o OGDEN, Inc.
1901 E. University Dr. Ste. # 440
Mesa, AZ 85203
Office: 480-396-4567 Fax:
justinem@OGDENre.com
ATTN: Robert Helmes
Roberth@ogdenre.com

PROPERTY: Tempe Gardens HOA
South side freeway 60, areas from sidewalks
out to Mill Ave. street edges.

JOB PROJECT	PAYMENT TERMS
New Xeriscape project for areas to the South freeway 60 from sidewalks to Mill Ave. South side: Total of 4 sections.	Required a 50% down payment on bids over \$1,500.00, the other 50% after work completion.
PROJECT DESCRIPTION:	
<ul style="list-style-type: none">• Installation of new irrigation system including one valve and poly line for the new plants.• Installation of 30 plants along the South side area the one will be converted to granite.• One new valve 1" diameter will be attached to existing timer.• Installation of approximate 250 linear ft. of Poly line for new plants, including heads and miscellanies.• Installation of 15 Red Bush Bougainvillea, 5 Lantanas, 5 Birds of Paradise.• Including all dirt and debris removal from property areas and disposal to WM Company.	

TOTAL AMOUNT FOR WORK LISTED ABOVE.....\$2,200.00

- This is a quotation on the goods named, subject to the conditions noted below:
 - Please e-mail signed copy for approval.
- The first day of work will be schedule upon signed acceptance of this proposal.
 - License Number ROC197684 CR-21 & ROC200729 R-62.
 - This proposal is good for a period of 60 days from the above date.

To accept this quotation, please sign here and return:

Board Member Representative Date
C/or Property Manager Representative

THANK YOU FOR YOUR BUSINESS!
ATTENTIVELY, GREENPARTI LANDSCAPING & MAINTENANCE, INC.



GREENPARTI LAND. AND MAIN. INC.

PROPOSAL#0303B

Office: 602-796-1497 e-mail: Greenpartiland@aol.com
 DATE: MARCH 28, 2016

TO Tempe Gardens c/o OGDEN, Inc.
 1901 E. University Dr. Ste. # 440
 Mesa, AZ 85203 Office: 480-396-4567 Fax:
justinem@OGDENre.com
 ATTN: Robert Helmes
 Roberth@ogdenre.com

PROPERTY: Tempe Gardens HOA
 South side freeway US60, areas from sidewalks out
 to Mill Ave. street edges.

JOB PROJECT	PAYMENT TERMS
New Xeriscape project for areas to the South freeway US 60 from sidewalks to Mill Ave. South side: 220 linear ft. of 5' wide turf, and 275 linear ft. of 12' wide turf Total of 4 sections.	Required a 50% down payment on bids over \$1,500.00, the other 50% after work completion.

PROJECT DESCRIPTION:
<ul style="list-style-type: none"> • Installation of new irrigation system including two valves, poly lines and miscellaneous for the new plants and trees. • Installation of 150 plants in 5 gals. Containers along the North side. <ul style="list-style-type: none"> - 50 Red, Yellow Yuccas, Cape Aloe Red (Aloe Ferox), Mostly in the 5' strips. - 50 Red Eremophila (Valentine Bush) - 50 Red or Yellow Justicia, Yellow or Red Bulbine. • 8 trees varieties Palo Blanco, Sissoo and/or Live Oak in 15 gals. • Installation of two new valves 1" diameter will be attached to existing timer. • Installation of approximate 250 linear ft. of Poly line for new plants, and trees including heads and miscellaneous. • Planting installation will be done in small groups – some around new trees, and some in a color grouping without a tree. This will consolidate the irrigation needs to specific areas where the plant group is located and will accommodate the water needs for the tree in groups with a tree. No trees will be planted in the 5' strips, but groups of 4-12 plants will be spaced appropriately throughout all strips. • Warranty of 6 months for new plants and trees. Including all dirt and debris removal from property areas and disposal to WM Company.

TOTAL AMOUNT FOR WORK LISTED ABOVE.....\$6,160.00



- This is a quotation on the goods named, subject to the conditions noted below:
 - Please e-mail signed copy for approval.
- The first day of work will be schedule upon signed acceptance of this proposal.
 - License Number ROC197684 CR-21 & ROC200729 R-62.
 - This proposal is good for a period of 60 days from the above date.

To accept this quotation, please sign here and return:

 Board Member Representative Date
 C/or Property Manager Representative

**THANK YOU FOR YOUR BUSINESS!
 ATTENTIVELY, GREENPARTI LANDSCAPING & MAINTENANCE, INC.**

GREENPARTI LAND. AND MAIN. INC.

Office: 602-796-1497 Fax 480-264-2292
e-mail: Greenpartiland@aol.com

PROPOSAL#1205A

DATE: DECEMBER 7, 2015

TO Tempe Gardens c/o OGDEN, Inc.
1901 E. University Dr. Ste. # 440
Mesa, AZ 85203
Office: 480-396-4567 Fax:
justinem@OGDENre.com
ATTN: Robert Helmes
Roberth@ogdenre.com

PROPERTY: Tempe Gardens HOA
North and South side areas From sidewalks out
to Mill Ave. street edges.

JOB PROJECT	PAYMENT TERMS
New Xeriscape project for areas to the North and South side of sidewalk to Mill Ave. North side: Total of 7 sections. South side: 4 Sections	Required a 50% down payment on bids over \$1,500.00, the other 50% after work completion.
PROJECT DESCRIPTION:	
<ul style="list-style-type: none"> • The areas mentioned above will be modified following the process of plugging the existing PVC irrigation lines including valves and sprinklers from these areas to avoid leaks. This proposal is not including new irrigation or new plants for these areas. The Board Members will have to give us more details on what they want to install. • The scalping/removal of turf areas of 11,500sq/ft. indicated from the Board Members to install new granite following a modification of ground level of 2 inches below the sidewalk-street edges. • Including all dirt and debris removal from property areas and disposal to WM Company. • Chemical treatment application to treat the Bermuda grass roots and residues. • Installation of 120 tons of granite. Name: ¼" washed Madison Gold. 	

TOTAL AMOUNT FOR WORK LISTED ABOVE.....\$7,800.00

- This is a quotation on the goods named, subject to the conditions noted below:
 - Please e-mail signed copy for approval.
- The first day of work will be schedule upon signed acceptance of this proposal.
 - License Number ROC197684 CR-21 & ROC200729 R-62.
 - This proposal is good for a period of 60 days from the above date.

To accept this quotation, please sign here and return:

Board Member Representative Date
C/or Property Manager Representative

THANK YOU FOR YOUR BUSINESS!
ATTENTIVELY, GREENPARTI LANDSCAPING & MAINTENANCE, INC.



Lucy Logan

From: Greenparti Land. & Main., Inc [greenpartiland@aol.com]
Sent: Monday, March 28, 2016 9:17 AM
To: [REDACTED]
Subject: Tempe Garden projects

Hello,

The only difference from specific request the trees are bid for 15 gals. containers.
Please let me know if you have questions.
Unit price plants. \$32 ea. including drips
Unit price per tree \$120.00 ea.
Valve unit price \$200.00

Thank you,
Have a Great day !

Iliana Partida
Greenparti Land. & Main., Inc.
greenpartiland@aol.com
T: 480-264-2291 Fax: 480-264-2292
Emergency line: 602-796-1497

North Side Only



NATIVE LANDSCAPING LLC

Commercial Insured
3335 E OAK Phoenix AZ
602 718 8557
tacuash@gmail.com

Estimate

Date: March 27, 2016
Invoice # 0077
Expiration Date: May 31, 2016

To: Lucy Logan
Tempe Garden HOA



Job
Tempe Gardens Townhouse, North side of US-60

Qt.	Description	Type	Line Total
6484 sf	remove grass from north of US-60 freeway	Labor / Equipment	\$ 2,500.00
6484 sf	Apply herbicide and pre-emergent and again a week after	Labor & Material	\$890.00
6484 sf	Cancel Existing Irrigation Laterals And Sprinklers Head from demodulation areas	Labor/ material	\$800.00
764 ft 1,306 ft.	Trenching Piping & micro tubing installation	Labor/Material	\$3720.00
5	Sleeves ~8 feet long under sidewalk Sleeves 1, 1/2" PVC class 200	Labor/Material	\$ 650.00
4 Points Of Connection	Digging and install 8 Valves, 8 Filters and 8 Regulator Pressure (30psi). Wiring water proof connectors, Connect low volt. Cable from valves to controllers, set valve boxes [4], backfilling, And program Controller for new Install	Labor Material	\$3,350.00
12	Planting 5 Gal Trees (palo blanco, sisso, and live oak) Install 2 Emitter each tree [5 gph]	Tree Labor Tree Material	\$540.00
150	Planting 5 Gal Shrubs (Red yucca, red eremophila, red Justitia) Install 1 Emitter each shrub [1 gph]	Shrubs Labor Shrubs Material	\$6780.00
6484 sf	Gravel (56.1 ton) Madison Gold 1/4" Decorative gravel From North US-60 freeway	Material /Labor	\$5900.00

Subtotal	
Sales Tax	
Total	\$25,130.00

Estimate prepared by: Miguel Delgado _____

50% of this price must be paid in advance to accommodate materials, the rest upon finished project.

To accept this quotation, sign here and return: _____

Thank you for your business!

NATIVE LANDSCAPING LLC

Miguel Delgado

(602) 718-8557

Xeriscape for Tempe Gardens HOA -North From US 60

Lucy Logan
Board President
Tempe Gardens HOA



Dimensions to xeriscape of landscape (turf) between the Sidewalk and Mill Ave, Tempe AZ

On the North side from I - 60 approx.:	5' wide turf	200 linear ft.
On the North side from I - 60 approx.:	12' wide turf	465 linear ft.

On the south side from I - 60 approx. ;	5 ft. Wide turf	220 linear ft.
On the south side from I - 60 approx.	12 ft. wide turf	275 linear ft.

Total	north from I - 60	sf	6580 sf
Total	south from I - 60	sf	4400 sf

Sisso tree

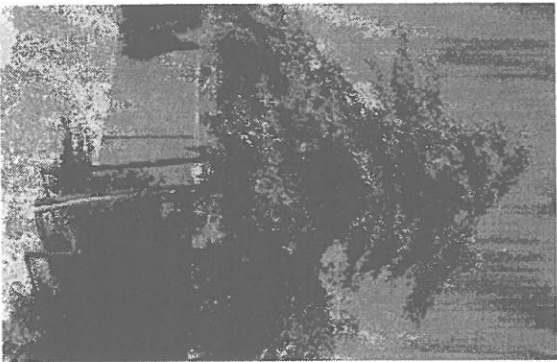

Live Oak



Palo blanco



25 Cape Aloe- Aloe
ferox Red
5 gallon



50 Red eremophila
(Valentine bush)



50 Red Yucca
Red , Yellow or white :

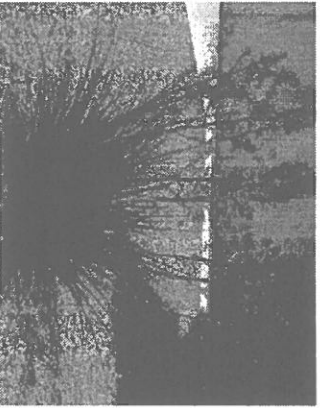

25 Red Justicia
Shrub



North side From I-60 [Cut Turf areas]

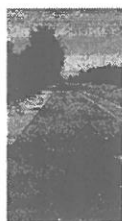

Turf condition

weed control 2 applications (after cut the grass)

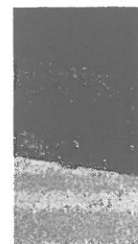

Turf

Will have to Remove a 2" deep trench for storm drainage



Existing Water meter

water meter each BP / Irrigation Controller



Prepare area

Cut down the grass and apply to: weed control material 2 times- every week



Configuration Shrubs

Microtube X " No more longer 6 ft. from lateral | good pressure for the plant |

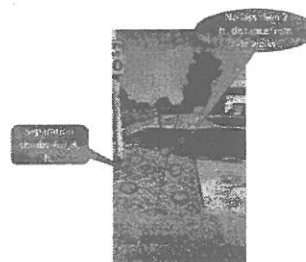

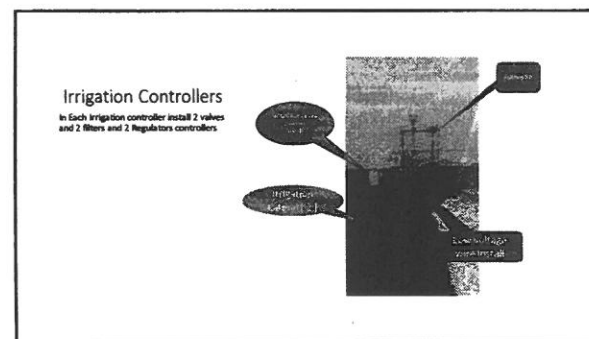
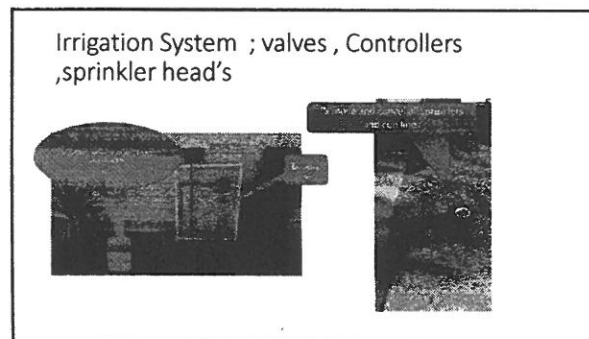
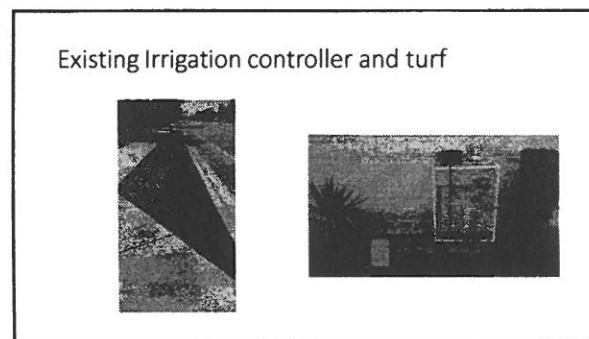
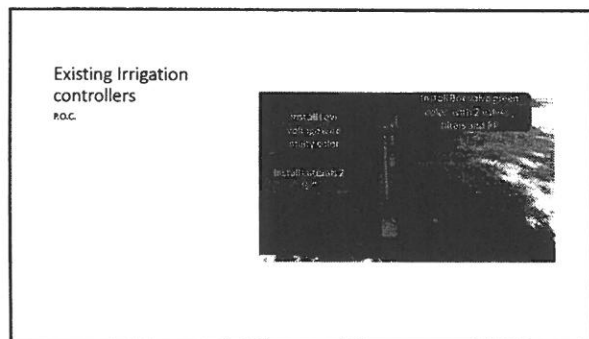
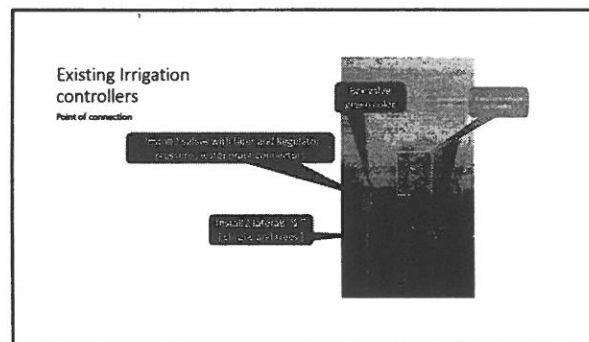
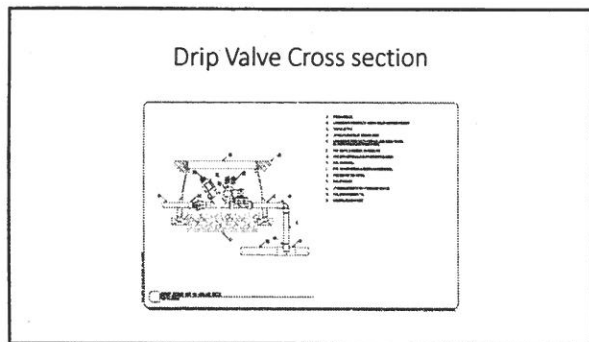

#- 1 , #- 2

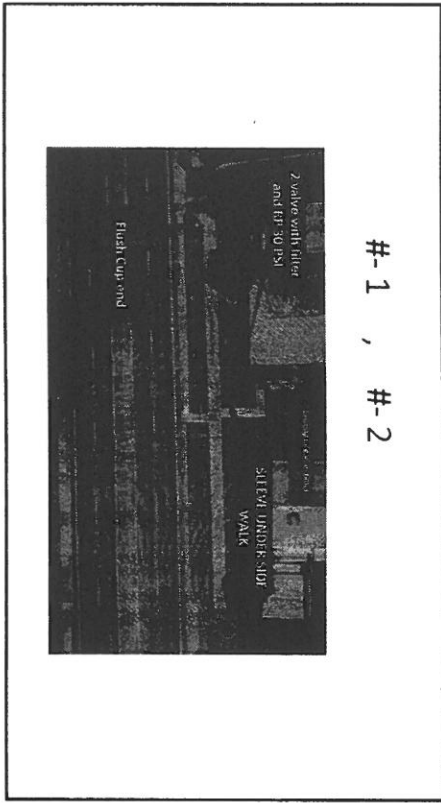

--- 3

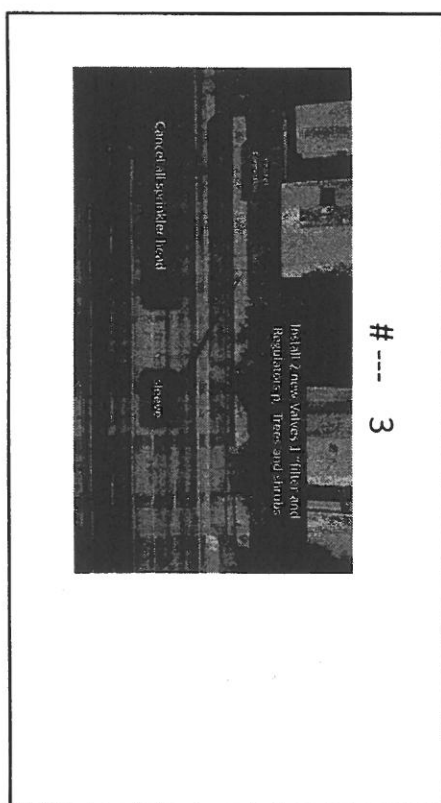

4

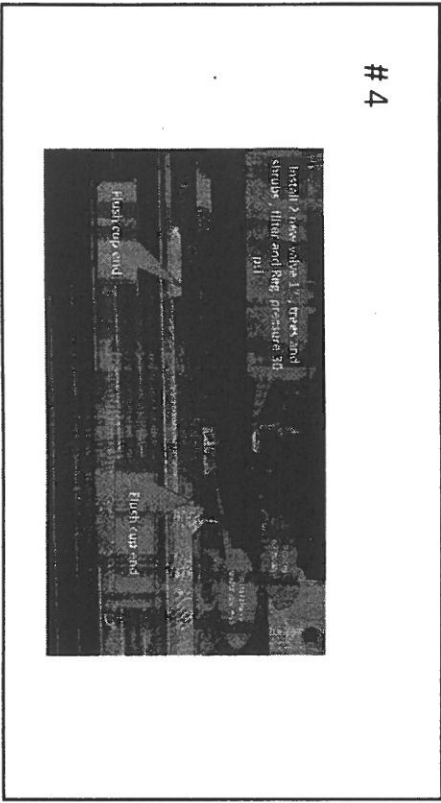

5 and # 6

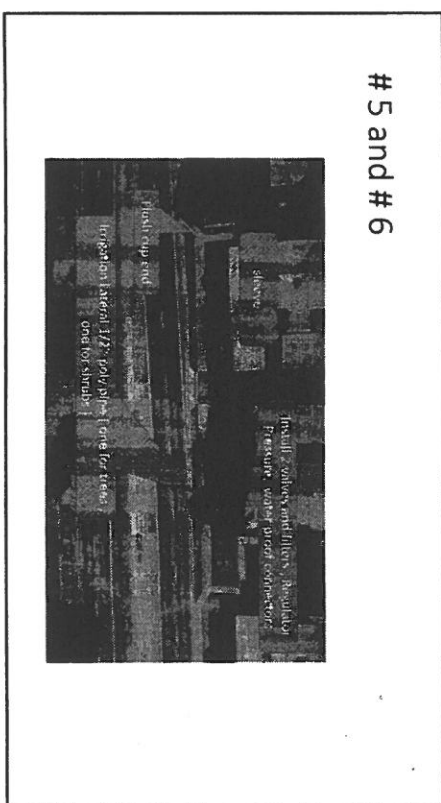



Tempe Gardens North

Budgetary Pricing

Revision A
March 25, 2016

Prepared for:
Tempe Gardens (North)
HOA President Lucy Logan

Property location:
Mill Ave. North of US 60 along the East side.

Prepared by:
Sheldon Johnson
Estimator

We thank you for the opportunity to bid your custom project. Creative Environments brings many years of experience in pool, landscape and water feature design and construction as well as excellent customer service.

Beginning as a family owned company in 1950, CE has created thousands of award winning projects. We are licensed, bonded, and insured in both residential and commercial pools and landscape. Our team is committed to providing excellent service, competitive prices, and quality workmanship to each and every customer.

Our mission at Creative Environments is to provide outstanding design, to build quality outdoor living environments and to ensure on-time production, while remaining committed to customer service and 100% customer satisfaction.

We have created longstanding relationships with numerous homeowners, developers, general contractors and builders throughout the southwest. We take pride in our experienced and knowledgeable employees and our reputation of being able to meet the demands and challenges of each and every project.

Creative Environments prides itself on offering unparalleled customer service, as well as award-winning design, construction and maintenance of residential and commercial landscaping. Every aspect of our business process is crafted to meet the highest expectations of our customers. The best in design, the top craftsmen and the best project managers are at your service to create remarkable outdoor living environments.

Many individuals have attempted to duplicate what our team of principals, management, staff and Designers has built over the years. Our extensive training on design, our quality of labor that builds the designs in-house and our unprecedented customer service provide the foundation for what is often imitated but never duplicated.

Thank you for the opportunity to be a part of your custom project.

Project: Tempe Gardens North

Scope: Removal of landscape and installation of xeriscape with irrigation

Date: March, 25th, 2016

This bid is for the removal of existing landscape and installation of xeriscape with drip irrigation incorporated into the project located at:

**Tempe Gardens
East side of Mill Ave. North of US 60**

This bid includes all material, labor and overhead needed to install the items as described in the email provided by Lucy Logan dated 03/10/16.

Any revision to the plan or Inclusions (i.e. change of quantities, sizes of items, additional materials, etc.) would change the price of the bid.

We thank you for the opportunity to submit a budgetary bid for this project and look forward to future discussions. Please contact me should there be any questions or need of any additional information.

We look forward to working with you on this project.

Sheldon Johnson

Estimator

Creative Environments Design & Landscape, Inc.

This Quote is for Budgetary purposes only

INCLUSIONS:

02900 CSI Code: LANDSCAPE and IRRIGATION

Per the HOA board president Lucy Logan's email

Vegetation:

Trees: 12 total only in the 12' strips. Tree suggestions are: 4 Palo Blanco, 4 Sisso & 4 Live Oak all 5 gallon size.

Plants: 174 total

58, 5 gallon, Red Yucca (red, yellow or white) and/or Cape Aloe (Aloe Ferox) red. Mostly in the 5' strips.

58, 5 gallon, Red Eremophila (Valentine bush)—it comes in a variety of colors and leaf shapes

58, 5 gallon Red Justicia (or yellow) and/or Yellow Bulbine (or red).

Irrigation system:

Irrigation will be consolidated to specific areas where the plant groups are located and will accommodate the water needs for the tree & plants in groups.

Granite / Hardscape:

Madison Gold 3/4 screened (mixed) 50 tons.

Demolition

Removal of existing turf & irrigation (sprinkler) system

City Tax - not applicable

BREAKDOWN

Vegetation, Irrigation & Hardscape \$ 38,004.17

Landscaping Subtotal \$ 38,004.17

VALUE ENGINEERING:

Creative Environments has reviewed the plans for this project and feel confident that there are several areas where we can reduce cost without compromising the esthetic value, appearance or quality of the project.

EXCLUSIONS:

- Gas lines running to pool equipment areas**
- Water supply lines to irrigation areas valve locations**
- Utilities (all power/water to be provided to designated areas by G.C.)**
- Site walls, area walls, perimeter walls (Masonry)**
- All surface decking**
- Benches**
- Fencing, metal screens and hand rails**
- Landscape area lighting**
- Permitting and engineering**
- Entry & area gates**

LANDSCAPE WARRANTY:

VEGETATION - 120 DAYS

Plants, including turf, shrubs, trees, vines and cacti have a 120-day limited warranty (effective at Customer Sign-off). There is no warranty on ocotillo plants. There is no warranty on damage due to Acts of God.

IRRIGATION - 1 YEAR

Irrigation, including sprinklers, emitters, main lines, timer clock and valves (effective at Customer sign-off).

HARDSCAPE - 2 YEARS

Hardscape, including masonry, decking, walkways (effective at Customer sign-off).

All Warranty items shall NOT extend to any item that is damaged or made worse by negligence, improper maintenance, improper operation or alteration of the work by any person other than Creative Environments or any loss or damage resulting from Acts of God or events beyond Creative Environments control.

IMPORTANT NOTES:

Creative Environments (CE) shall not be responsible for any underground-unmarked utilities. CE will be responsible for Blue Staking.

CE cannot assume responsibility for any 'natural peril' which may prove detrimental to plant material or postpone completion of job: such as drought, water restrictions, high winds, excessive flooding, freeze or frost, etc.

CE has bid all material based upon the prices and availability as of the date of presentation. Should availability change by the time of construction, CE will discuss substitutions with the owner.

Landscape Before Tax Budgetary Only Not for Contract	\$	38,004.17
Sales Tax	0.00%	\$ -
Project Total	\$	38,004.17

If any part of this contract will be paid with a mortgage or other financing, it is the customer's responsibility to provide all necessary documents to their respective broker/banker in a timely manner.

Standard Operating Procedure requires a Pre-Lien notice be sent out on any late payments by the customer.

* All change orders are due 100% at time of signing.

NOTE: See other Terms and Conditions for complete contract details. Customer initials required on separate form.

Budgetary Only Not for Contract

\$ 38,004.17

Authorized Signature - Customer

Date

Creative Environments Authorized Signature

Date



Tempe Gardens South

Budgetary Pricing

Revision A
March 25, 2016

Prepared for:
Tempe Gardens (South)
HOA President Lucy Logan

Property location:
Mill Ave. South of US 60 along the East side.

Prepared by:
Sheldon Johnson
Estimator

We thank you for the opportunity to bid your custom project. Creative Environments brings many years of experience in pool, landscape and water feature design and construction as well as excellent customer service.

Beginning as a family owned company in 1950, CE has created thousands of award winning projects. We are licensed, bonded, and insured in both residential and commercial pools and landscape. Our team is committed to providing excellent service, competitive prices, and quality workmanship to each and every customer.

Our mission at Creative Environments is to provide outstanding design, to build quality outdoor living environments and to ensure on-time production, while remaining committed to customer service and 100% customer satisfaction.

We have created longstanding relationships with numerous homeowners, developers, general contractors and builders throughout the southwest. We take pride in our experienced and knowledgeable employees and our reputation of being able to meet the demands and challenges of each and every project.

Creative Environments prides itself on offering unparalleled customer service, as well as award-winning design, construction and maintenance of residential and commercial landscaping. Every aspect of our business process is crafted to meet the highest expectations of our customers. The best in design, the top craftsmen and the best project managers are at your service to create remarkable outdoor living environments.

Many individuals have attempted to duplicate what our team of principals, management, staff and Designers has built over the years. Our extensive training on design, our quality of labor that builds the designs in-house and our unprecedented customer service provide the foundation for what is often imitated but never duplicated.

Thank you for the opportunity to be a part of your custom project.

Project: Tempe Gardens North

Scope: Removal of landscape and installation of xeriscape with irrigation

Date: March, 25th, 2016

This bid is for the removal of existing landscape and installation of xeriscape with drip irrigation incorporated into the project located at:

Tempe Gardens

East side of Mill Ave. South of US 60

This bid includes all material, labor and overhead needed to install the items as described in the email provided by Lucy Logan dated 03/10/16.

Any revision to the plan or Inclusions (i.e. change of quantities, sizes of items, additional materials, etc.) would change the price of the bid.

We thank you for the opportunity to submit a budgetary bid for this project and look forward to future discussions. Please contact me should there be any questions or need of any additional information.

We look forward to working with you on this project.

Sheldon Johnson

Estimator

Creative Environments Design & Landscape, Inc.

This Quote is for Budgetary purposes only

INCLUSIONS:

02900 CSI Code: LANDSCAPE and IRRIGATION

Per the HOA board president Lucy Logan's email

Vegetation:

Trees: 8 total only in the 12' strips. Tree suggestions are: 3 Palo Blanco, 3 Sisso & 2 Live Oak all 5 gallon size.

Plants: 126 total

42, 5 gallon, Red Yucca (red, yellow or white) and/or Cape Aloe (Aloe Ferox) red. Mostly in the 5' strips.

42, 5 gallon, Red Eremophila (Valentine bush)—it comes in a variety of colors and leaf shapes

42, 5 gallon Red Justicia (or yellow) and/or Yellow Bulbine (or red).

Irrigation system:

Irrigation will be consolidated to specific areas where the plant groups are located and will accommodate the water needs for the tree & plants in groups.

Granite / Hardscape:

Madison Gold 3/4 screened (mixed) 32 tons.

Demolition

Removal of existing turf & irrigation (sprinkler) system

City Tax - not applicable

BREAKDOWN

Vegetation, Irrigation & Hardscape \$ 25,780.10

Landscaping Subtotal \$ 25,780.10

VALUE ENGINEERING:

Creative Environments has reviewed the plans for this project and feel confident that there are several areas where we can reduce cost without compromising the esthetic vale, appearance or quality of the project.

EXCLUSIONS:

- Gas lines running to pool equipment areas**
- Water supply lines to irrigation areas valve locations**
- Utilities (all power/water to be provided to designated areas by G.C.)**
- Site walls, area walls, perimeter walls (Masonry)**
- All surface decking**
- Benches**
- Fencing, metal screens and hand rails**
- Landscape area lighting**
- Permitting and engineering**
- Entry & area gates**

LANDSCAPE WARRANTY:

VEGETATION - 120 DAYS

Plants, including turf, shrubs, trees, vines and cacti have a 120-day limited warranty (effective at Customer Sign-off). There is no warranty on ocotillo plants. There is no warranty on damage due to Acts of God.

IRRIGATION - 1 YEAR

Irrigation, including sprinklers, emitters, main lines, timer clock and valves (effective at Customer sign-off).

HARDSCAPE - 2 YEARS

Hardscape, including masonry, decking, walkways (effective at Customer sign-off).

All Warranty items shall NOT extend to any item that is damaged or made worse by negligence, improper maintenance, improper operation or alteration of the work by any person other than Creative Environments or any loss or damage resulting from Acts of God or events beyond Creative Environments control.

IMPORTANT NOTES:

Creative Environments (CE) shall not be responsible for any underground-unmarked utilities. CE will be responsible for Blue Staking.

CE cannot assume responsibility for any 'natural peril' which may prove detrimental to plant material or postpone completion of job: such as drought, water restrictions, high winds, excessive flooding, freeze or frost, etc.

CE has bid all material based upon the prices and availability as of the date of presentation. Should availability change by the time of construction, CE will discuss substitutions with the owner.

Landscape Before Tax Budgetary Only Not for Contract	\$	25,780.10
Sales Tax	0.00% \$	-
Project Total	\$	25,780.10

If any part of this contract will be paid with a mortgage or other financing, it is the customer's responsibility to provide all necessary documents to their respective broker/banker in a timely manner.

Standard Operating Procedure requires a Pre-Lien notice be sent out on any late payments by the customer.

* All change orders are due 100% at time of signing.

NOTE: See other Terms and Conditions for complete contract details. Customer initials required on separate form.

Budgetary Only Not for Contract

\$ 25,780.10

Authorized Signature - Customer

Date

Creative Environments Authorized Signature

Date