

2016-2017 MARYANNE CORDER NEIGHBORHOOD GRANT PROGRAM APPLICATION

\$10,000 maximum amount per applicant

Application deadline: Monday, April 4, 2016, 5:00 p.m.

APPLICANT INFORMATION

Name of association: Papago Park View

Number of households: Approx 400

Zip code area: 85281

Project site major crossroads: Between Scottsdale Rd and College, and Between McKellips and Continental

Project is located on:

City right-of-way

City property like a park

Private common area or property

Name of contact person: Deb Gain-Braleley

(Grant coordinator who can answer questions and receives all correspondence related to the project)

Phone:

Address:

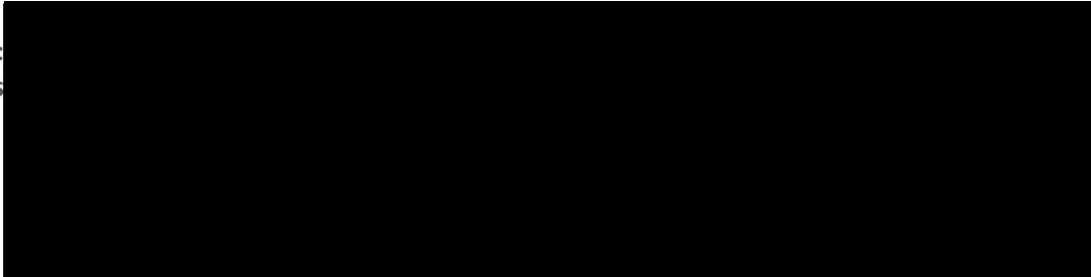

Name of authorizing official: Deb Gain-Braleley or Gina Barriga are Co-Facilitators

(Person with legal authority to accept and disburse funds for the organization) *We have no treasurer, dues or bank accounts.*

Phone:

Address:

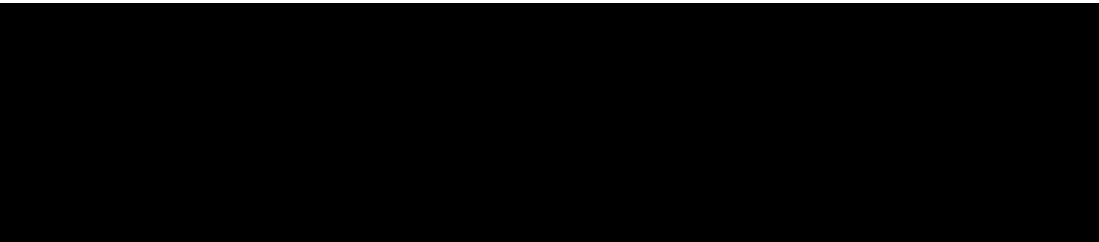

STAFF CONTACT(S)

Name of city staff person(s) contacted:

Steve Horstman – Traffic and Elizabeth Thomas – Neighborhood Services

SIGNATURE

By signing below, I certify this proposal meets all minimum requirements. I also understand that funding for proposals is not guaranteed.

Authorizing Official's Signature: _____

Date: _____

4/3/2016

PROJECT NARRATIVE

**Project 2 OF 2 submitted for Grant Request
SECOND VOTED – STREET SIGN TOPPERS WITH NEIGHBORHOOD NAME**

In the space provided below, please describe specifically how the City of Tempe’s funds will be used:

This request is to purchase street sign toppers with our neighborhood name to be placed above our current street signs. Papago Park View Neighborhood is an old neighborhood that has just recently become a separate part the Tempe Neighborhood Association Program. Previously we considered ourselves simply part of NTNA, but in an attempt to maintain voting rights in NTNA, Papago Park View was formed. Our name was College NA according to city literature, but that has been confusing with neighborhoods south of ASU. In February the neighborhood voted to change the neighborhood name to Papago Park View Neighborhood

These uniform signs throughout the neighborhood should help residents begin to associate their residence as part of this established neighborhood. Neighborhood cohesiveness should help us with our efforts to increase participation in Block Watch, GAIN and other Tempe sponsored activities. Neighborhood cohesion correlates positively with a neighbors willingness to be active for the betterment of the common good, the neighborhood and city according to a University of Chicago study.

PROJECT BUDGET

Expenses	Amount
36 signs x \$54	\$1,944.
Includes 2 extra	
TOTAL EXPENSES FOR	\$1,944

City Funds Requested: \$1,944 Dollars per household: 4.86
 (amount should equal one of the included bids) (funds requested divided by # of households)

Match from Association: 0 Total project cost: \$1,944
 (Must be at least 1/2 of total project cost for HOA’s/apts.) (amount should equal one of the included bids)

1. Please describe how this project meets each of the guidelines listed:

- A. Improves health and safety of residents: Increasing neighborhood cohesion will encourage neighbors to participate in things like block watch and activities that help the common areas of the neighborhood. When neighbors keep track of each other, aging in place, crime prevention and sharing of information in general becomes a little more possible, and easier.
- B. Benefits a significant number of residents and/or the City at large: Strong active neighborhoods keep track of crime, and help neighbors stay informed as to city communications. These activities can help the city reduce needed services.
- C. Addresses a known neighborhood deficiency: This neighborhood is relatively young (<1yr), as an active separate Neighborhood Association. Many do not know what this means or how it can help them. Common signs can help people feel like they are part of this whole neighborhood.
- D. Complements other neighborhood projects (private or City): This goes along with the effort to bring neighbors together and getting them active (GAIN).
- E. Provides an environmental benefit, such as water and/or energy conservation: Not really by signs directly, although active neighbors help train each other to recycle and conserve. We trade plants and seeds and share found new recyclers. We help each other carpool or attend as a representative to bring news back to the neighborhood.
- F. Enhances the aesthetics of the neighborhood: Additional signs look nice. They make the neighborhood just a little special. We are not an HOA with a great monument signed entrance. These signs can have some of that same effect.
- G. Accessible to all members of the community: Higher participation rates, possibly lower crime or errant activity leads to less crime management needed. Greater communication of city changes and requirements can lead to easier adopted change and better success probability.

2. Describe how members of the community have been directly involved in the development of the project. Papago Park View Neighborhood had two meetings with mailings notifying neighbors of the opportunity to propose, vote support and prioritize grant request projects. A longer list of projects was prioritized with this project standing out as the 2nd project we could accomplish this year.

3. Grant funds can only be used for the capital improvement project, not maintenance. Please describe specifically how the association intends to maintain the project if funded: Signs will be placed on top of existing street signs. We, neighbors, currently clean existing street signs, benches and poles of graffiti using a kit supplied by Tempe Pd. We will continue to keep these new signs clean as well.
4. If your association has previously received grant funds, please share how they have impacted your neighborhood: This is the 1st grant application that I am aware of, by this neighborhood.
5. Outside of grant projects, please describe any other activities your association has participated in (i.e. GAIN, Adopt-A-Park, food drives, etc.) within the past year.
 - Papago Park View participated in the GAIN event this last year, our 1st year as a separate NA. As part of NTNA we held an environmental fair in Evelyn Hallman Park, on the camping island. Extra donated food, drinks, snacks and water (a van full) was donated to the Tempe Food Bank.
 - NTNA adopted Evelyn Hallman Park. As part of NTNA our neighborhood helped prune along the parks exterior sidewalks. We also participated in an NTNA event to clean Evelyn Hallman Park and pond. Neighbors from Papago Park View regularly pick up trash and fronds in the park as we walk the park.
 - The neighborhood voted in February and is in the process of adopting a path connecting to the park, but have not finalized nor had our 1st clean up yet.
 - As part of NTNA, many of the neighbors packed food for hungry as a team building event last December.
6. What is your proposed timeline for the grant project?

These signs are made by Tempe, in house. I assume we will be in line with any other neighborhood with a grant approved. Of course we will be excited to have the project done, but can wait our turn, as long as completion is by the June 2016 deadline.

January 2016 - Issue 1

Neighborhood News

College Neighborhood Association (Papago Park View)

Association Borders – Scottsdale Rd to College, McKellips Rd to Continental

Important Meeting:

Our next meeting is January 23, 3pm to 5pm at the Eisendrath House Meeting Room - 1400 N. College. Even if you can only attend occasionally, we would love your help on January 23 to help us make some decisions.



January 23 Agenda:

Crime Prevention and Block Watch – Detective Shelli Miller

Speeding & Traffic – Commander Noah Johnson and Julian Dresang, Traffic Engineer

Vote – choose project to apply for Neighborhood Grant

Vote – Name Change

Papago Park Preserve Information

Tempe Neighbors Helping Neighbors – Mike Jennings, website address:

www.tempenighbors.org

Old Issues Updates

New Issues – If Any

Crime Prevention and Block Watch

Within a couple of weeks in November, there were home burglaries on Taylor and McKinley. Other nearby neighborhoods were hit too. Darlene Justus and I met with Detective Shelli Miller, Tempe Crime Prevention Officer.

Most burglaries are through unlocked gates, doors and windows. The city can provide some gate locks; so let me know if you need one. Identity theft is a growing problem. Thieves can find your information in your home, car, mailbox, and unfortunately too many other ways. There are new inexpensive cameras that send an alert via your wi-fi to a cell phone if movement is detected. I'm sure our neighbors have great ideas for keeping homes safe. Bring your ideas to the meeting and share with neighbors.

Officer Shelli Miller will be at the meeting to talk more about events in our neighborhood and how we can avoid becoming victims. We'll have sign-up sheets for Neighborhood Watch if anyone would like to attend a future meeting to get more information and hopefully participate in that program. Neighborhood watch is not nosy neighbors. It is aware and alert neighbors willing to report unusual or suspicious behavior to police. It means having neighbors we know and trust so we can feel more secure when away from home. It can help reduce crime in our neighborhood.

Crime Prevention website – www.tempe.gov/cpu

FYI – Graffiti Kits – Darlene, Bill and Deb have kits to clean graffiti from smooth surfaces. Call one of us if you find graffiti. It only works on smooth surfaces.

Neighborhood Association Name Change

City of Tempe lists our neighborhood as NIB, NTNA College NA. In Nextdoor.com we are set up as Papago Park View. In November, attending neighbors decided it was time to change the name to match Nextdoor.com. According to the city, this must be voted after notice to the entire neighborhood. Please join the meeting to help decide our name.

Maryanne Corder Neighborhood Grant Application

Each year, the city budgets \$150,000 for the Maryanne Corder Neighborhood Grant program and registered neighborhoods can apply for up to \$10,000 for capital improvement(s) that benefit and enhance the entire neighborhood. More information is available on the City of Tempe website at www.tempe.gov/neighborhoodgrants Some ideas discussed by neighborhood residents so far include bus stop improvement and communication boards in Evelyn Hallman Park. Shade structures are very expensive, but possibly shade trees could be planted. At the January 23 meeting we'll vote on ideas to move forward into the application process. Depending on our vote, we'll need to work with others in the neighborhood and city for approvals before the application is submitted. Application receipt deadline is April 4, 5pm.

Save the date:

2016 State of the Neighborhoods Awards and Workshops – Saturday morning, April 16, Tempe History Museum, 809 E. Southern Ave.

More information as it becomes available at www.tempe.gov/stateoftheneighborhoods

Thanks

- *Thanks to Darlene Justus for all that she does for our neighborhood and for all of North Tempe.*
- *Thank you to Elizabeth Thomas and Shauna Warner for helping with the mailing and all of my questions.*
- *Thank you Detective Shelli Miller, Commander Noah Johnson, and Pete Smith for helping me put this meeting together.*

Sign UP Opportunities at the January Meeting

Neighborhood Block Watch is looking for captains and participants for each block in the neighborhood. Sign up if you are considering it.

Nextdoor.com or other Setup Help? - Eighty-One of our neighbors are on Nextdoor, representing 70 households. If I can help anyone, I'll have a sign up sheet or call Deb 480-496-9551

How should we Contact You? - Some like email, others like phone calls or texts, and others prefer Nextdoor.com. Provide some contact information and we can organize a phone tree, add you to our email list or provide training for Nextdoor.

Papago Park Preserve Support

Cocoa around the Campfire – Pot Luck Picnic and optional neighborhood campout in Evelyn Hallman Park

Adopt a Path - The city has a program for maintaining paths. Sign up for clean-up of the crosscut canal path between the Evelyn Hallman Park and McDowell Rd.

Thank You,
Your Neighborhood Facilitators

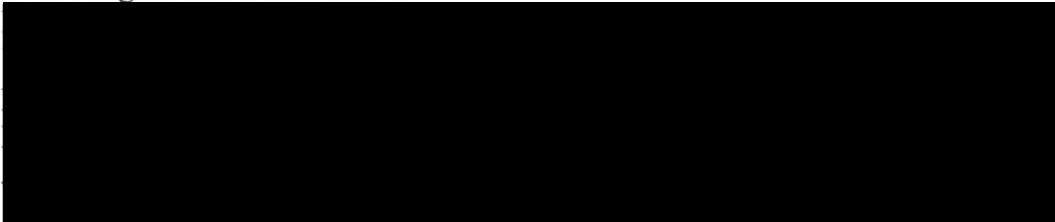

Papago Park View Neighborhood Association – General Meeting

MINUTES

01/23/16

3:00 PM

EISENDRATH HOUSE MEETING ROOM

FACILITATORS

Deb Gain-Braley and/or Gina Barriga

NOTE TAKER

Wanda

ATTENDEES

Per separate list in binder

10 MINS

SIGN IN AND INTRODUCTIONS, APPROVE PRIOR MINUTES, ASK FOR ANY ADDITIONAL AGENDA ITEMS

DISCUSSION

Several new people due to mailing.

20 MINS

CRIME PREVENTION AND BLOCK WATCH

3:10

DISCUSSION

Brief discussion of block watch. It is done by block and we need 2 or 3 homes per block to sign up. PD has gate locks available for those who may need them. Deb, Darlene and Bill have graffiti kits. We've seen increased graffiti in the area.

CONCLUSIONS

Neighbors were asked to sign up to indicate interest. We will set up meetings as we have enough interest in each block.

ACTION ITEMS

PERSON RESPONSIBLE

DEADLINE

Sign up.

20 MINS

COMANDER NOAH JOHNSON & JULIAN DRESAND, TRAFFIC ENGINEER -SPEEDING & TRAFFIC

3:30

DISCUSSION

Transport trucks, semi's, auto dealer test drives, and speeders, cut through drivers when Scottsdale traffic is bad. PD asked if we can get company names. They will talk to companies, and auto dealerships to get them to slow down. Ticket can hurt sale. Tempe Traffic will check bike lane direction arrows. Discussed dead end at McKellips. Consider better signage.

CONCLUSIONS

They will increase patrols on College especially. Traffic will look at Bike arrows, McKellips dead end and review area for ways to address traffic. Speed bumps, circles and other calming can be done via grant program. \$10K will buy 3 bumps or 1 circle. Need approval of 75% of affected drivers.

ACTION ITEMS

PERSON RESPONSIBLE

DEADLINE

BOTH PPVNA AND TRAFFIC DEPT WILL DO RESEARCH

30 MINS

DESCRIBE GRANT PROGRAM, SOLICIT NOMINATIONS, VOTE

3:50

DISCUSSION

Discussed options. Vote ranking was #1 Traffic Calming, 2-Evelyn Hallman Signs, 3-Neighborhood Signs, 4- Artwork – Alternative Bus stop shade, 5- Solar Lighting, 6 – Trees, 7- Evelyn Hallman Bike Path Stairs up to SRP Canal.

CONCLUSIONS

Do research on options based on above vote. Come back for second vote.

10 MINS

NAME CHANGE NOMINATION AND VOTE

4:20

DISCUSSION

THERE HAS BEEN CONFUSION BECAUSE OF COLLEGE SOUTH OF ASU. ALSO, NEXTDOOR HAS OUR NAME AS PAPAGO PARK VIEW. NO OTHER ALTERNATIVES WERE PROPOSED.

CONCLUSIONS

Approved Name Change to Papago Park View Neighborhood Association

ACTION ITEMS

PERSON RESPONSIBLE

DEADLINE

Deb

Notify City

15 MINS

PAPAGO PARK PRESERVE

4:30

DISCUSSION

1100 + Signatures delivered to City Council. Still working on next steps. In recent past two different developments were being discussed, a hotel and expensive homes on Papago Park.

15 MIN

TEMPE NEIGHBORS HELPING NEIGHBORS – MIKE JENNINGS

4:45

DISCUSSION

They encourage volunteers. They also offer services, and handed out fliers. Rides, yard work, small household jobs etc. They have a membership fee, but some scholarships are available.
NEXT MEETING – 2/27

1/2 Page Post

Card Mailed by Neighborhood Services



Papago Park View
Neighborhood Association

IMPORTANT MEETING

February 27, 3pm to 5pm
Eisendrath House Meeting Room - 1400 N. College

Please attend to vote again on the possible Grant Application.

Maryanne Corder Neighborhood Grant is a program where registered neighborhoods can apply for up to \$10,000 for capital improvement(s) that benefit and enhance the entire neighborhood. www.tempe.gov/neighborhoodgrants

In January, our neighborhood voted:

- 1st place: Traffic Calming
- 2nd place: Evelyn Hallman Park Communication Signage
- 3rd place: Neighborhood signs that top our street signs with our neighborhood name

Traffic calming can be a traffic circle, or 3 speed bumps, but each requires approval by 75% of effected homes. Please attend to vote on location and type of traffic calming.

We will also vote to have a "plan B", in case we cannot get required information, approvals and signatures in time for the application deadline.

If you have questions or need a ride, please feel free to call Deb Gain-Braley at [REDACTED]

Our name changed to Papago Park View Neighborhood Association (formerly College NA-change voted 1/23/16)

Association Borders – Scottsdale Rd to College, McKellips Rd to Continental

Papago Park View NA – General Meeting

MINUTES

02/27/16

3:00 PM

EISENDRATH HOUSE MEETING ROOM

TYPE OF MEETING General Meeting – Card notice sent by City of Tempe
 FACILITATORS Deb Gain-Braley
 NOTE TAKER Wanda
 ATTENDEES Richard Sederstrom, Carol Sederstrom, Halima Alshehi, Darlene Justus, Rich Gilbert, Pattie Gilbert, Wanda Majeski, Shannon Dutton, Betty Ackworth, Tim McLaughlin, Bruce Braley, Deb Gain-Braley, Kolby Granville visiting, Barbara Sherman visiting.

Agenda topics

15 MINUTES	SIGN IN AND INTRODUCTIONS, APPROVE PRIOR MINUTES, ASK FOR ANY ADDITIONAL AGENDA ITEMS	
CONCLUSIONS	January Minutes Approved	
30 MONS	GRANT PROGRAM-DISCUSS OPTIONS – VOTE TO APPROVE FINAL TARGETS	
DISCUSSION	No one volunteered to have speed bumps on their street. Discussed traffic circle cannot be planned for Filmore until flooding of homes at east end is resolved. Bruce moved to have traffic calming delayed for more study and possible next year grant submission and move items 2 & 3 (park signs and street signs with neighborhood name) up to this year. Kolby stated we need to do two separate grant applications, indicating preference order. Vote for motion was passed by majority. Darlene, Shannon and Deb volunteered to meet with Parks about signs. There was some discussion about meeting with Parks and inviting Kim and or others from Canal Park. Some discussion about Grant request writing volunteer.	
CONCLUSIONS	Voted to submit for #1 Park signs and #2 street signs with neighborhood name. Traffic calming tabled for more research and time.	
ACTION ITEMS	PERSON RESPONSIBLE	DEADLINE
Write up 2 Grant Requests	Deb with do writing with help of Darlene and Shannon.	
20 MINUTES	PLAN FOR 3/26 MEETING AND POTLUCK OR REFRESHMENTS. SET TIME. CAMPING DECISION INCLUDE OTHERS, ETC.	
DISCUSSION	Discussed options	
CONCLUSIONS	1 st event, will be our neighborhood only. Potluck starting at 5 pm with option to camp. Deb has Ramada permit and will work on camping permit.	
ACTION ITEMS	PERSON RESPONSIBLE	DEADLINE
CAMPING PERMIT Fliers	Deb will apply for camping permit and print fliers. Others will help with passing out fliers.	
10 MINUTES	UPDATE BLOCK WATCH & PATH ADOPTION – SET DATE	
DISCUSSION	We do not have enough volunteers on any one street. Just one or two on a few streets. They want two or three per street to allow coverage along the entire block. Most of our blocks are pretty long. Path is available from EH Park to McDowell. Fairly Flat.	
CONCLUSIONS	Continue to ask about Block Watch sign up sheets at each meeting. Apply to adopt the path from EH Park to McDowell – possible clean up 4/2?	
ACTION ITEMS	PERSON RESPONSIBLE	DEADLINE
Apply for path	Deb	
10 MINUTES	PAPAGO PARK STATUS	
DISCUSSION	Darlene and Barbara discussed status. Would like to get Papago Preserve onto November Ballot so it gets voter protection. April 7 the city will have on IRS/Work study session agenda. Individuals may want to attend this meeting and sign up to speak about importance of park.	
10 MONS	SET DATE FOR ELECTIONS AND APPROVAL OF BYLAWS	
DISCUSSION	March is a year since our last elections. According to the new city guidelines we should have an election soon. Deb expressed wish to use the Canal Park Bylaws as starting point for ours. Motion to have elections and Bylaws approved at April Meeting if we can coordinate with city (if they need to attend).	
CONCLUSIONS	Approved to have elections and bylaws approval in April.	
ACTION ITEMS		
Work w City and Ask Canal Park for copy of Bylaws	Deb	
10MIN	OTHER ISSUES	
DISCUSSION	Barbara asked if anyone wanted to be included in aviation issues for North Tempe. She circulated a sign up sheet. There is Graffiti at Womens Park on the Concrete – Deb will submit Tempe 311 application item.	

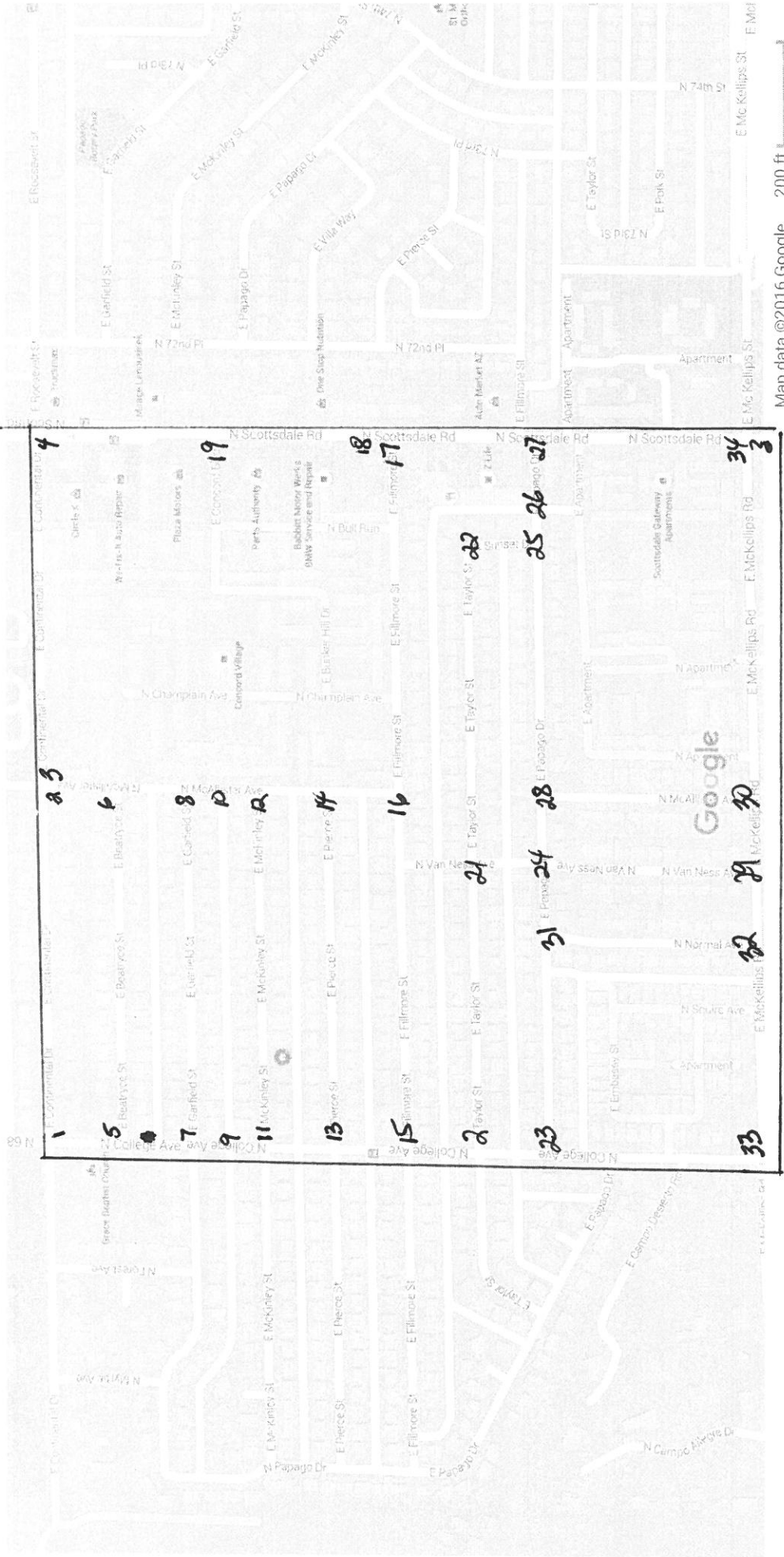

36 signs - allows for a couple extra's
 approx 423 homes, not incl appts + townhomes.
 we have members in appts ~~but~~ but
 they don't get mailings. We post to
 their facilities though. (Both appts + TH)

$36 \times 54 = 1,944.00$

Plot
 Map
 or
 Site
 Plan

Quote

All Search

Search Mail Switch View Home Mail

Compose

Calendar Home Mail Switch View Home Mail

Inbox (9999+)

Papago Park View Neighborhood Assoc Grant Application (17)

People

- barbara sherman** Deb: I thought I understood from Darlene J that Oliver had retired. E Mar 2 at 4:17 PM
- Deb Gain-Brale** Hi, hope your day is going well. After a couple of months of investiga Mar 2 at 4:46 PM
- Deb Gain-Brale** Thanks Barbara, you are right. I remember her saying that now. Deb Mar 2 at 4:54 PM
- d_justus@cox.net** Deb, May I suggest that you contact Kevin Moore. He crafted the E Mar 3 at 8:14 AM
- Deb Gain-Brale** Keven Moore said we should call Julie Wolf at Thinking Caps. I've le Mar 3 at 4:50 PM
- Deb Gain-Brale** Hi, hope your day is going well. After a couple of months of investiga Mar 25 at 8:03 AM
- Horstman, Steven** I'll check into this and see if our sign shop can get you a quote on r Mar 28 at 7:53 AM
- Dresang, Julian** Hi Deb, Are you just looking at the cost to fabricate? Or fabrication ar Mar 28 at 8:24 AM
- Deb Gain-Brale** If we are allowed to install ourselves, we are ok doing it. If the city ne Mar 28 at 9:22 AM
- Dresang, Julian** Thanks Deb, The signs would need to be installed by the City or by a Mar 28 at 9:48 AM
- Deb Gain-Brale** Ok, Thanks. Please can you quote the install too then. I appreciate y Mar 28 at 12:18 PM
- Horstman, Steven** <Steven_Horstman@tempe.gov> Mar 30 at 12:59 PM
To 'Deb Gain-Brale'
CC Warner, Shauna, Thomas, Elizabeth, Dresang, Julian

Deb, the Tempe sign shop charges a flat cost of \$54 per sign that includes fabrication and installation. It sounds like you don't need an actual quote from the sign shop to include in your grant application. Shauna Warner and Elizabeth Thomas in Neighborhood Services are both familiar with this process and should be able to help you with any questions you might have about completing and submitting the application.

Thanks,
Steve Horstman

> Show original message

Reply, Reply All or Forward | More

- Deb Gain-Brale** Thank you very much! Deb Gain-Brale [REDACTED] Mar 30 at 2:02 PM
- Thomas, Elizabeth** Hi Deb, Documentation of # of signs needed (add in 2-4 for good r Mar 30 at 3:45 PM
- Deb Gain-Brale** Thank you Deb Gain-Brale [REDACTED] Mar 30 at 5:33 PM

Click to Reply, Reply All or Forward

Send [Rich Text Editor Icons]



Quote
← For Signs
City makes
and installs
for \$54 ea.



LittleBirths
Curling their fingers in the baby's room. I then...