

PROJECT NARRATIVE

In the space provided below, please describe specifically how the City of Tempe’s funds will be used:

The City of Tempe funds will be used to compensate the artist for the design, preparation, creation, transportation, collaborative process, taxes, insurance, and installation of art work in the median south of the intersection of Southern Ave. and Hardy Dr. [Attachment 6]

The neighborhood and neighboring HOA voted on “Cotton Clouds” by Lucy Erb as their favorite design. Depending on the cost of materials, transportation, etc. the design will be modified to fit the budget of \$10,000. For example, Lucy has already determined through discussions with Greg Brockman of Magnum Companies (Magnum Engineering, Inc.), that her original design must be modified to consist of one sculpture in one median, as opposed to two sculptures in both medians as originally envisioned. Additionally, other modifications may be mad depending on budget. For example, if the budget permits, instead of the “clouds” consisting of curved 2-dimensional pieces of metal, the “clouds” could be made of 3-dimensional bulbous shapes.

PROJECT BUDGET

Expenses	Amount
Project Materials, Engineering, Fabrication, Installation	\$7,000
Artist Design Fee	\$1,500
On Site Operations Management	\$500
Contingency	\$1,000
TOTAL EXPENSES:	\$ 10,000

City Funds Requested: \$10,000.00
 (amount should equal one of the included bids)

Dollars per household: \$12.76
 (funds requested divided by # of households)

Match from Association: \$0.00
 (Must be at least ½ of total project cost for HOA’s/apts.)

Total project cost: \$10,000.00
 (amount should equal one of the included bids)

1. Please describe how this project meets each of the guidelines listed:

A. Improves health and safety of residents:

N/A

B. Benefits a significant number of residents and/or the City at large:

This public art piece will benefit many people: the residents of the Southern Palms Neighborhood Association, the residents of the Southern Village Estates HOA, and the City at large via individuals who travel on Hardy Drive and individuals who use the public transit stop at Hardy and Southern.

C. Addresses a known neighborhood deficiency:

As a “new” re-activated neighborhood association, our neighborhood lacks a sense of community identity and knowledge of our history. From what we have gleaned from original and long-time residents, our neighborhood used to be cotton fields. The chosen art piece will foster a sense of neighborhood identity and harken back to our neighborhood’s history when we were cotton fields.

D. Complements other neighborhood projects (private or City):

The public artwork will build on other public art pieces in the surrounding area, such as Melissa Martinez’s Streetscaping Project on Hardy Dr.

E. Provides an environmental benefit, such as water and/or energy conservation:

Depending on the time of day, the public artwork would provide some additional shade for pedestrians using that median as a crosswalk.

F. Enhances the aesthetics of the neighborhood:

The artwork at Hardy Dr. and Southern Ave. will be aesthetically pleasing. The metals used to form the artwork will add light and contrast to that median. Additionally, the shapes cut out of the metal will cast interesting shadows on the sidewalk below that will change as the day progresses and the sun moves through the sky.

G. Accessible to all members of the community:

The potential location for the artwork (south of the intersection of Southern Ave. and Hardy Dr.) is extremely accessible to members of the community because it sits on a road where almost all residents of the community travel through on a daily basis. Since our neighborhood spans from east to west of Hardy Dr., it was important for us to select a potential location that would enhance aesthetics for residents living on both sides of Hardy Dr.

2. Describe how members of the community have been directly involved in the development of the project.

The artwork project was the brainchild of one of our neighbors, Susan Bendix. From our very first official meeting as a neighborhood, when we elected our officers, the neighbors began to informally discuss ideas they would like for the grant proposal, as documented in our minutes [Attachment 1]. Multiple emails, mailers, Facebook posts, and website posts encouraged neighbors to research and present ideas for the grant proposal [Attachment 2]. In February 2016, the neighborhood met to vote on which idea would be the subject of our grant proposal [Attachment 3]. Susan’s idea for public art was presented and was the neighborhood’s favorite idea. From that point, Mia, the Southern Palms NA President, and other neighbors worked together to take photographs, measurements, and speak to City officials in order to publish the neighborhood’s “Call to Artists.” Subsequently, the neighborhood held another meeting in March 2016 to view artist designs, ask questions of the artists, and vote on favorite designs [Attachment 3]; [Artist Submissions, Attachments 4 and 5]. The voting and designs were also available online and we received the majority of votes through email and comments on the website. Our neighbors and the neighboring HOA ultimately voted on “Cotton Clouds” by Lucy Erb as the favorite art design.

3. Grant funds can only be used for the capital improvement project, not maintenance. Please describe specifically how the association intends to maintain the project if funded.

The designs submitted for the artwork took into consideration maintenance. The artist chose uncolored metal to reduce any need for maintenance. For all intents and purposes, the artwork will not require maintenance. In the event that maintenance is required, the neighborhood will organize an event to maintain the artwork (e.g., cleaning). However, if any potential maintenance issues arise that require professional services, the neighborhood will raise funds through individual donations.

4. If your association has previously received grant funds, please share how they have impacted your neighborhood.

To our knowledge, the Southern Palms NA has not previously received grant funds.

5. Outside of grant projects, please describe any other activities your association has participated in (i.e. GAIN, Adopt-A-Park, food drives, etc.) within the past year.

Our neighborhood reactivated in May 2015. Since then, we hosted a GAIN party/potluck in Dwight Park. We also organized a community yard sale in October 2015 with multiple households participating. One of our neighbors also led a project for a public mural in Dwight Park. Our neighbors collectively donated over \$500 to fund the cost of paint, supplies, and professional pressure washing. The labor and design are donated by neighbors. All of the neighbors were given the opportunity to vote on 1 of 3 designs, which were posted on our website. That project is currently ongoing. The wall for the mural has already been washed and neighborhood volunteers applied primer. The actual painting is set to begin within the next few days.

6. What is your proposed timeline for the grant project?

August 2016: Design finalized

October 2016: Materials purchased, metal laser cut

February 2016: Installation

Southern Palms Neighborhood Association

connecting neighbors and building community

Hello world!

This is the first post from the Southern Palms Neighborhood Association. Earlier this week, we held a meeting. It was great to meet the neighbors who attended. The minutes of the meeting are posted below. If you would like to be involved in the association and/or join our mailing list, please contact Mia at [REDACTED].

Minutes, 5/19/15

To summarize actions from last night:

- o Neighbor introductions and sign-in
- o Mia Nguyen and Lillie Mayfield unanimously elected to chair and vice-chair
- o Boundaries of the neighborhood association chosen: Kyrene to Priest, Southern to US 60 (minus the existing HOAs within the area)
- o Name for neighborhood association: Southern Palms

Topics that surfaced last night for future meetings/discussion:

- o Traffic (particularly speeds on Hardy)
- o Lighting (both more and less depending on resident)
- o Weeds/yard maintenance
- o Dog park as possible future grant project
- o Public art installation in median of Hardy Dr. as possible future grant project
- o The possibility of installing murals on the walls that surround Dwight Park
- o Other groups that are working on improvement projects for Dwight Park (such as ADA accessibility)

- o Neighbors expressed interest in organizing a potluck for the next meeting
- o The possibility of sending out a newsletter before July 1, 2015
- o Neighbors expressed interest in having our community police officer attend the next meeting

Occasionally some of your visitors may see an advertisement here
Occasionally, some of your visitors may see an advertisement here.
You can hide these ads completely by upgrading to one of our paid plans.

[UPGRADE NOW \(HTTP://WORDPRESS.COM/REMOVE-ADS/?UTM_CAMPAIGN=REMOVEADSNOTICE\)](http://wordpress.com/upgrade) [DISMISS](#)

MESSAGE

May 20, 2015 *May 21, 2015* · *mia629* · *Leave a comment* ·

Blog at WordPress.com. | The Illustratr Theme.



Hello everyone!

You are receiving this email as part of the **Southern Palms** Neighborhood Association mailing list. It was great to meet everyone the other night and I'm very much looking forward to working together for our community. Thanks to everyone who came out and everyone who could not make it but expressed interest in being involved.

Attached are materials that Laura sent us, to help us get a better idea of the City of Tempe grant program. Please start brainstorming ideas for a project we could do. People already expressed great ideas for: public art installation in the Hardy median, murals in Dwight Park, a dog park, and more. Completing our application for this grant will be my primary goal in the upcoming months.

There is also a neighborhood survey attached, or you can fill it out online: [Neighborhood Survey](#). It's easy and should take less than 2 minutes.

Some people had mentioned having a public website, in addition to our [Facebook group](#) (for those who don't have Facebook accounts), so I created this simple website to post updates and keep records of our minutes: <https://southernpalms.wordpress.com/>. I'm not very tech-savvy, but I will be adding more as we go along.

We are also working on a newsletter to send out over the summer. If you have ideas for information to include, please drop me a line! We will most likely announce our next meeting in that newsletter as well.

Southern Palms Neighborhood Newsletter

June 2015
Volume 1, Issue 1

Chair, Mia Nguyen
Vice-Chair, Lillie Mayfield



News and Updates



Double rainbow over the neighborhood on June 4, 2015. Photo courtesy of Julio Castro.

Upcoming Events

- ◆ Southern Palms Neighborhood Association Meeting in Aug/Sept with our community police officer - date, time, location coming soon
- ◆ G.A.I.N. (Getting Arizona Involved in Neighborhoods) block party on Saturday, October 17 at Dwight Park - more info coming soon!

At our last meeting and in our Facebook group, we brainstormed a lot of great ideas for projects for our grant proposal to the City of Tempe. The ideas included public art in the median of Hardy, a tree or shade structure over the bus stop on Hardy, a dog park, a mural in Dwight Park and more. We will be holding another meeting in the fall to vote on which project will be featured in our neighborhood grant proposal.

If you are interested in presenting your project idea at the fall

Public Art Mural Project

We have been discussing in our neighborhood Facebook group the possibility of installing a mural in Dwight Park.

Public murals serve the dual purpose of instilling neighborhood pride and also deterring graffiti. One example is the beautiful 153-foot mural on Hardy, north of University Drive, painted by local artist, Lauren Lee.

Jackie, one of our lovely neighbors, is also an artist and has volunteered to paint the mural for us, if we can all raise the funds for the cost of paint.

We are currently working with

meeting, please contact me (Mia) to coordinate. Unfortunately, I do not have enough time to research the cost and feasibility of each idea on my own, so I will need your help if you would like your idea to be "in the running" for our grant proposal.

Laura, from the City of Tempe, sent us a helpful packet of the information we need for our grant proposal. If you need a copy, please email me at: mia.nguyen629@gmail.com.



Three Birds mural, photo courtesy of Lauren Lee Fine Art

the City of Tempe to obtain the proper permissions and permits.

In the meantime, we should start brainstorming ways to raise the money for the paint. If you have any connections that would allow us to purchase paint at a discount or below retail cost, please let us know!



Hello neighbors!

A big Welcome to our neighbors who recently joined our mailing list.

***Mural Project:** the neighbors voted and the coyote design won by a landslide! Much thanks to Kay and the other owners of the house for letting us paint on their wall. Our next step is to raise the funds to professionally wash the wall and purchase painting supplies (primer, brushes, paint, sealant). To donate, click here: <https://www.youcaring.com/southern-palms-neighborhood-464143> If everyone donated \$5 or so, we'd get this thing funded in no time! The artist, Jackie Beck, and I will post all expenses on our neighborhood website so you can keep track of exactly where the funds are going.

***Neighborhood Grant Proposal:** our neighborhood grant proposal is due in April 2016. The basic details are that we could possibly receive up to \$10,000 from the City for a [neighborhood improvement project](#) if our grant proposal is approved. We've had some great ideas from neighbors so far. If you have an idea you would like to be "in the running" for our grant proposal, then please put together a cost estimate, including an itemized bid from a contractor (or two). We will have neighbors present their ideas and cost estimates at our next neighborhood meeting in January. Then the neighbors can vote on which project we would like to feature in our grant proposal. Ideas I have heard so far are: public art in the median on Hardy, shade structure for bus stops on Hardy, signage, dog run...



Mia Pie ▸ **Southern Palms Neighborhood**



March 31, 2015 ·

Hi everyone, thanks for joining our neighborhood FB group. This group is for posting local news, events, questions, whatever! We are in the process of starting up a neighborhood association, and some of our primary goals are obtaining grants/funding to improve our neighborhood. If you are interested in helping out or have any ideas for improvements, please let me know.

Like

Comment

3

[View 10 more comments](#)



Mike Galwey I passed out candy on W Riviera last night. Probably only had around 10 kids around collecting. Had my lights on and a nice lit pumpkin out. It's just not worth going all out decorating when that's all I get every year.

November 1, 2015 at 4:09pm · [Like](#)



Mia Pie that's too bad you didn't get many kids in your area, I must have gotten over 100 on Manhattan!

November 1, 2015 at 4:34pm · [Like](#) · 1



Cheryl Doebler Riviera is a difficult one, I think, because it's a darker cul de sac, and it's right on Hardy... Kinda scary for me, I think

November 1, 2015 at 5:16pm · [Like](#)



Mia Pie uploaded a file in the group: **Southern Palms Neighborhood.**

October 30, 2015 ·

The 2016/17 Neighborhood Grants Application was just released yesterday. I've heard several ideas from neighbors, and I think the front-runners for our application are: public art for the median on Hardy; shade structure/public art for the bus stops on Hardy. If these are your ideas and you want them to be considered for our application, I'll need your help in contacting artists and getting cost proposals!



16-17 Grant Application_Revised.docx · version 1

Document

Download

Preview

Like

Comment

3

[View 5 more comments](#)



Mia Pie (this is from the application, for what we'd need to include) • Bids for project work

Minimum of two itemized bids, including appropriate permit fees and sales tax
Bids solicited from licensed, insured contractors... [See More](#)

Like · Reply · October 30, 2015 at 1:46pm · Edited



Southern Palms
Neighborhood Association
MEETING

Saturday, Feb. 6, 2016 - 10 am
Dwight Park

Come and vote on ideas for our grant proposal to the City of Tempe. Remember, we could be awarded a grant of up to \$10,000 for a neighborhood improvement project!

Anyone with an idea for a grant project should come prepared to present their idea and estimated budget with an itemized bid. Contact Mia for more details on what's needed: [REDACTED]

Visit our **website** for other updates: <https://southernpalms.wordpress.com/>

Donate to our neighborhood **mural** in the park: <https://www.youcaring.com/southern-palms-neighborhood-464143>
(we're more than halfway there!)



Southern Palms
Neighborhood Association
MEETING

Saturday, Feb. 6, 2016 - 10 am
Dwight Park

Come and vote on ideas for our grant proposal to the City of Tempe. Remember, we could be awarded a grant of up to \$10,000 for a neighborhood improvement project!

Anyone with an idea for a grant project should come prepared to present their idea and estimated budget with an itemized bid. Contact Mia for more details on what's needed: [REDACTED]

Visit our **website** for other updates: <https://southernpalms.wordpress.com/>

Donate to our neighborhood **mural** in the park: <https://www.youcaring.com/southern-palms-neighborhood-464143>
(we're more than halfway there!)



Southern Palms
Neighborhood Association
MEETING

Saturday, Feb. 6, 2016 - 10 am
Dwight Park

Come and vote on ideas for our grant proposal to the City of Tempe. Remember, we could be awarded a grant of up to \$10,000 for a neighborhood improvement project!

Anyone with an idea for a grant project should come prepared to present their idea and estimated budget with an itemized bid. Contact Mia for more details on what's needed: [REDACTED]

Visit our **website** for other updates: <https://southernpalms.wordpress.com/>

Donate to our neighborhood **mural** in the park: <https://www.youcaring.com/southern-palms-neighborhood-464143>
(we're more than halfway there!)



Southern Palms
Neighborhood Association
MEETING

Saturday, Feb. 6, 2016 - 10 am
Dwight Park

Come and vote on ideas for our grant proposal to the City of Tempe. Remember, we could be awarded a grant of up to \$10,000 for a neighborhood improvement project!

Anyone with an idea for a grant project should come prepared to present their idea and estimated budget with an itemized bid. Contact Mia for more details on what's needed: [REDACTED]

Visit our **website** for other updates: <https://southernpalms.wordpress.com/>

Donate to our neighborhood **mural** in the park: <https://www.youcaring.com/southern-palms-neighborhood-464143>
(we're more than halfway there!)

Southern Palms Neighborhood Association

connecting neighbors and building community

2/6/16 Meeting Minutes



(https://southernpalms.wordpress.com/2016/02/10/2616-meeting-minutes/img_1351/)



(https://southernpalms.wordpress.com/2016/02/10/2616-meeting-minutes/img_1352/)



(https://southernpalms.wordpress.com/2016/02/10/2616-meeting-minutes/img_1353/)



(https://southernpalms.wordpress.com/2016/02/10/2616-meeting-minutes/img_1354/)



(https://southernpalms.wordpress.com/2016/02/10/2616-meeting-minutes/img_1355/)



(https://southernpalms.wordpress.com/2016/02/10/2616-meeting-minutes/img_1356/)

I. Grant Proposal Vote

- a. Mia presented an idea from our neighbor, Susan, to install a sculpture in the median at the intersection of Hardy and Southern.
- b. Adriana presented an idea for a community mural.
- c. The neighbors voted and the sculpture in the median will be the idea for our Grant Proposal, due in April. Our next steps will be to work with the City and get bids from artists. One of our neighbors works with metal and may submit a bid.
- d. Neighbors also contributed great ideas for next year's Grant Proposal, such as signage with the neighborhood name and a fenced off dog run in the park.

II. Dwight Park Improvements

- a. Mariam, Dillon, and Michael discussed the City's proposed improvements to the park. The City will be paving areas of the park to make it ADA accessible for those with disabilities. The City also plans to install other improvements and would like our input. To give your input, fill out this form by **February 18**: www.tempe.gov/DwightPark (<http://www.tempe.gov/DwightPark>)

III. Community Police Officers

- a. Two community police officers stopped by to answer any questions we had. One great question concerned illegal dumping in our alleys. The officers said to call the non-emergency number when you see someone illegally dumping things in the alley. They said it's not a bother, and that they want to know when these things happen. If you can get photos of who is doing the dumping or which business is doing the dumping, that's even better.
- b. Other questions concerned community safety and burglaries. One of the officers suggested using landscaping strategically to make it more difficult for someone to break into your home (like planting something thorny underneath your windows).

IV. Miscellaneous

- a. Tito brought up the burned out street lights in the neighborhood. If you notice a burned out light, please let the City know: [Tempe 311 \(http://www.tempe.gov/city-hall/communication-and-media-relations/tempe-311\)](http://www.tempe.gov/city-hall/communication-and-media-relations/tempe-311)

Or you can let SRP know directly: [SRP Streetlight Report \(https://www.srpnet.com/electric/secure/streetlightout.aspx\)](https://www.srpnet.com/electric/secure/streetlightout.aspx)

b. Jackie informed us that we have about \$200 left to raise for our neighborhood mural project! Donations accepted here: [Mural Project \(https://www.youcaring.com/southern-palms-neighborhood-464143\)](https://www.youcaring.com/southern-palms-neighborhood-464143) Big thank you to everyone who has donated so far! It's been fun to be a part of this community effort.

c. The City of Tempe is seeking honorees for its 2016 State of the Neighborhood Awards, submit any nominations by **February 16**: [Neighbor Awards \(http://www.tempe.gov/city-hall/community-development/neighborhood-services/2016-state-of-the-neighborhoods-awards-workshops\)](http://www.tempe.gov/city-hall/community-development/neighborhood-services/2016-state-of-the-neighborhoods-awards-workshops)

d. There is some confusion with the City as to which areas are part of our neighborhood association and which aren't. Mia is working with Laura from the City of Tempe to figure out who should be included in our neighborhood association and who would like to form their own association.

e. Upcoming Tree Workshop: Workshop & Tree Expo – February 27 from 9 a.m. to 12:30 p.m. at the Tempe History Museum, 809 E. Southern Avenue

On Feb. 27, local gardeners, arborists, composting experts, conservation organizations and tree lovers of all types will be at the *Tempe Urban Forestry Expo* hosting a booth or activity to showcase why trees are important to the community, how to care for them and the many benefits they provide. The workshop will be held Saturday, Feb. 27 from 9 a.m. to 12:30 p.m. at the Tempe History Museum, 809 E. Southern Ave. with the morning activities including a workshop/presentation from 9 to 10 a.m. and expo from 10 a.m. to 12:30 p.m.

Last bit of news which I forgot to mention at the meeting – the Marilyn Ann Neighborhood Association has invited us to check out their neighborhood farmers market (the Clark Park farmers market). There is free community yoga at 9 am and vendors until 1 pm every Saturday. I plan to check out the yoga and market this Saturday, Feb 13 at 9 am. If anyone can join, please let me know!

Occasionally some of your visitors may see an advertisement here
You can hide these ads completely by upgrading to one of our paid plans.

UPGRADE NOW ([HTTP://WORDPRESS.COM/REMOVE-ADS/?UTM_CAMPAIGN=REMOVEADSNOTICE](http://wordpress.com/remove-ads/?utm_campaign=removeadsnotice)) DISMISS

MESSAGE

February 10, 2016 February 10, 2016 · mia629 · Leave a comment ·

Create a free website or blog at WordPress.com. | The Illustratr Theme.

Hi neighbors!

Voting is now open. Please email me your vote by midnight on Saturday 4/2.

<https://southernpalms.wordpress.com/2016/04/01/art-vote/>

Also let me know if you have any questions, thanks!



Mia Pie

March 31 at 9:59pm · Tempe, AZ, United States

Art project VOTING is now open until midnight on Saturday (4/2). Please leave a comment with your vote or send me an email:



<https://southernpalms.wordpress.com/2016/04/01/art-vote/>

any questions? please let me know!... [See More](#)



Art Vote



SOUTHERN PALMS NEIGHBORHOOD ASSOCIATION

connecting neighbors and building community

[ABOUT](#) [CONTACT](#) [EVENTS](#) [MINUTES](#)

ART VOTE

Dear neighbors,

We are nearing the end of the grant proposal process for the Maryanne Corder Neighborhood Grant Program for the City of Tempe. Back in February we voted on the installation of a public art sculpture to be the subject of our grant proposal. We want your vote on the art piece! Below is information on the two artists and their design(s).



MAR 31 VOTE on your favorite artist and design

Event for Southern Palms Neighborhood - Hosted by Mia Pie

[Hosting](#)
[Invite](#)
[Edit](#)
...

Thursday, March 31 at 6 PM - 6:30 PM
 3 days ago

969 w hermosa dr [Show Map](#)

Dear Southern Palms Neighbors,

Thanks to the efforts of some dedicated individuals, we were able to get 2 grant proposal to install a public art sculpture.



Angie went

5	3	142
went	maybe	invited

Message Guests

March 31, 2016 Neighborhood Meeting to Vote and Speak to Artists





Samples of Metals to be Used in Lucy Erb's Artwork

"Before" Photos of the Medians South of the Intersection of Southern Ave. and Hardy Dr.



Looking northwest towards Southern Ave.





Google Earth Image

LUCY ERB

SCULPTOR

3851 E. Flower St. Gilbert AZ. 85298

lulucamilla@gmail.com

(480) 295-1761

www.lucyerb.com

LETTER OF INTENT

Over the last couple years I have gained a large interest in public art. I hope to create an inspirational experience that people of all ages and backgrounds can enjoy. I believe art can have a powerful impact on everyone, so bringing communities together through sculpture in public spaces is important to me. One of the things that I have done to help my pieces become a point of pride for a community is to make each piece site specific and play off the history and aspects of the of the site that make that location unique.

Last fall I completed a commission for the Arizona State University Health Center. Things I took into account were the architectural style and purpose of the building, the history of the area, and native plants near the site.

For the Southern Palms Neighborhood I have looked into the history of the land it was built on. From as recent as the cotton farming that happened as little as a century ago, to the hohokam culture almost a thousand years old, to the oceanic fossils that cover our desert dating back over sixty million years.

Any of the projects I propose will serve to beautify the Southern Palms Neighborhood and connect all viewers with the rich history of the area. The budget for any of the proposed pieces will not exceed \$10,000, but will need close to that full amount in order to create a safe, well crafted, piece that will bring pride to the community for years to come.

I look forward to offering my creativity to the Southern Palms community as I bring to life a piece that will bring people of all ages and backgrounds together to celebrate the identity and beauty of the Tempe southwest.

Sincerely,

Lucy Erb

CURRICULUM VITAE

Education

BFA, Sculpture, Herberger Institute for Design and the Arts, Arizona State University, Tempe AZ
(expected May 2016)

Experience

2015 ASU Metals Club Treasurer
2012 Private Art Tutor
2011 President of the Art Club

Awards/Scholarships/Honors

2015 Bollinger Atelier Scholarship to attend the 2015 International Sculpture Conference
Phoenix, Scottsdale and Tempe, AZ
2015 Arizona State University Health Center Commission
2012 Regent High Honors Scholarship
2012- Dean's List
2015

Exhibitions:

2016 *Sustenance*, Harry Wood Gallery, Tempe, AZ
Metal State of Mind, Harry Wood Gallery, Tempe, AZ
Quixotic, Gallery 100, Tempe, AZ
Li'l Bits, Stauffer Gallery B, Tempe, AZ
2015 *Drawings for Sculpture*, Harry Wood Annex, Tempe, AZ
Desert Inspiration, (solo exhibit) ASU Wellness Gallery, Tempe AZ
Mass Action an exhibition in sculpture, Unexpected Gallery, Phoenix, AZ
Emergence as part of a collaborative piece for *The Creation Project*, Secret Garden ASU
Metamorphosis, Flagstaff Wool and Fiber Festival, Flagstaff, AZ
2014 *Art-O-Sphere*, Ice House, Phoenix, AZ
Memories and Movement, ASU Map Room, Tempe, AZ
2013 *This: The Herberger Institute Showcase*, Tempe, AZ
2012 *ASU Undergraduate Juried Exhibition*, Harry Wood Annex, Tempe AZ
Higley School District Office Student Gallery, Gilbert, AZ

Commissions

2015 *Arizona State University Health Center Commission*, Permanent sculpture installation

Technical Abilities

Hanging sculpture, silversmithing, enameling, metal spinning, anodizing, welding, wood working, carving, wood turning, watercolor, knotting, acid dye, natural dye, sewing, embroidering, screen printing, felting, needle felting, knitting, basket weaving, spinning, vector graphics, waterjet cutting, CNC router cutting, CNC plasma cutting, Illustrator, Adobe Photoshop, Inkscape, and Gimp.

References available upon request



Dream Fish
Tin, Fabric, Paper
6ft. x 2ft. x 4ft.
2015



Dream Fish (detail)

Tin, Fabric, Paper

6ft. x 2ft. x 4ft.

2015

Budget: \$120 included materials and fabrication.

Location: N/A



Emergence (Collaborative project)

Steel

9x9x3 ft.

2015

Budget: \$800 included some materials.

Location: temporarily installed in The Dixie Gammage Hall Courtyard, Tempe, AZ

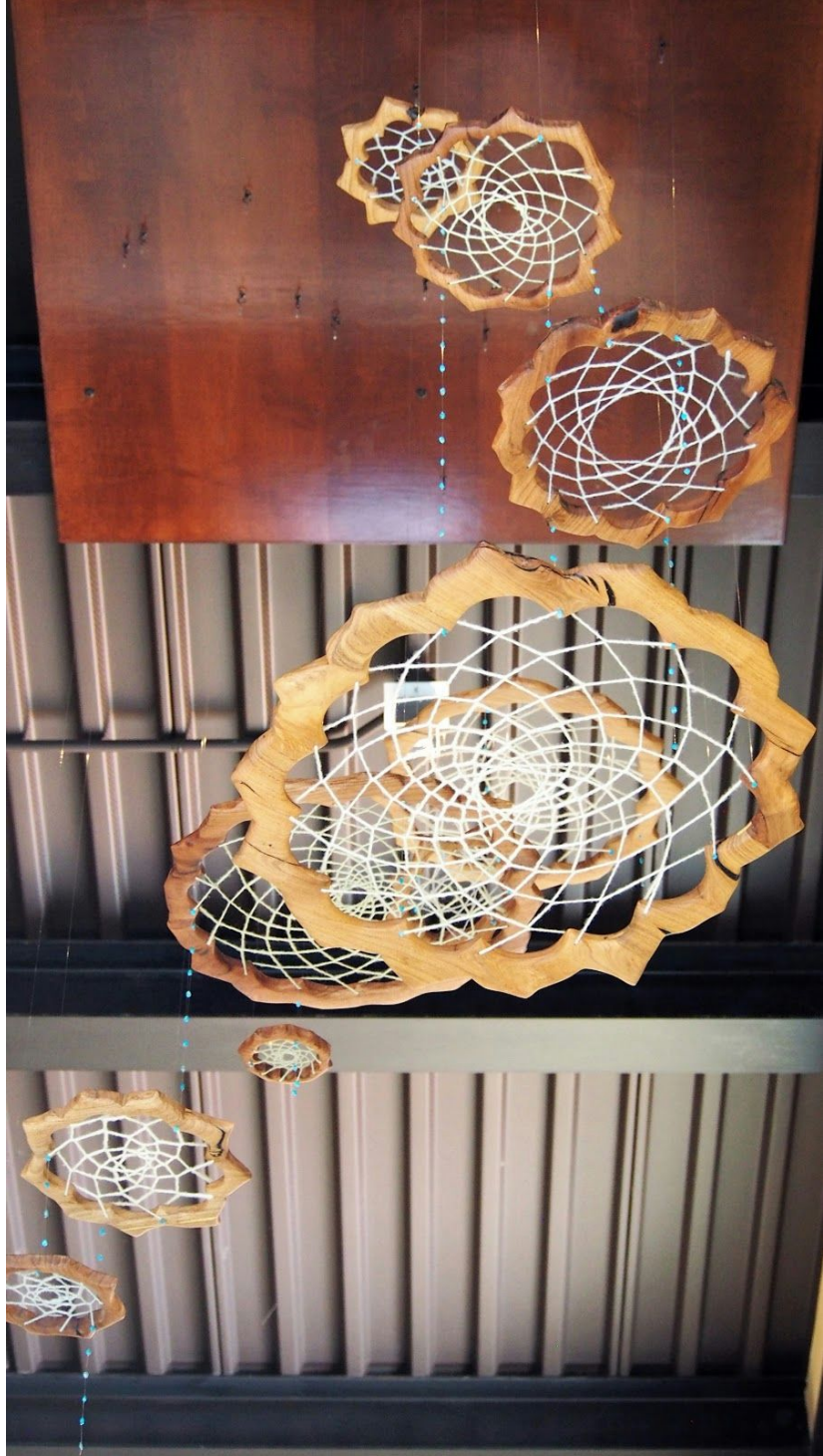

Drifting Desert Dreams

Local Mesquite Wood, Handspun Yarn, Sleeping Beauty Turquoise

6x3x6 ft.

2015

ASU Wellness Collection Commission



Drifting Desert Dreams

Local Mesquite Wood, Handspun Yarn, Sleeping Beauty Turquoise

6x3x6 ft.

2015

ASU Wellness Collection Commission

Budget: \$2,000 included materials and artist design.

Location: Arizona State University Health Center, Tempe, AZ

Cotton Clouds

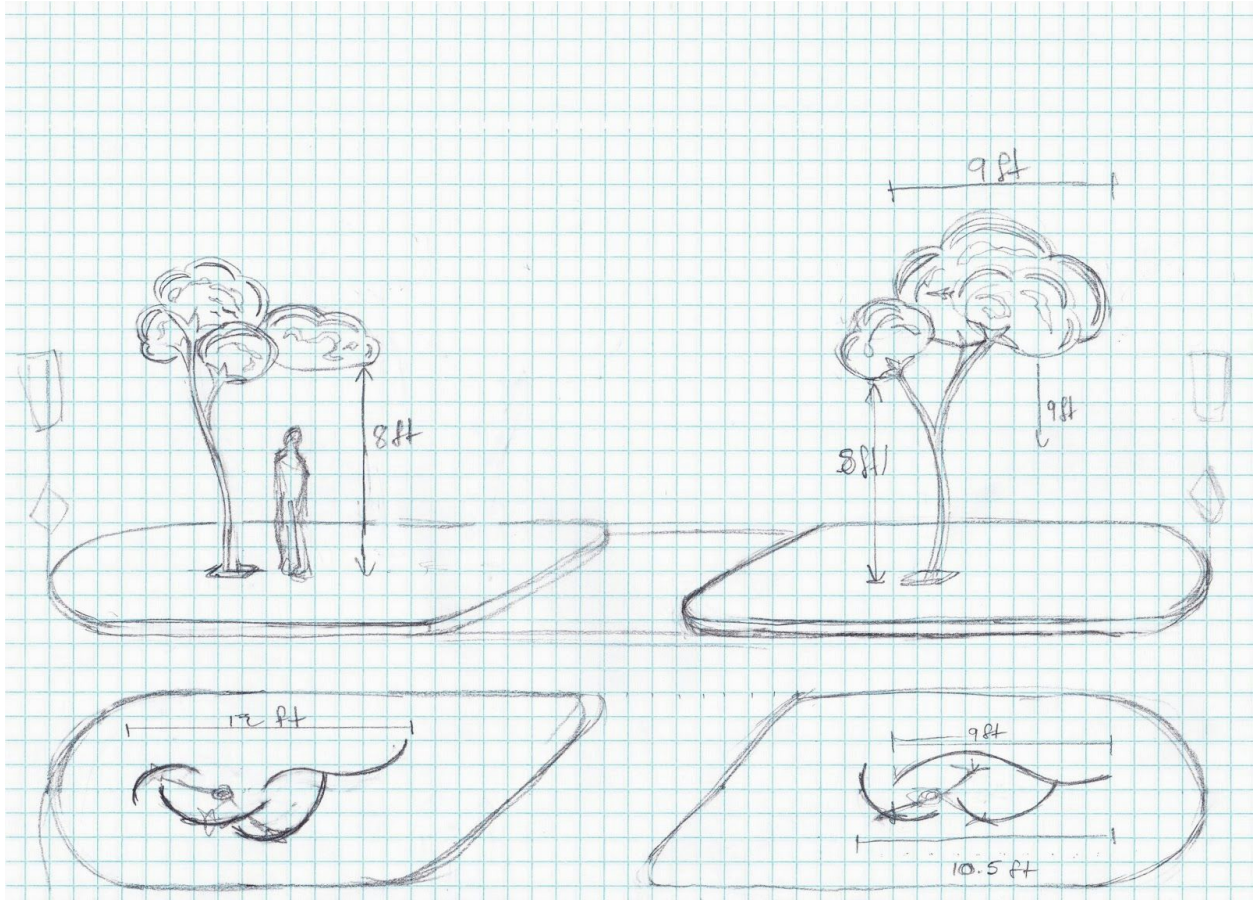

One of Arizona’s greatest beauties is it’s sunsets. For us that call this place home these masterpieces have become more common than the cotton fields that used to cover the valley. A long time ago the Southern Palms Neighborhood was a field of soft white cotton ready for harvest. “Cotton Clouds” draws on these two elements that have given our desert its identity.



Once We Were an Ocean

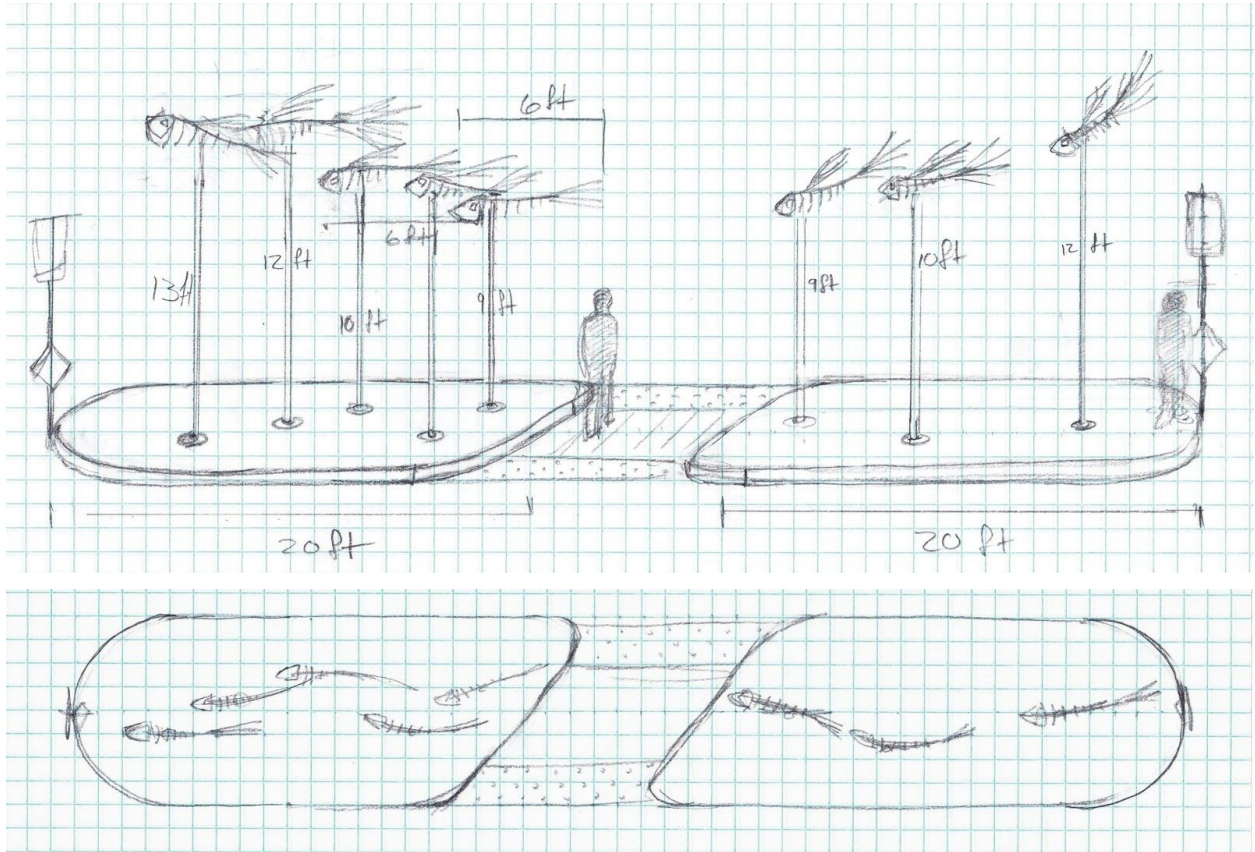

In the blistering summer as we stand in 117 degrees we would give anything to even think about the cool waters of the ocean. It seems so far away, yet it may not be as far as you think. Fossils show that over 60 million years ago the ground we stand on in Tempe was a lively tropical sea. "Once We Were an Ocean" brings the fish that once ruled this area back to life to swim with us in the sunshine.



March 2016

Dear Southern Palms Neighborhood Association,

I am a long time resident of the Southern Palms Neighborhood. I am interested in submitting a design for the artwork at Southern Ave. and Hardy Dr. because I am a metalsmith artist and I love the idea of bringing public art to enhance the beauty of our neighborhood. I have worked extensively with metals and other materials. I could complete the work for an estimated budget of \$10,000 to include design, preparation, and installation of the art in the median.

Attached are my resume and images of my work. I have also attached a potential design for the artwork.

Thank you,

Mary Chuduk



MARY CHUDUK
ARTIST RESUME

EDUCATION

MFA from Northern Illinois University, DeKalb, Illinois; BA cum laude from Illinois State University, Normal, Illinois and University of Grenoble, France; post graduate work, Arizona State University.

SELECTED EXHIBITIONS

- 2016 Metals State of Mind (invitational) Ariona State University, Tempe, Arizona
2015 Little Dreams in Glass and Metal: Enameling in America, 1920 to the Present Fuller Museum of Craft, Brockton, Massachusetts
2015 Alchemy 3, Worcester Center for Crafts, Worcester, MA
2015 Forged by Fire (invitational) Figureworks Gallery, Brooklyn, NY
2014 Liturgical Work, Our Lady of Mount Carmel Church, Tempe AZ
2014 Points of Departure, MICA Jewelry Center, Baltimore MD
2013 Alchemy 2, Carnegie Museum, Covington, Kentucky
2013 SOLO exhibition Veiled Gallery Dam, Seoul, Korea
2012 Screenplay (Juror's Award) East Carolina Univ. Greenville, NC
2012 The Spiritual Show A Jewelers Art Gallery, Oklahoma City, OK (Juror's Award)
2012 Small Treasures 2 Crafthaus online exhibition
2012 30th Enameling Exhibition of Korean Enamel Association (invitational) Seoul, Korea
2012 Harold Balazs and Friends (invitational) Art Spirit Gallery, Coeur d'Alene, Idaho
2012 Crucible (invitational) Mesa, AZ in conjunction with Society of North American Goldsmiths Conference
2012 33rd Annual Contemporary Crafts, Mesa Arts Center, Arizona
2011 Alchemy, Enamelist Society Biennial, Gatlinburg, Tennessee (First Place Award)
2010 Liturgical Work, Our Lady of Mount Carmel Church, Tempe AZ
2009 Decorative Resurgence, Rowan University Gallery, Glassboro, NJ
2009 Surfacing, Enamelist Society Biennial, Oakland, California
2009 Delicate Beauty, Penland Gallery, North Carolina (invitational)
2009 Materials Hard and Soft, Denton Arts Center, Texas
2009 30th Contemporary Craft Exhibition, Mesa Contemporary Arts, Arizona
2008 Craft USA, (Juror's Award) Silvermine Art Center, Connecticut
2008 Personal Places/ Public Spaces, (invitational) Mesa Contemporary Arts, Arizona
2008 Off the Table, (invitational) Arizona Museum for Youth, Mesa, Arizona
2007 Trio Exhibition of Enamel Artists, Artspace Gallery, Seoul, Korea
2007 Biennial Enamelist Society International Exhibition, Columbus, Ohio
2007 SOLO exhibition, Brush With Form: The Art of Mary Chuduk Phoenix Sky Harbor Galleries, Phoenix, Arizona
2007 Connected: Basketry Invitational, Cervini Haas Gallery, Scottsdale, Arizona
2007 Contemporary Enameling, Pullen Arts Center, Raleigh, NC
2006 Contemporary American Enamels (invitational), Cape Cod Museum of Art, Massachusetts
2006 19th International Cloisonné Jewelry Contest, Tokyo, Japan
2006 "New Wave" II International Enamel Biennial Chardin Gallery, Republic of Georgia
2006 40th Memorial International Enameling Art Exhibition, Tokyo, Japan
2006 The Art of Enameling, (invitational) Mobilia Gallery, Cambridge, Massachusetts
2005 Refined IV: Innovation, Steven F. Austin State University Gallery, Nacogdoches, Texas
2005 In Hot Water: Teapots by Southwestern Artists, (invitational) Tohono Chul Park Art Center, Tucson, Arizona
2005 Enamelist Society 10th Biennial Exhibition, Arrowmont School, Gatlinburg, Tennessee
2005 6th International Enameling Exhibition "World of Enamel": The Plate, Salou, Spain (also The Goblet in 2003)
2005 SOFA Chicago, Mobilia Gallery
2004 NCEG 7th International Juried Enamel Exhibition, Berkeley, California
2004 Playing With Fire, Gallery 21, San Diego, California
2003 Crafts National 37, Zoller Gallery, Pennsylvania State University
2003 Steeped in Tradition: The Fine Art of Tea, (invitational) Mesa Contemporary Crafts, Arizona
2003 big LITTLE: Jewelers and Sculptors Making It in Metal, Crafts and Cultural Arts Gallery, Oakland, California
2003 On the Edge, Gallery Mack, Seattle, Washington
2002 Craft Forms 2002, Wayne Art Center, Wayne, Pennsylvania
2002 Natural Influences, Pismo Gallery, Denver, Colorado
2002 Color, Light and Illusion, (best of show) Gallery 21, San Diego, California
2001 Color and Light, New Delhi and Mumbai, India
2001 Metal Departures, St. Louis Artist Guild, St. Louis, Missouri
2001 Arizona A-Z, (invitational) Tohona Chul Art Museum, Tucson, Arizona

- 2000 Contemporary Enamels, traveling exhibition through the Arizona Arts Commission (curator)
- 2000 American Enamels, (invitational) Random Modern Gallery, Tacoma, WA
- 2000 Force and Fire: Old Techniques/ New Technologies, Worcester Center for Crafts, Massachusetts
- 1999 17th Korean Enamel Association Exhibition, (invitational), Seoul, Korea
- 1998 Brooch: The Subject, (traveling invitational), sponsored by Arizona Commission of the Arts
- 1998 SOLO Exhibition, Wichita Arts Center, Kansas
- 1996 Forest From the Trees: Contemporary Enamel Masters, (invitational) Aaron Faber Gallery, New York City
- 1996 Recent American Enamels, (curator), Northern Arizona University Galleries, Flagstaff, AZ
- 1996 Glass on Metal: Contemporary Enamels, (curator), Tempe Arts Center and Sculpture Garden, Tempe, Arizona
- 1995 North America Enamels East, Torpedo Factory, Alexandria, Virginia
- 1995 L' Ouverture, (invitational), Art Walk Gallery, Ascona, Switzerland
- 1994 Creativ Kreis International, (invitational), St. Petersburg, Peterhof, Jaroslawl, Russia

TEACHING

Private studio instructor and **workshops in US** including:

- Arrowmont School of Arts and Crafts, Gatlinburg, Tennessee
- Penland School of Crafts, Penland, North Carolina
- John C. Campbell Folk School, Brasstown, North Carolina
- 92nd St. Y, New York City, New York
- Wichita Art Center, Wichita, Kansas
- Fuller Art Center, Brockton, Massachusetts
- San Diego State University, San Diego, California
- Palomar College, San Marcos, California
- Creative Arts Center, Sierra Madre, California
- Newark Art Museum, Newark, New Jersey
- Glassell School of Art, Houston, Texas
- Mendocino Arts Center, California 2001
- Kent State University 2001

International:

- 1999 International Enamelist Society Conference, Ontario, Canada
- 2003 Curtin College, Perth, Australia, sponsored by Enamelists of WA
- 2004 Hiroshima, Japan, sponsored by Toshiko Tanaka
- 2004 Sapporo Art Center, Sapporo, Hokkaido, Japan
- 2004 Mexico City, Mexico, sponsored by the Mexican Enamelist Society
- 2006 Gallery Chardin, Tbilisi, Georgia
- 2006 Cam Ocagi (Glass Furnace), Istanbul, Turkey
- 2007 Kookmin University, Seoul, Korea
- 2008 Cam Ocagi, (Glass Furnace), Istanbul, Turkey

PUBLIC COLLECTIONS

- Mesa Contemporary Arts, Arizona
- Wichita Art Center, Kansas
- Cam Ocagi (The Glass Furnace), Istanbul, Turkey
- The Enamel Arts Foundation, Los Angeles
- *Also numerous private collections*

PRINT:

- Author- Enamel: Technique and Experiments (Smiling Greyhound Press)
- The Art of Fine Enameling (K. Cohen, Sterling Publishing)
- The Art of Enameling (L. Darty, Lark Books)
- 500 Baskets (Lark Books)
- Teapots: Makers and Collectors (D.Meilach, Schiffer Publishing)
- Glass on Metal and Metalsmith magazines (US)
- Australian Enamel News, 2004
- Art Modern magazine (Istanbul, Turkey) 2008
- Art Jewelry magazine, fall, 2009
- Numerous newspaper and newsletter articles

MEMBERSHIP

- International Enamelist Society
- Society of North American Goldsmiths
- Arizona Designer Craftsmen

Other:

- Past Member - Board of Directors: Arizona Designer Craftsmen,
- Phoenix Visual Arts Center & International Enamelist Society (Past board member for both)
- Thrice recipient Arizona Arts Commission Professional Development Grant



Tea Strainer Sugar and Creamer
Copper, enamel
Creamer: 5"h x 6"w x 4"d



Tea Strainer Teapot
Copper, enamel
12"h x 8"w x 6"d

2003

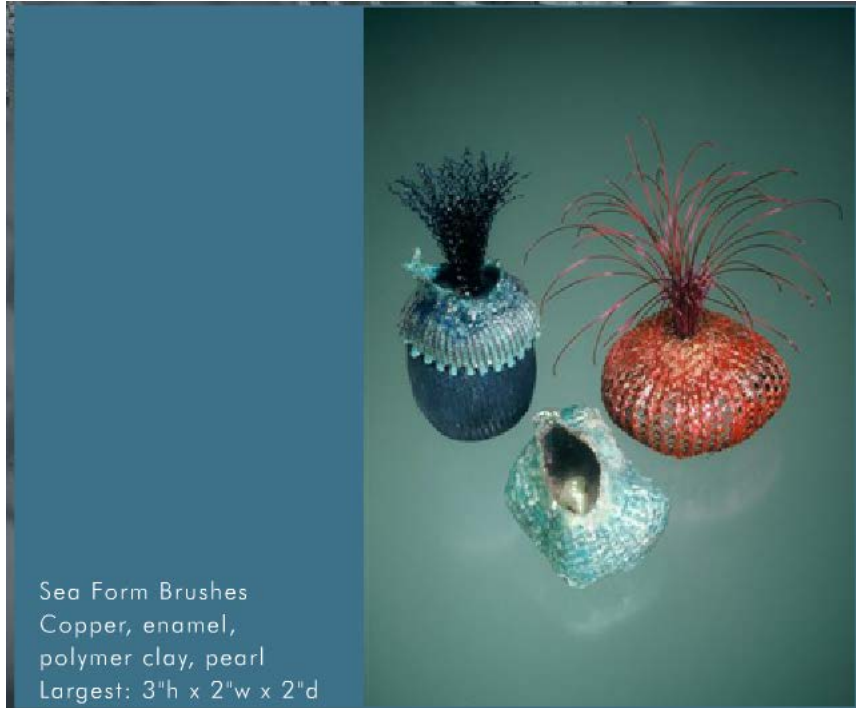

Sea Form Brushes
Copper, enamel,
polymer clay, pearl
Largest: 3"h x 2"w x 2"d



Collected Brushes
Copper, enamel, brass,
wood, synthetic hair
17"h x 12"w x 4"d



Marilyn
Copper, enamel
8"h x 8"w x 1"d

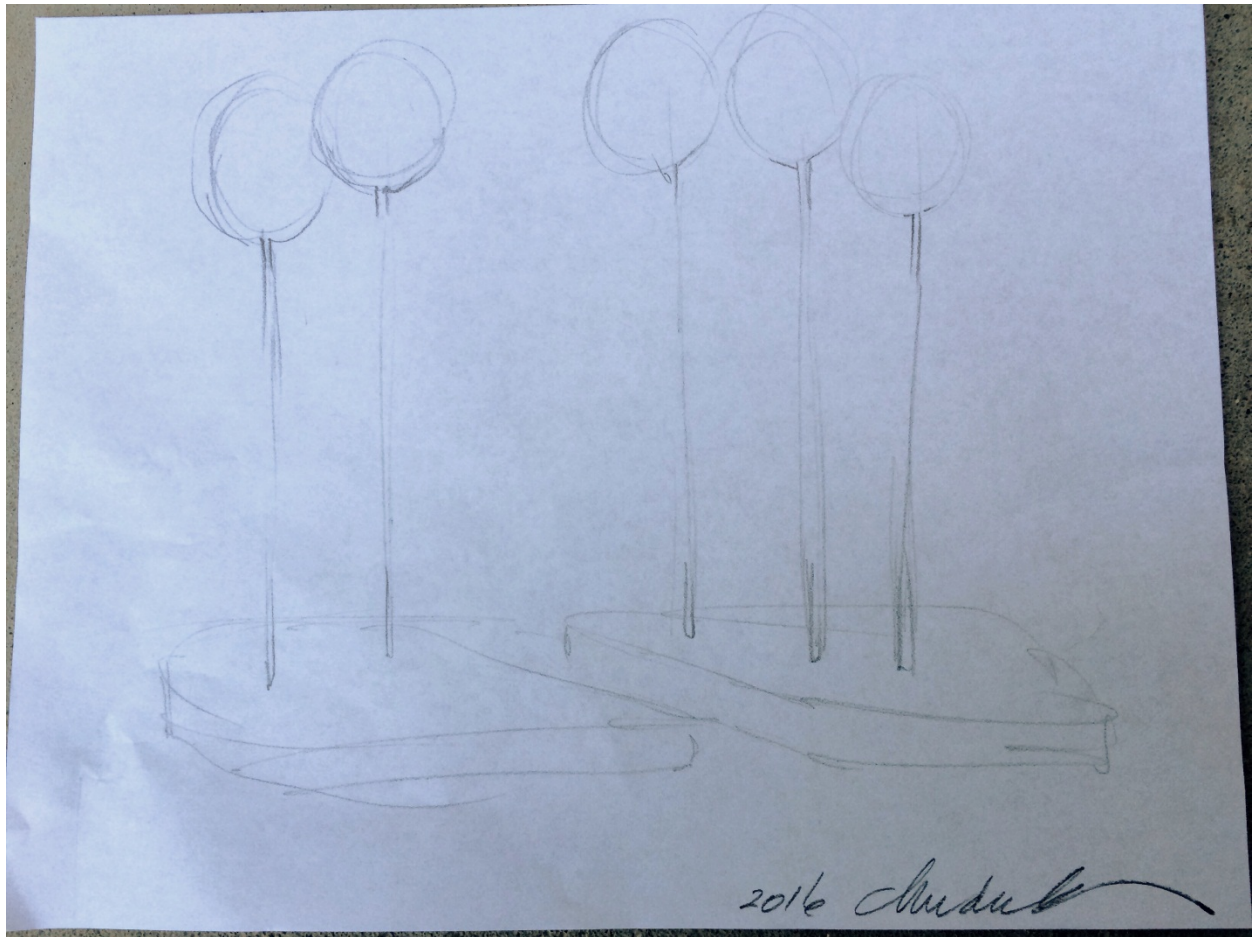

2016 *Ardu*