

- Project Elements**
- Bike Lanes (both directions of travel, including possible buffer treatment)
 - Median Islands, with left turn access
 - 8' Wall / Buffer Element (detailed design to be developed, including landscaping) on north side of Broadway Road
 - 8' Sidewalks with street trees on south side of Broadway Road
 - 1 Eastbound lane of travel removed

Sierra Vista Drive

Specialized Crosswalk Treatment

Legend

| | | | |
|--|----------------------------------|--|-------------------------------------|
| | 3' Wall | | Driveable Continuous Left Turn Lane |
| | 8' Wall | | Bus Stop |
| | 10' Landscaped Raised Median | | Landscaped Plaza |
| | Proposed Sidewalks and Driveways | | Bike Lane |
| | Right-of-Way | | |

NTS

Broadway Road

Section 4

10.11.13



Broadway Road

Section 5

10.11.13

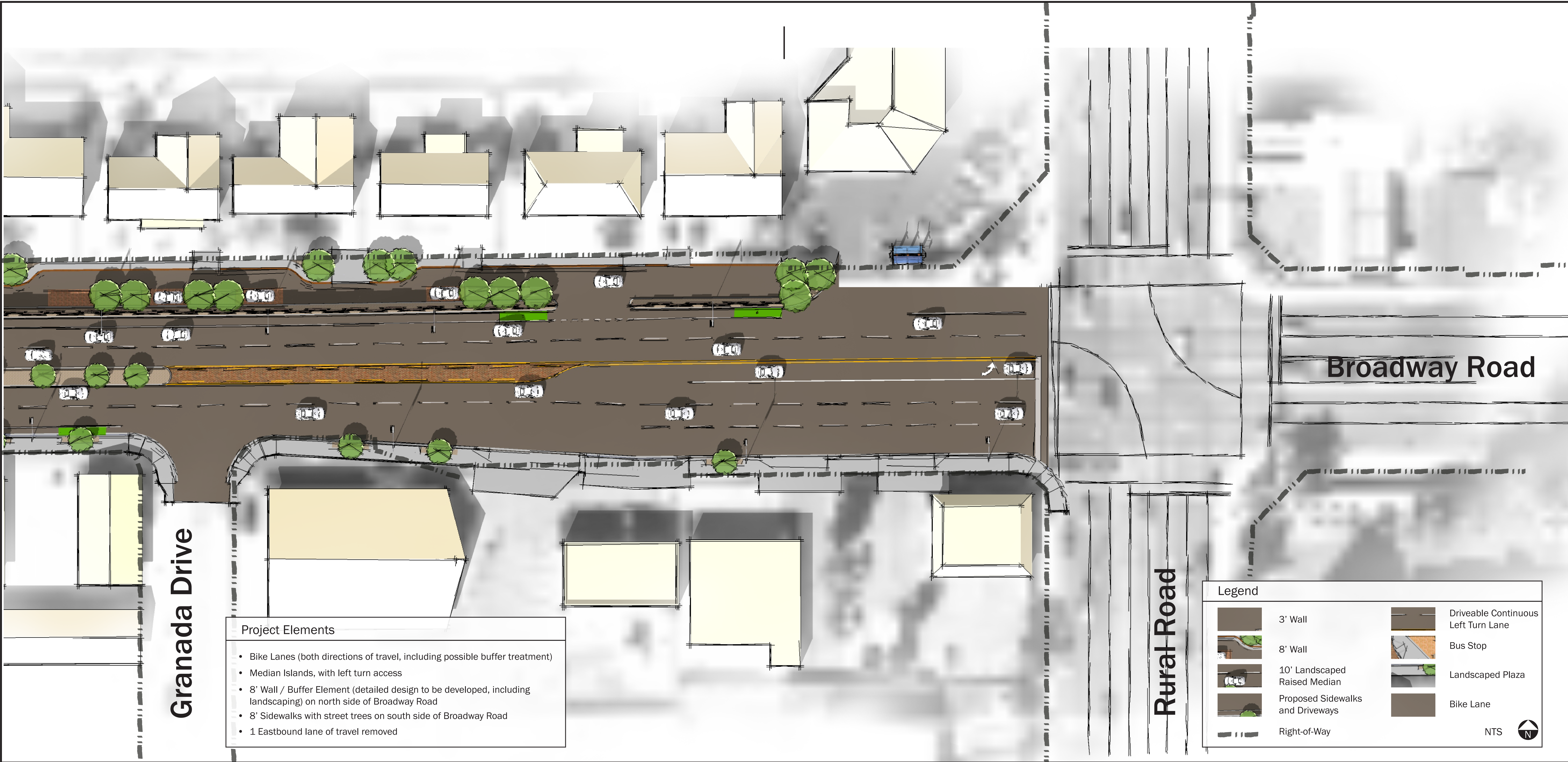

- Project Elements**
- Bike Lanes (both directions of travel, including possible buffer treatment)
 - Median Islands, with left turn access
 - 8' Wall / Buffer Element (detailed design to be developed, including landscaping) on north side of Broadway Road
 - 8' Sidewalks with street trees on south side of Broadway Road
 - 1 Eastbound lane of travel removed

| Legend | | | |
|--------|----------------------------------|--|-------------------------------------|
| | 3' Wall | | Driveable Continuous Left Turn Lane |
| | 8' Wall | | Bus Stop |
| | 10' Landscaped Raised Median | | Landscaped Plaza |
| | Proposed Sidewalks and Driveways | | Bike Lane |
| | Right-of-Way | | |

NTS

Broadway Road

Section 6
10.11.13