

**Welcome! The College and University Grade Separated Crossing public meeting will begin shortly.**

While you wait, we invite you to complete a voluntary self-identification survey at [tempe.gov/NeighborhoodSurveys](http://tempe.gov/NeighborhoodSurveys) to help Tempe understand who attends its public meetings and how the city can improve participation.





## **NONDISCRIMINATION NOTICE TO THE PUBLIC**

The City of Tempe, under Title VI of the Civil Rights Act of 1964 and related statutes, must ensure that no person in the City of Tempe shall, on the grounds of race, color, national origin, sex, disability and age, be excluded from participation in, be denied the benefits of, or be subjected to discrimination under any federally funded program or activity it administers. Additional protections are provided by Tempe City Code, Chapter 2, Article VIII – Anti Discrimination Ordinance.

Any person who believes that they have been aggrieved by an unlawful discriminatory practice may file a complaint with Eddie Gutierrez Title VI Coordinator for the City of Tempe at 480-350-8670 or [Eduardo\\_Gutierrez@tempe.gov](mailto:Eduardo_Gutierrez@tempe.gov)





# College & University Grade Separated Crossing

---

Public Meeting Round 1 – October 22, 2024







## Project History

- Started in 2019 as part of an ASU commissioned study of grade separating three high pedestrian volume intersections.
- In 2022, the City applied for and were awarded federal grants to complete this project's final design and construction
- Project's design kicked-off in May 2024, with utility research, data collection, and stakeholder's meetings with the immediately adjacent property owners.

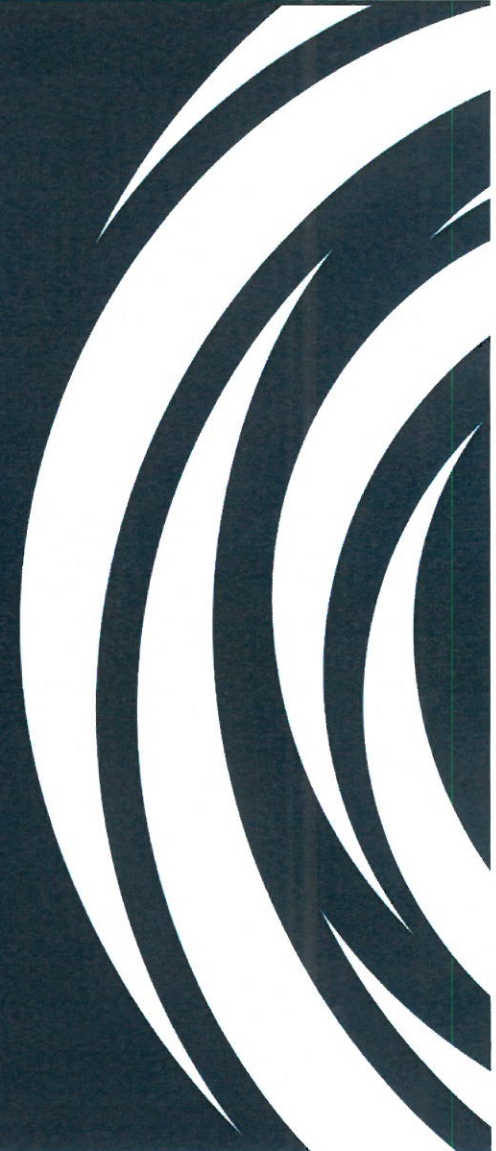





# Stakeholder Feedback Themes

## Newman Center:

- Maintain clear access to alley, College Ave entrance, College Ave staircase, HVAC equipment.
- Protect in place architectural features and elements of the church, with special consideration to construction impacts such as vibrations.
- Maintain visibility of Mary College and Newman Community Center

## ASU:

- Protect in place and maintain clear visibility of landmark signage
- Ensure proposed bridge landings and/or underpass ramps are placed west of Cady Mall and Alumni Lawn
- Provide access for golf carts to circulate around improvements





## PROJECT GOALS

- CREATE A SAFE PEDESTRIAN/BICYCLE CROSSING
- IMPROVE VEHICULAR TRAFFIC FLOW
- ENHANCE CONNECTIVITY TO CHURCH
- POSITIVELY ENGAGE EXISTING LANDMARKS
- CREATE AN ENGAGING EXPERIENCE
- CREATE WAYFINDING/SAFETY THROUGH VISUAL CONNECTION
- CREATE POTENTIAL LANDMARK FOR TEMPE/ASU

S. COLLEGE AVE.

E. UNIVERSITY DR.





# CAMPUS / DOWNTOWN CIRCULATION

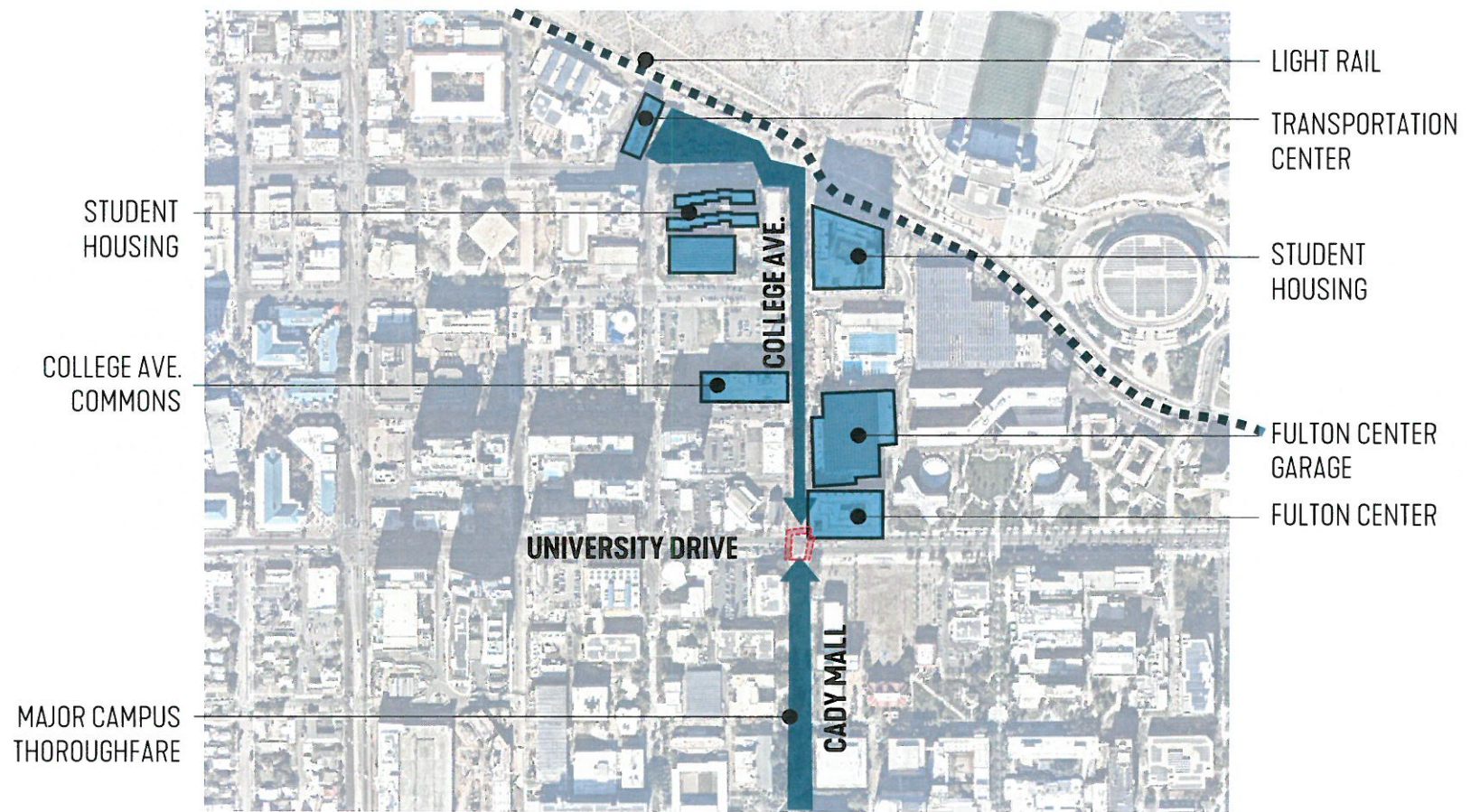

**Bowman**

**SMITHGROUP**

  
**Jacobs**



# SITE CONTEXT

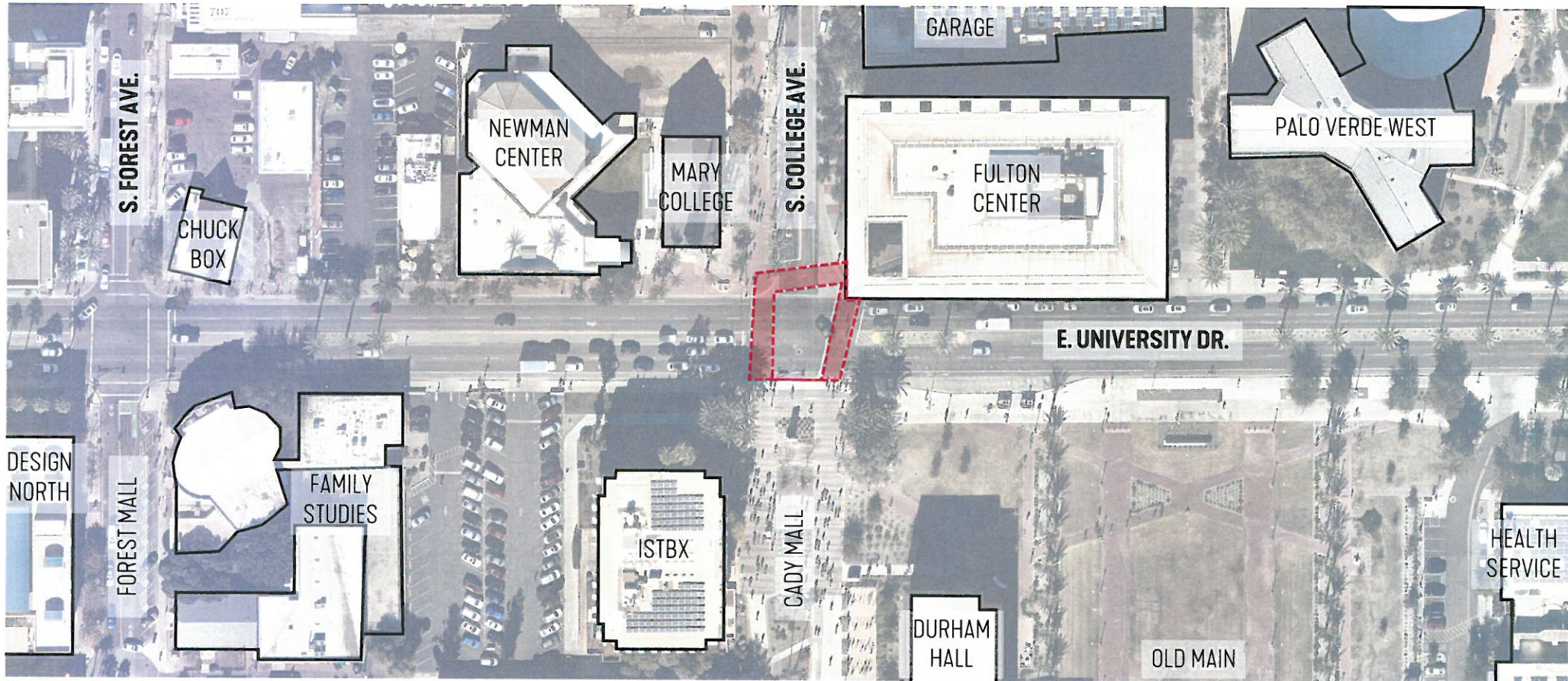

**Bowman**

**SMITHGROUP**

  
**Jacobs**



# SITE PHOTOS

MARY COLLEGE AT ASU

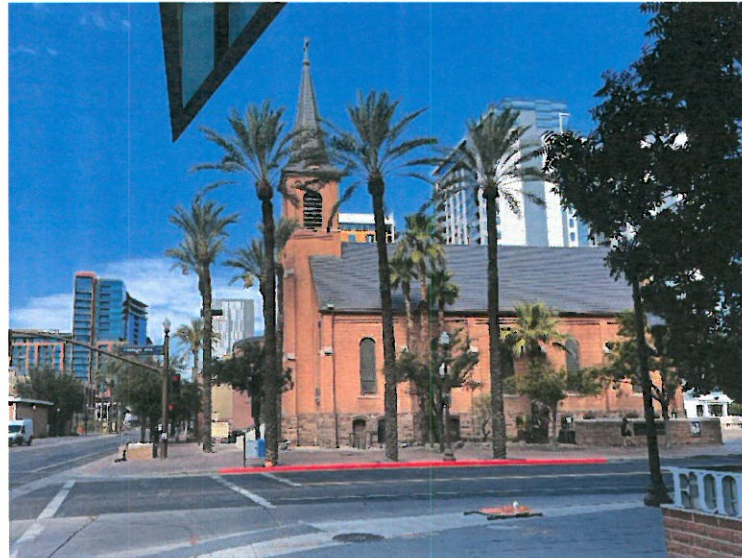
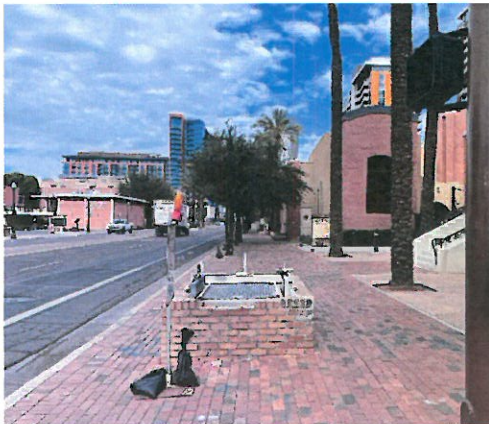
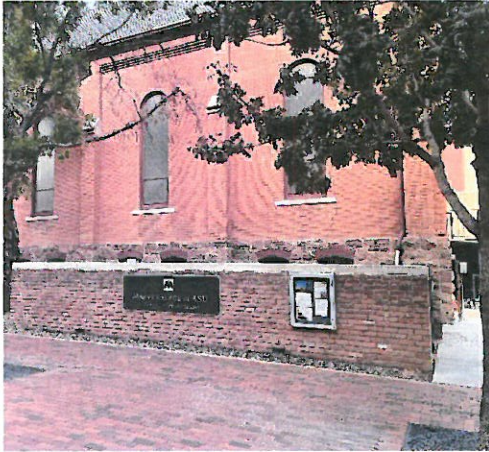

**Bowman**

**SMITHGROUP**

**Jacobs**



# SITE PHOTOS

## FULTON CENTER



**Bowman**



**SMITHGROUP**



**Jacobs**



# SITE PHOTOS

## CADY MALL



**Bowman**

**SMITHGROUP**

**Jacobs**



# UTILITIES

## ALL KNOWN UTILITIES

1. AT&T - Coax and Fiber
2. APS Electric
3. Arizona State University
4. City of Tempe - Sewer, Traffic Signals, Water
5. City of Tempe Cable - CATV, Coaxial, Fiber Optics
6. Crown Castle Solutions - Fiber Optics
7. CenturyLink - Coaxial, Fiber Optics
8. Cox Communications
9. MCI (Verizon Business) - Fiber Optics
10. SRP - Communications, Electric, Fiber Optics, Irrigation
11. Southwest Gas - Gas & High Pressure Gas
12. Zayo Group - Communication, Fiber Optics

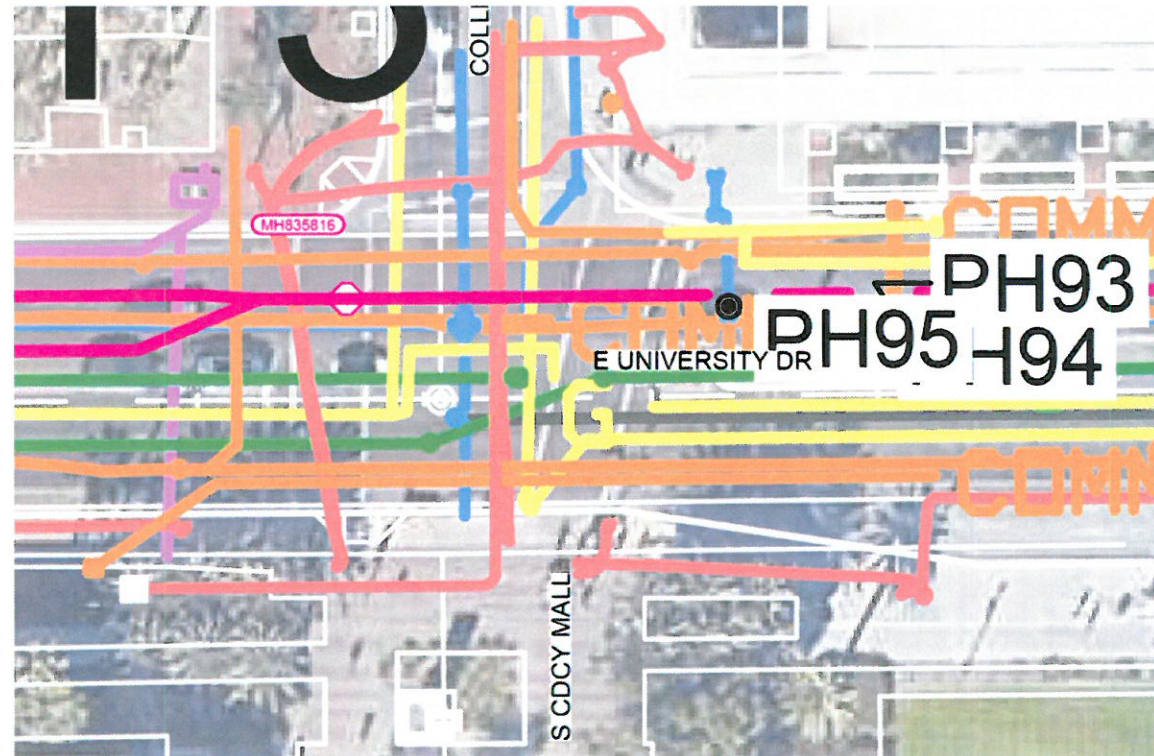

**Bowman**

**SMITHGROUP**

**Jacobs**





# Pedestrian Bridge Examples







# Pedestrian Bridge Examples







# Pedestrian Underpass Examples

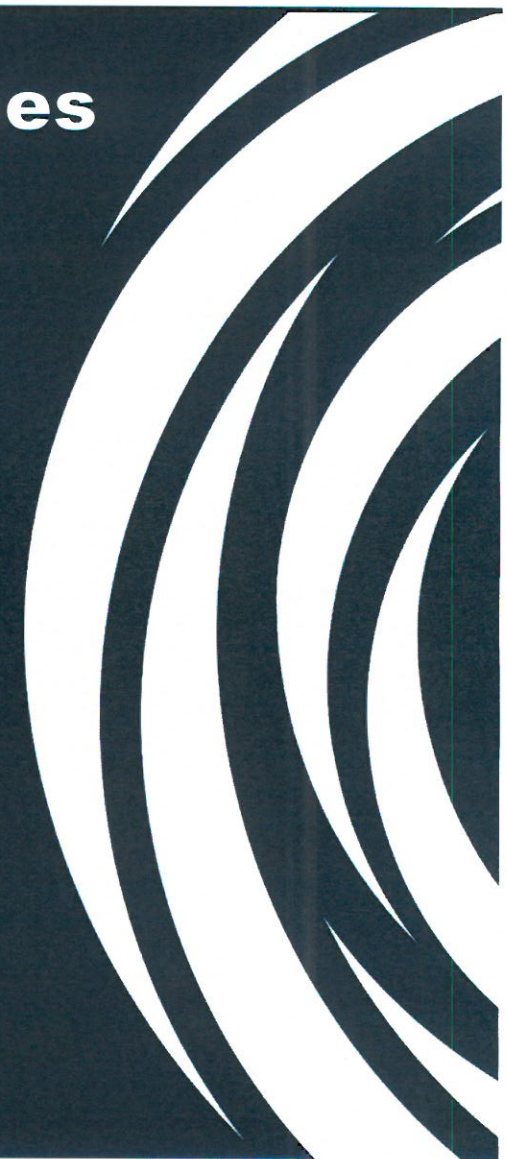





# Pedestrian Underpass Examples







# Pedestrian Underpass Examples







***Option 1 | Bridge***





# 1 | BRIDGE

SITE PLAN

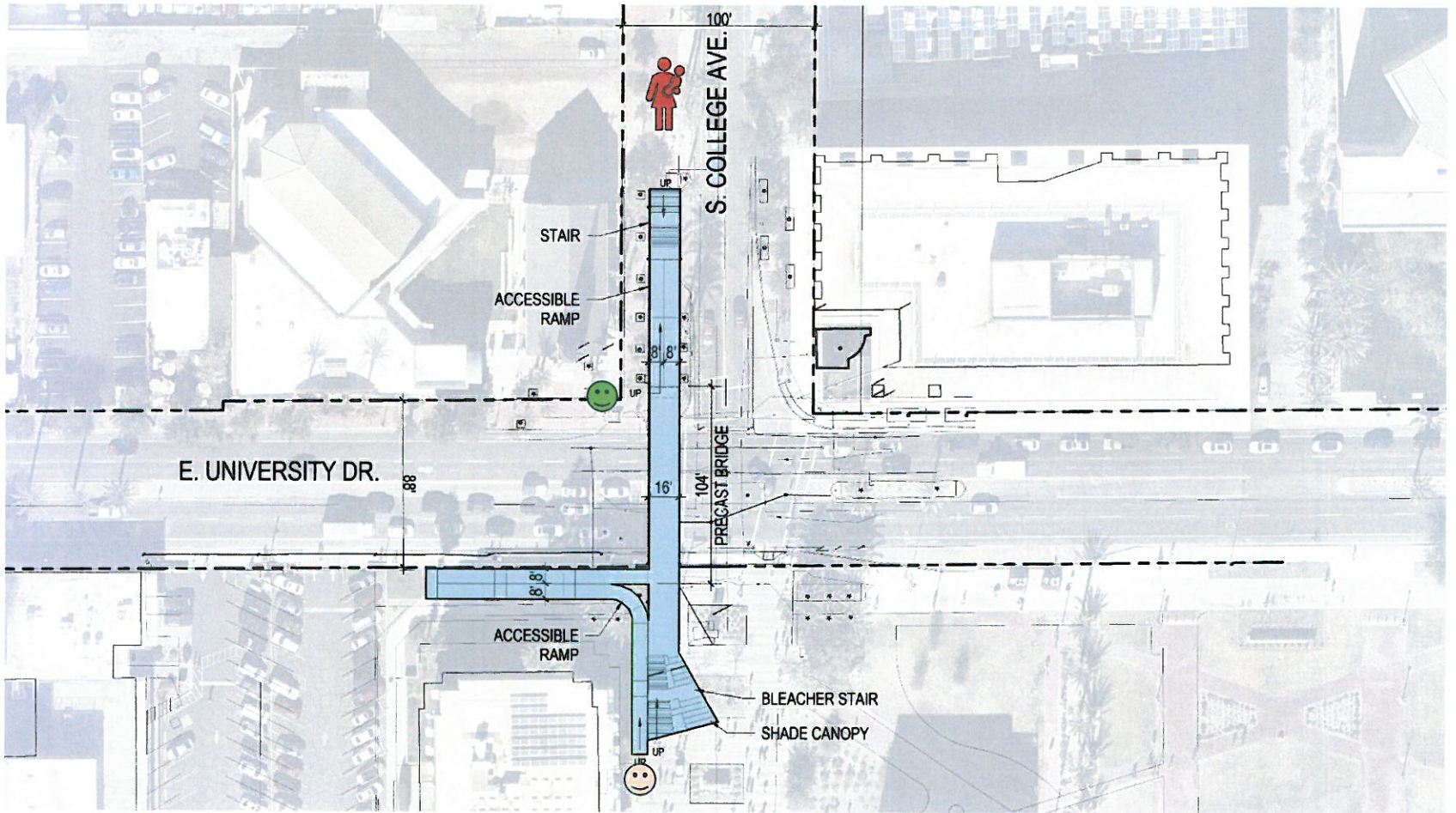

**Bowman**

**SMITHGROUP**

**Jacobs**



# 1 | BRIDGE

SOUTH AERIAL





# 1 | BRIDGE

EAST FROM UNIVERSITY





**1 | BRIDGE**  
NORTH END FROM EAST







***Option 2A and 2B Directional  
Underpass***





# 2A | SINGLE TUNNEL – COLLEGE WEST

SITE PLAN

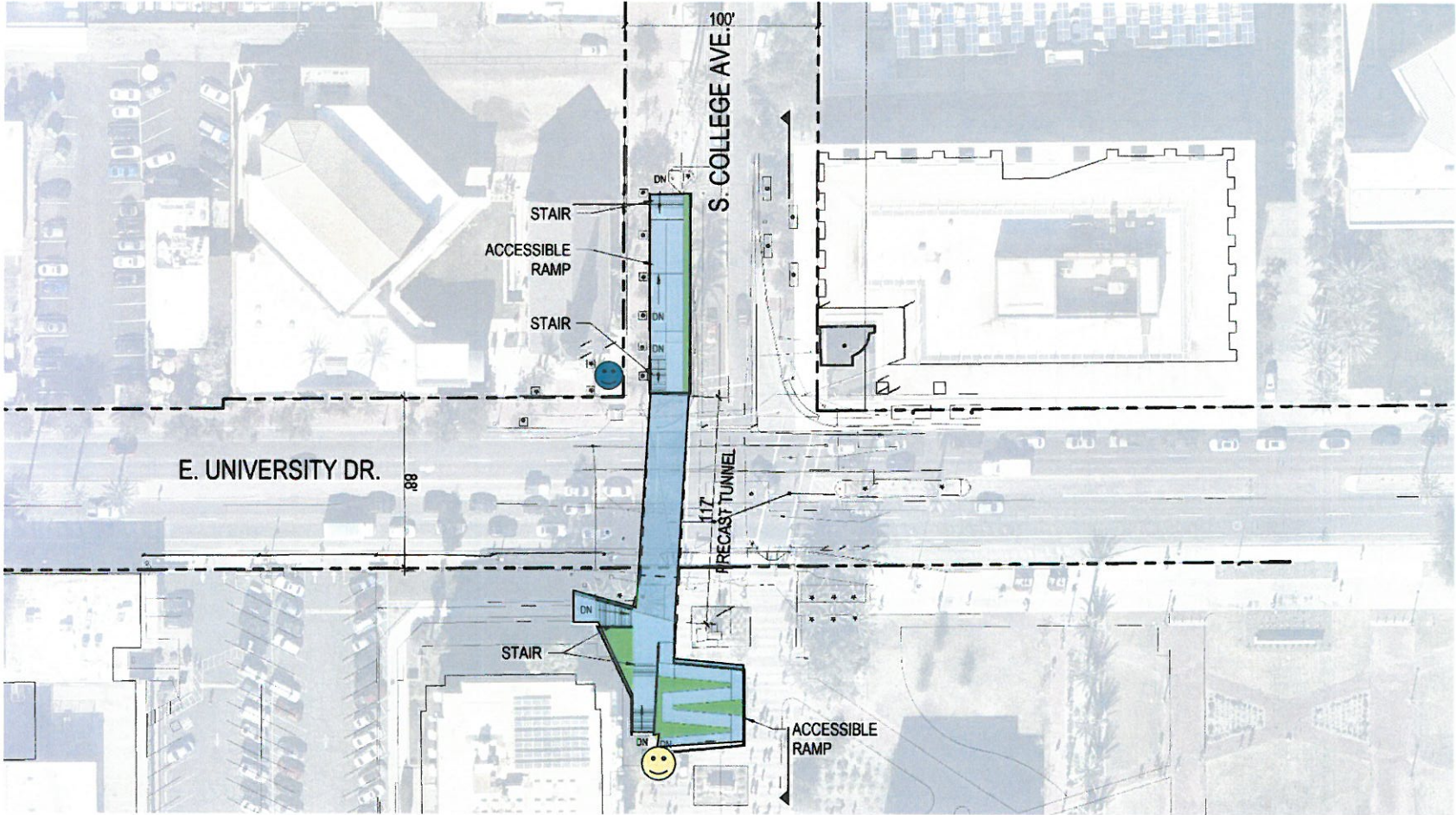

**Bowman**

**SMITHGROUP**

**Jacobs**



# 2A | WEST TUNNEL

AERIAL





# 2A | WEST TUNNEL

AERIAL





# 2A | WEST TUNNEL

## NORTH RAMP





# 2B | SINGLE TUNNEL – COLLEGE EAST

SITE PLAN

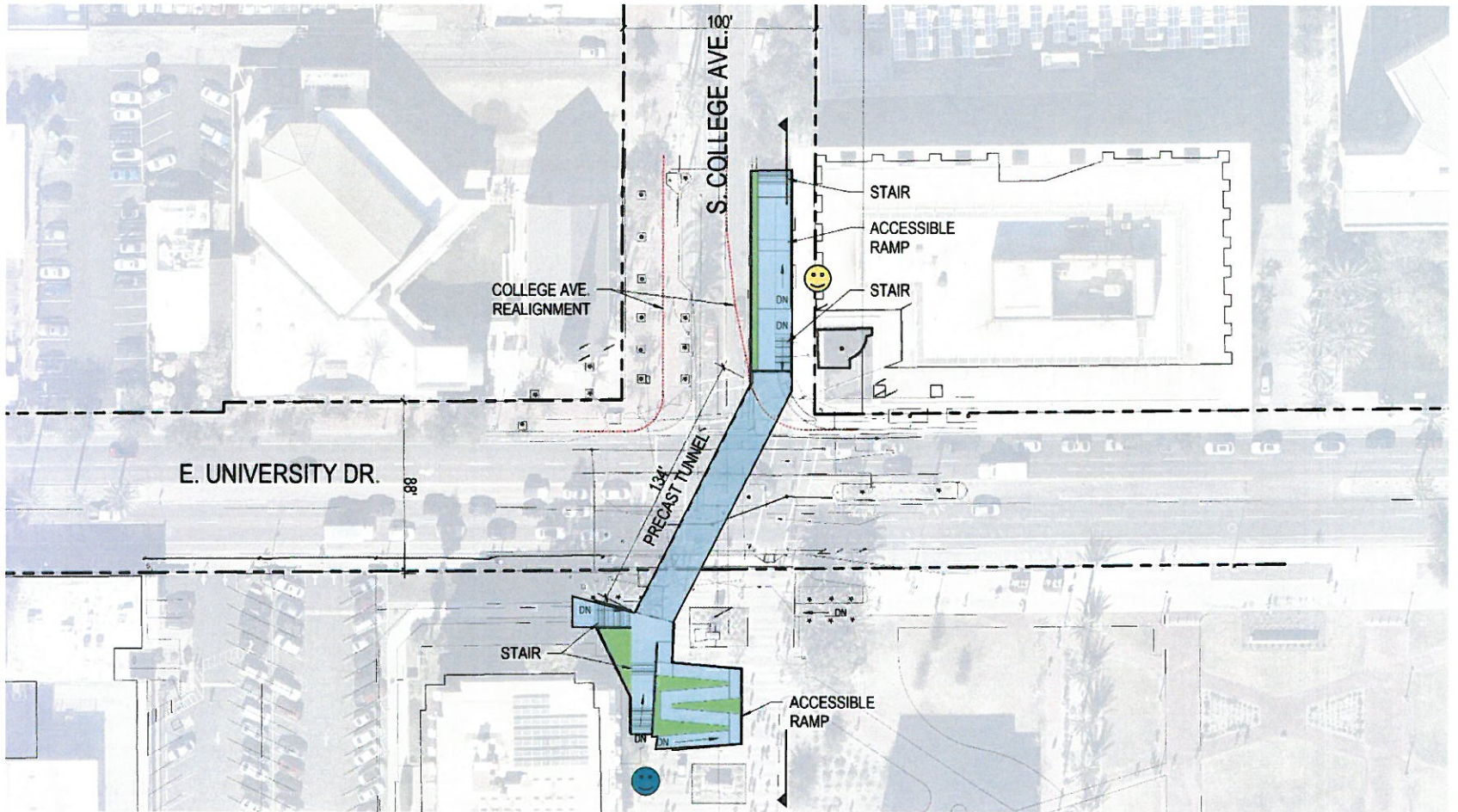

**Bowman**

**SMITHGROUP**

**Jacobs**



# 2B | EAST TUNNEL

AERIAL

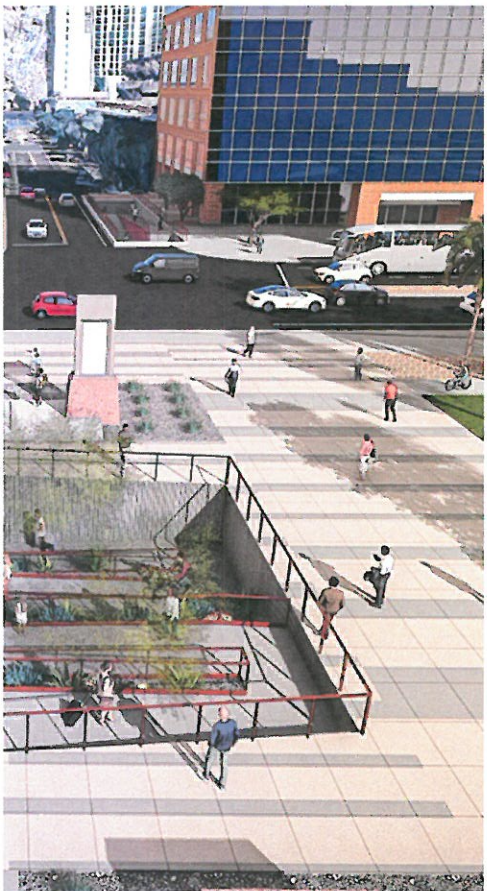

**Bowman**



**SMITHGROUP**

**Jacobs**





## *Option 3 – Y Tunnel*

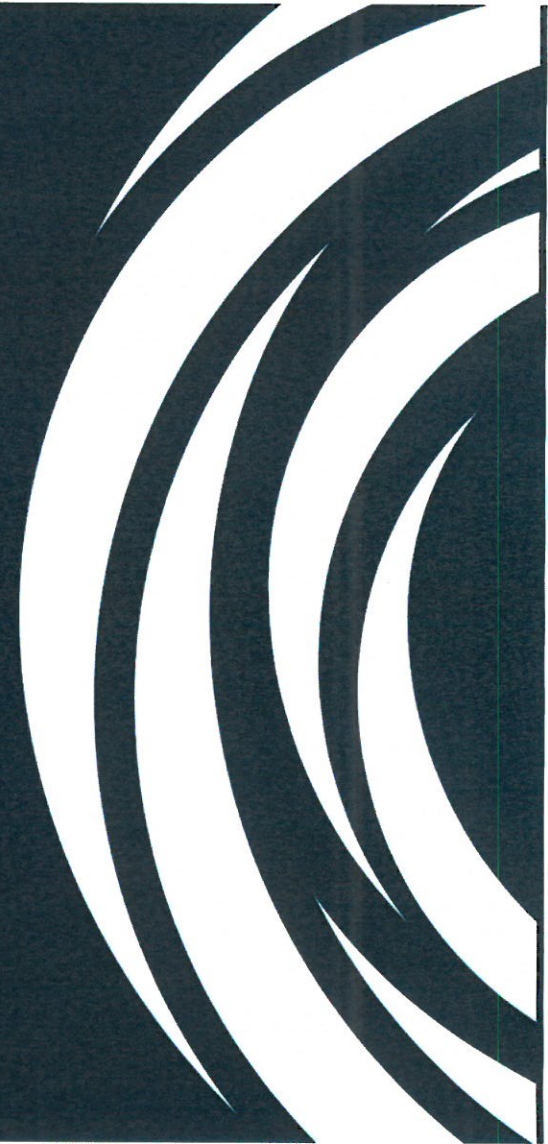



# 3 | 'Y' TUNNEL

SITE PLAN

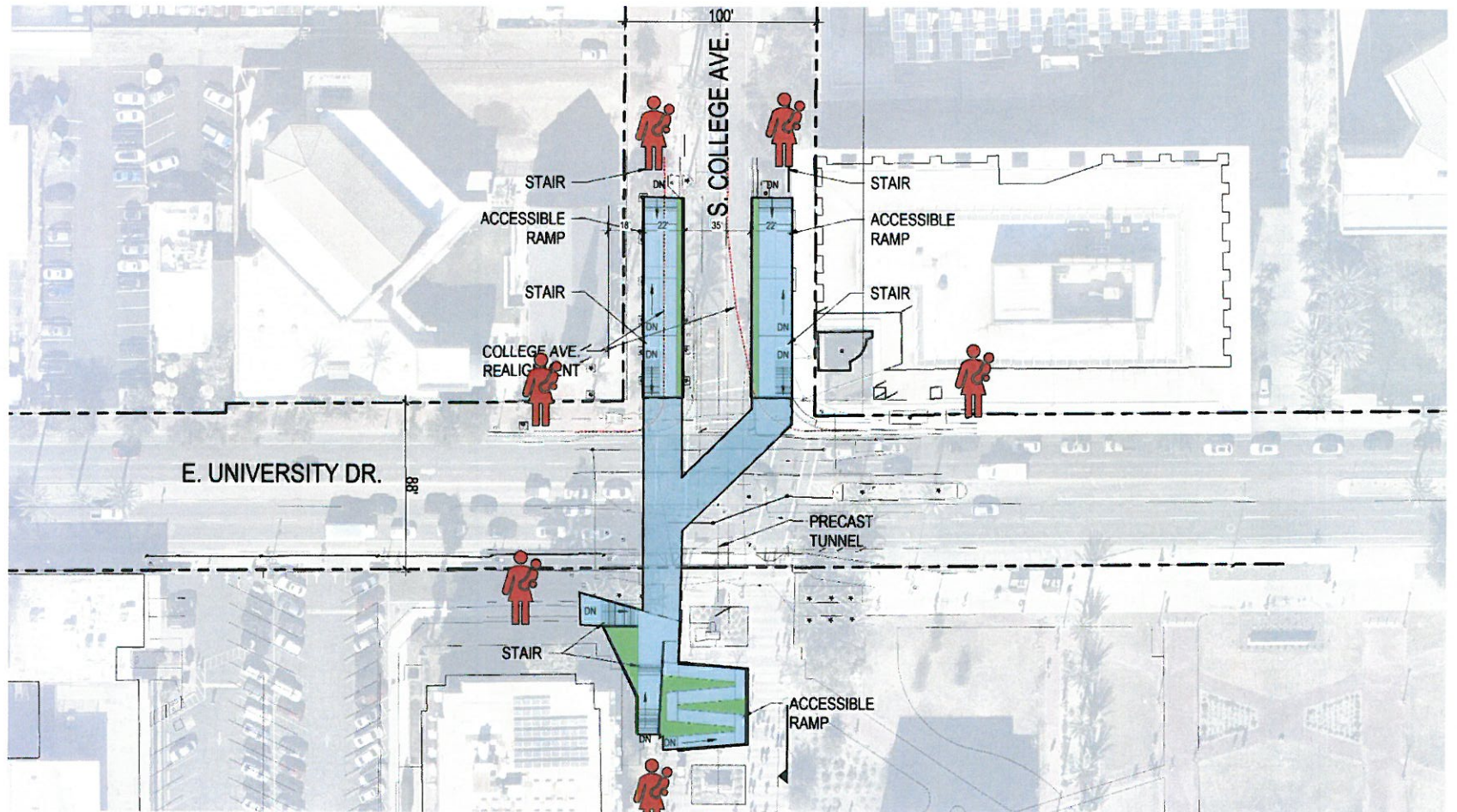

**Bowman**

**SMITHGROUP**

**Jacobs**



# 3 | 'Y' TUNNEL

AERIAL





# 3 | 'Y' TUNNEL

AERIAL





# 3 | 'Y' TUNNEL

NORTH AERIAL





# LIGHTING OPTIONS

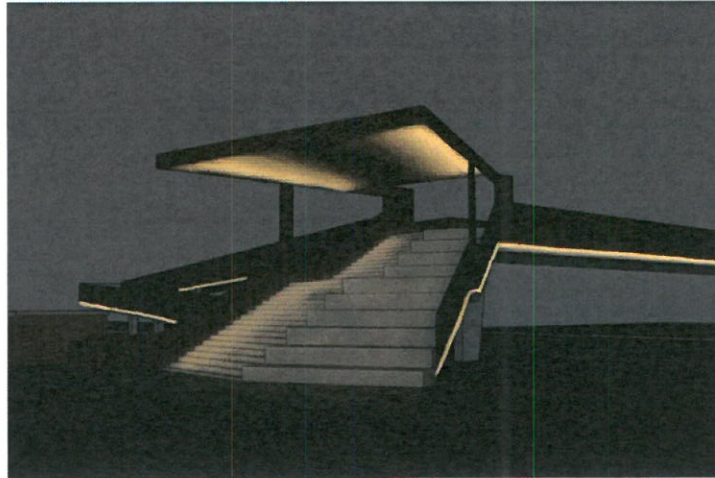
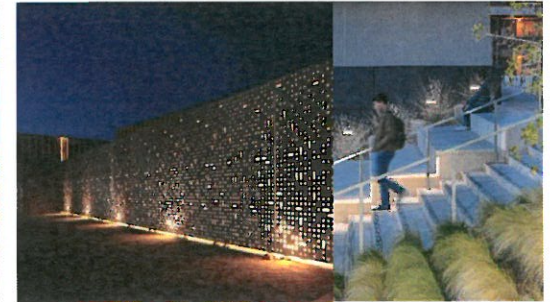
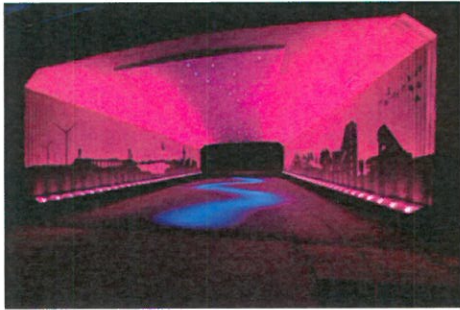

**Bowman**

**SMITHGROUP**

**Jacobs**



# LANDSCAPE CHARACTER

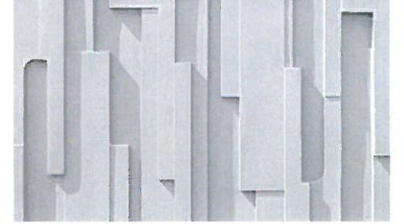

**Bowman**

**SMITHGROUP**

**Jacobs**





## Outreach

- Commission on Disability Concerns – **September 9**
  - Transportation Commission – **September 10**
  - Historic Preservation Commission – **September 11**
  - Public Meeting Round 1 – **October 22**
  - City Council – **November 2024**
- 
- Additional outreach to occur at draft 30% and draft 60% anticipated to occur early-2025 through mid-2025
  - Design anticipated to be complete late 2025, with construction mid-2026.





**Thank You!**  
**Questions?**

**Chase Walman**  
**[Chase\\_Walman@tempe.gov](mailto:Chase_Walman@tempe.gov)**

**Survey and Project Materials:**  
**[www.tempe.gov/CollegeUniversityCrossing](http://www.tempe.gov/CollegeUniversityCrossing)**