

LEGEND

-  NEW TREE
-  EXISTING TREE
-  TREE PREVIOUSLY CALLED OUT FOR REMOVAL NOW PROTECTED IN PLACE
-  EXISTING TREE TO BE REMOVED
-  PROPOSED NEW TREES THAT CAN BE RELOCATED WHERE FEASIBLE
-  10' WIDE Path Realignment
-  10' WIDE Path Per Plans
-  Path Light Fixture Per Plan
-  Path Light Fixture Location Adjusted

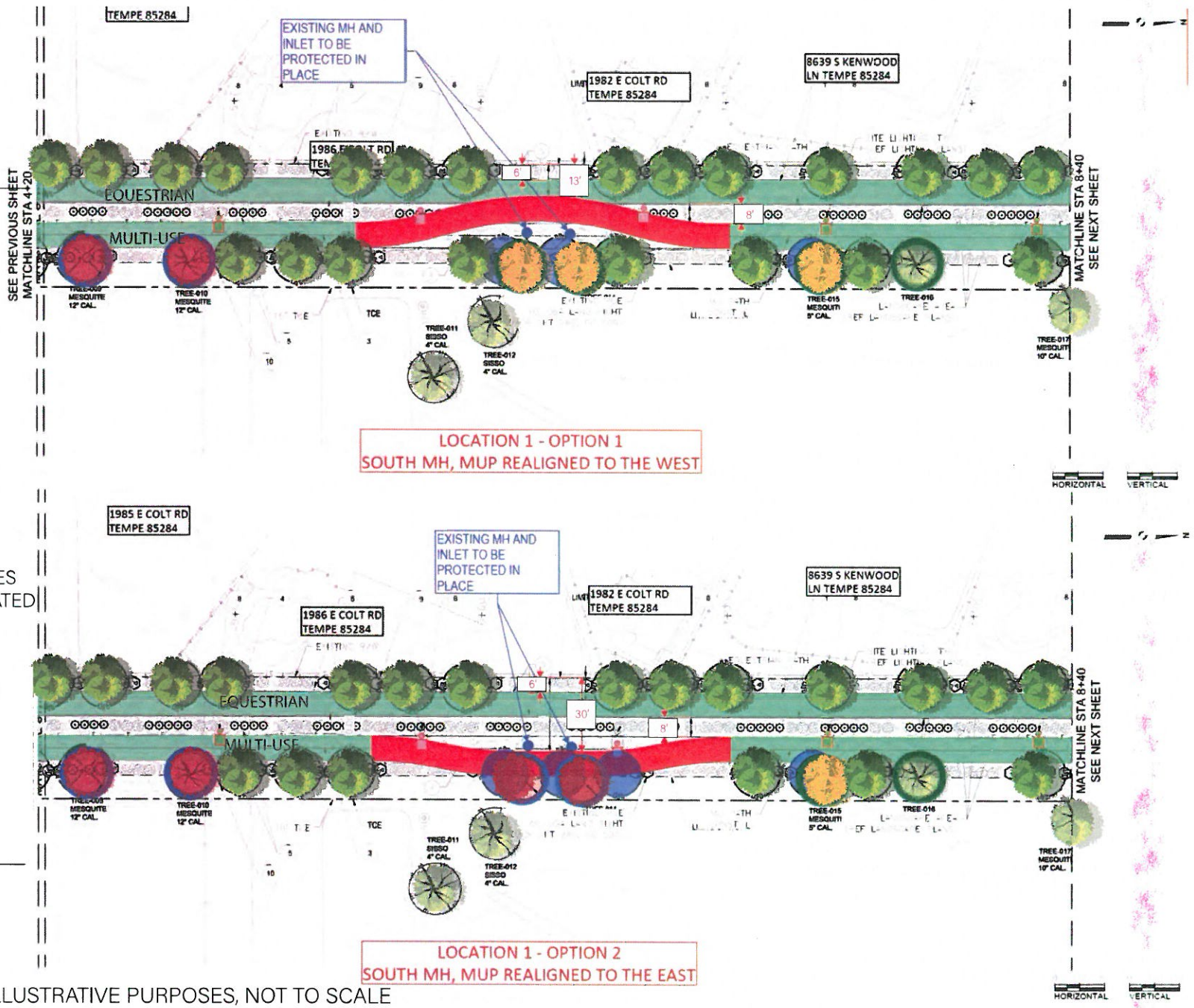

GRAPHIC SYMBOLY FOR ILLUSTRATIVE PURPOSES, NOT TO SCALE

LEGEND

-  NEW TREE
-  EXISTING TREE
-  TREE PREVIOUSLY CALLED OUT FOR REMOVAL NOW PROTECTED IN PLACE
-  EXISTING TREE TO BE REMOVED
-  PROPOSED NEW TREES THAT CAN BE RELOCATED WHERE FEASIBLE
-  10' WIDE Path Realignment
-  10' WIDE Path Per Plans
-  Path Light Fixture Per Plan
-  Path Light Fixture Location Adjusted

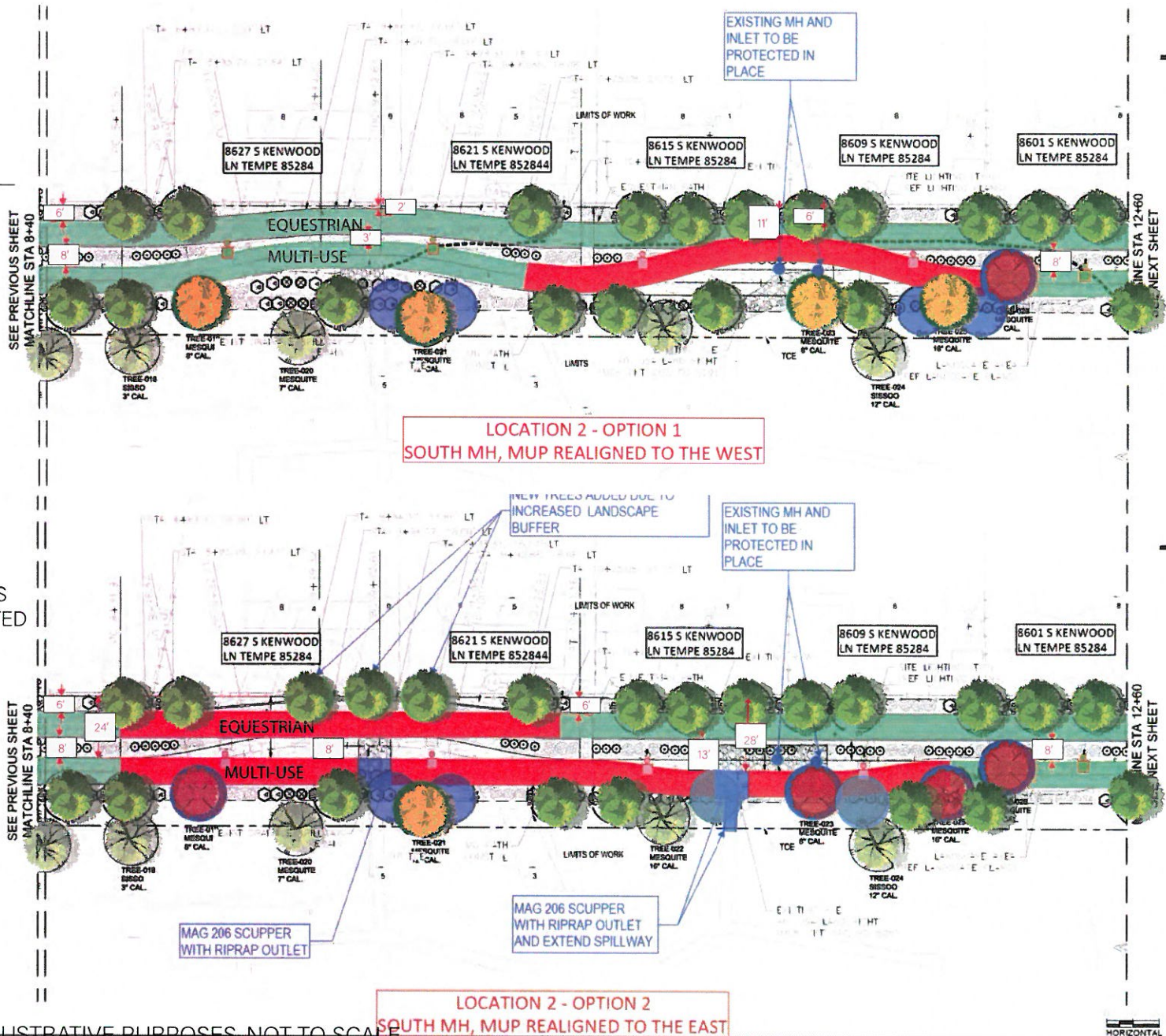

LOCATION 2 - OPTION 1
SOUTH MH, MUP REALIGNED TO THE WEST

LOCATION 2 - OPTION 2
SOUTH MH, MUP REALIGNED TO THE EAST

GRAPHIC SYMBOLY FOR ILLUSTRATIVE PURPOSES, NOT TO SCALE



LEGEND

-  NEW TREE
-  EXISTING TREE
-  TREE PREVIOUSLY CALLED OUT FOR REMOVAL NOW PROTECTED IN PLACE
-  EXISTING TREE TO BE REMOVED
-  PROPOSED NEW TREES THAT CAN BE RELOCATED WHERE FEASIBLE
-  10' WIDE Path Realignment
-  10' WIDE Path Per Plans
-  Path Light Fixture Per Plan
-  Path Light Fixture Location Adjusted

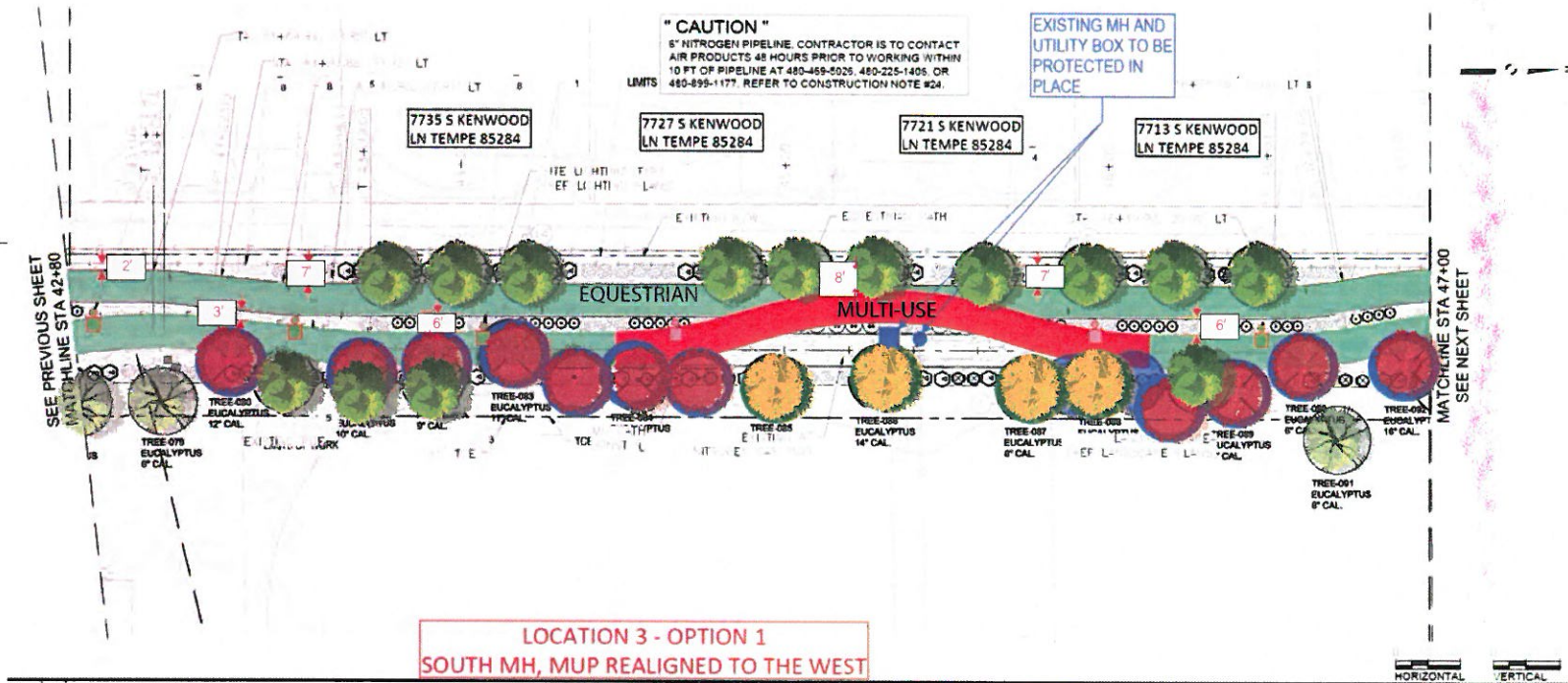

LOCATION 3 - OPTION 1
SOUTH MH, MUP REALIGNED TO THE WEST

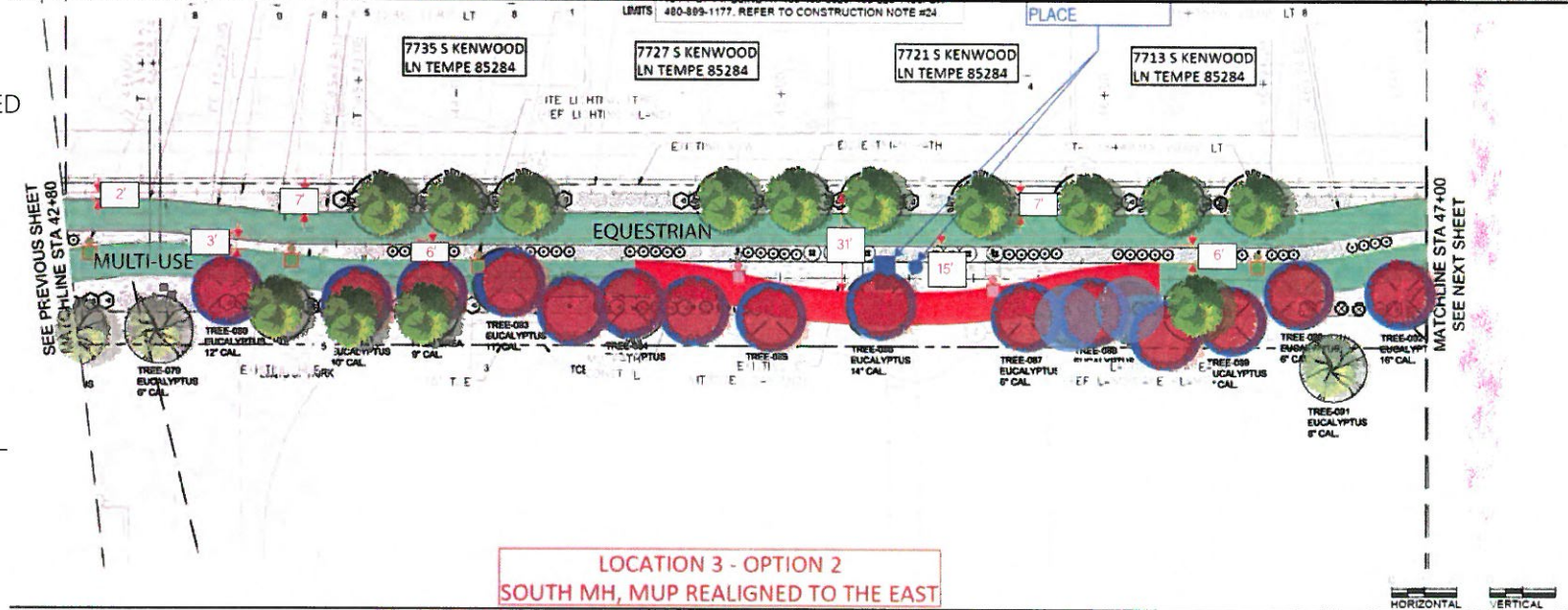

LOCATION 3 - OPTION 2
SOUTH MH, MUP REALIGNED TO THE EAST

GRAPHIC SYMBOLY FOR ILLUSTRATIVE PURPOSES, NOT TO SCALE



Country Club Way Bike & Ped Improvements: Survey Summary, February 2024

Survey Results:

Location 1:

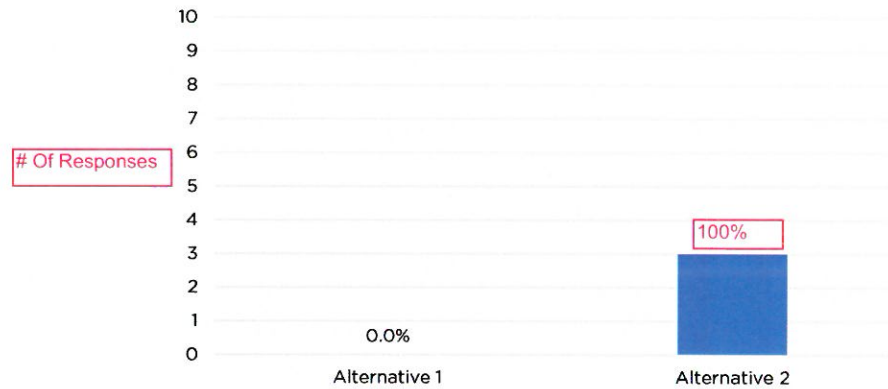

Responses: 3

Comments:

1. It's further from my property wall.
2. For my house, no real change. Having light away from wall helps in option 2. Appreciate you guys addressing our concerns.
3. We prefer any noise and water drainage to be kept away from our existing wall and property line. I'd like to thank Chase for making the effort to meet with me and to talk about the project.

Location 2:

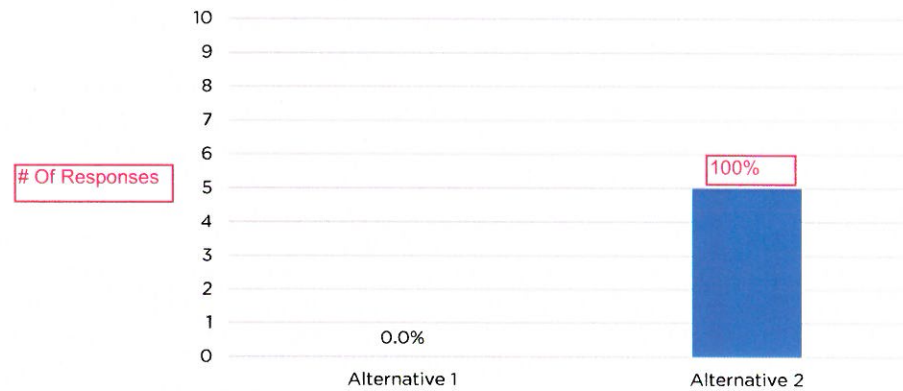

Responses: 5

Comments:

1. Concrete path not as close to pool deck & backyards.
2. Option 2: tree type species that recommendation don't shed into the yards. Joshua Trees? Stake trees - multiple times. Please consult property owner before placing trees. Recommend good irrigation to plants. Bigger trees.
3. Privacy. Noise. My fence is low. Low shedding trees. Small as possible.
4. Shared use path not as close to backyards.
5. Want more privacy for my backyard